

ORDINANCE 1197 (I)

AN ORDINANCE AMENDING AND REENACTING SECTION II OF TOWN OF JACKSON ORDINANCE NO. 1074 AS AMENDED (PART), THE TOWN OF JACKSON LAND DEVELOPMENT REGULATIONS, AND OFFICIAL ZONING DISTRICT MAP OF THE TOWN OF JACKSON TO RE-NUMBER SECTIONS 2.2.2, 2.2.3, 2.2.4 and 2.2.5, TO ADD SECTIONS 2.2.2 THROUGH 2.2.9 AND 2.2.13, TO DELETE SECTIONS 2.3.4, 2.3.5, 2.3.6, 2.3.9, 2.3.11, 2.3.12, 2.3.14, 2.3.15, AND 2.3.16, TO AMEND SECTIONS 2.1.1, 2.1.2, 2.2.1.D.5, 4.4.1.G, 5.2.1.D, 5.3.1.B.2, 5.3.1.B.5, 5.3.2.D.3, 5.4.1.B, 5.5.3.C.1, 5.5.3.D, 5.5.4.C, 5.6.1.E.7.a, 5.8.1.A, 6.1.1.F, 6.4.3.A, 7.1.1, 7.2.1, 7.8.4.B.1, 8.2.2.B.1.b, 9.4.6.D, 9.4.8.J AND 9.5.P, TO REMOVE THE URBAN RESIDENTIAL (UR), AUTO-URBAN COMMERCIAL-TOWN (AC-TOJ), AUTO-URBAN RESIDENTIAL-TOWN (AR-TOJ), BUSINESS PARK RESTRICTED USES (BP-R), BUSINESS CONSERVATION-TOWN (BC-TOJ), RESIDENTIAL BUSINESS (RB), NEIGHBORHOOD CONSERVATION-TOWN (NC-TOJ), NEIGHBORHOOD CONSERVATION-2-FAMILY (NC-2), AND SUBURBAN-TOWN (S-TOJ) LEGACY ZONES, AND TO ADD THE NL-1: NEIGHBORHOOD LOW DENSITY 1, NL-2: NEIGHBORHOOD LOW DENSITY 2, NL-3: NEIGHBORHOOD LOW DENSITY 3, NL-4: NEIGHBORHOOD LOW DENSITY 4, NL-5: NEIGHBORHOOD LOW DENSITY 5, NM-1: NEIGHBORHOOD MEDIUM DENSITY 1, NM-2: NEIGHBORHOOD MEDIUM DENSITY 2, NH-1: NEIGHBORHOOD HIGH DENSITY 1, AND CR-3: COMMERCIAL RESIDENTIAL 3 CHARACTER ZONES, TO IMPLEMENT CHARACTER DISTRICTS 3 THROUGH 6 OF THE JACKSON/TETON COUNTY COMPREHENSIVE PLAN, AND PROVIDING FOR AN EFFECTIVE DATE.

BE IT ORDAINED BY THE GOVERNING BODY OF THE TOWN OF JACKSON, WYOMING, IN REGULAR SESSION DULY ASSEMBLED THAT:

SECTION I.

Section II of Town of Jackson Ordinance No. 1074 as amended (part) is hereby amended and reenacted to renumber Section 2.2.2 as 2.2.10, 2.2.3 as 2.2.11, 2.2.4 as 2.2.12, and 2.2.5 as 2.2.14; add Sections 2.2.2 through 2.2.9 and 2.2.13; delete Sections 2.3.4, 2.3.5, 2.3.6, 2.3.9, 2.3.11, 2.3.12, 2.3.14, 2.3.15, and 2.3.16; and amend Sections 2.1.1, 2.1.2, 2.2.1.D.5, 4.4.1.G, 5.2.1.D, 5.3.1.B.2, 5.3.1.B.5, 5.3.2.D.3, 5.4.1.B, 5.5.3.C.1, 5.5.3.D, 5.5.4.C, 5.6.1.E.7.a, 5.8.1.A, 6.1.1.F, 6.4.3.A, 7.1.1, 7.2.1, 7.8.4.B.1, 8.2.2.B.1.b, 9.4.6.D, 9.4.8.J, and 9.5.P of the Town of Jackson Land Development Regulations to read as on the following pages:

Div. 2.1. All Complete Neighborhood Zones

Complete neighborhood zones are intended to enhance the locations in the community that are most appropriate for use and development into the most desirable places to live, work, and play. There are 2 types of complete neighborhood zones.

2.1.1. Character Zones (P17-077)

Character zones, established in Div. 2.2., are character-based and established to implement the Comprehensive Plan. The character zones include:

- A. NL-1: Neighborhood Low Density-1
- B. NL-2: Neighborhood Low Density-2
- C. NL-3: Neighborhood Low Density-3
- D. NL-4: Neighborhood Low Density-4
- E. NL-5: Neighborhood Low Density -5
- F. NM-1: Neighborhood Medium Density-1
- G. NM-2: Neighborhood Medium Density-2
- H. NH-1: Neighborhood High Density-1
- I. DC: Downtown Core
- J. CR-1: Commercial Residential-1
- K. CR-2: Commercial Residential-2
- L. CR-3: Commercial Residential-3
- M. Office Residential (OR)

2.1.2. Legacy Zones (P17-077)

Legacy zones, established in Div. 2.3., are carried forward from the previous LDRs, and it is the intent that they will be phased out over time as character zones are adopted and applied. The legacy zones include:

- A. Town Square (TS)
- B. Urban Commercial (UC)
- C. Business Park-Town (BP-ToJ)
- D. Mobile Home Park-Town (MHP-ToJ)

4. Lodging



Description

In the Lodging Frontage, the main facade of the building is either set back or pulled up to the sidewalk with a street-facing entrance or series of entrances. The Lodging Frontage is intended primarily for lodging uses, and has a variety of glazing (windows and doors) at the sidewalk level.

Story Height	Sec. 9.4.13.	
Ground story height (min)	12'	A
Upper story height (min)	7' 6"	B
Ground floor elevation (min-max)	0' - 5'	C
Transparency	Sec. 9.4.14.	
Ground story, primary street (min)	40%	D
Ground story, secondary street (min)	20%	E
Upper story, primary/secondary street (min)	20%	F
Blank Wall Area	Sec. 9.4.15.	
Blank wall area, primary street (max)	35'	G
Blank wall area, secondary street (max)	50'	H
Pedestrian Access	Sec. 9.4.16.	
Entrance facing primary street	Required	I
Entrance spacing along primary street (max)	n/a	

5. Highway

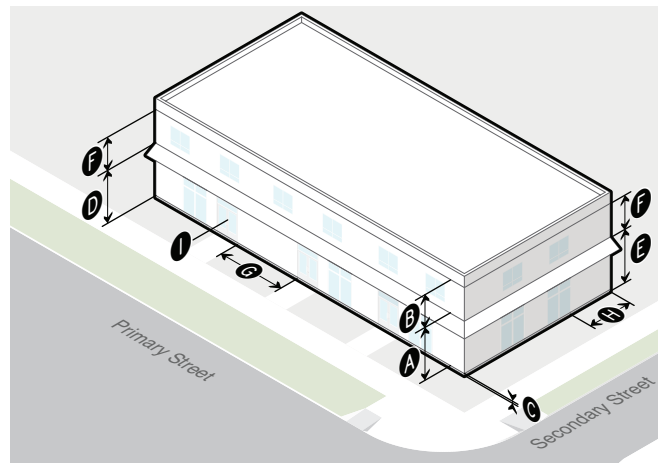

Description

The Highway Frontage is intended for a variety of uses that front Highway 89/191. Buildings must address the Highway by providing an operable building entrance that faces the Highway 89/191 and provide glazing (windows and doors) on both ground and upper story street-facing building facades.

Story Height	Sec. 9.4.13.	
Ground story height (min)	12'	
Upper story height (min)	9'	
Ground floor elevation (min-max)	0' - 5'	
Transparency	Sec. 9.4.14.	
Ground story, primary street (min)	40%	
Ground story, secondary street (min)	40%	
Upper story, primary/secondary street (min)	20%	
Blank Wall Area	Sec. 9.4.15.	
Blank wall area, primary street (max)	50'	
Blank wall area, secondary street (max)	50'	
Pedestrian Access	Sec. 9.4.16.	
Entrance facing primary street	Required	
Entrance spacing along primary street (max)	n/a	

2.2.2. NL-1: Neighborhood Low Density-1 (P17-077)

A. Intent

1. General Intent: The intent of the Neighborhood Low Density-1 (NL-1) zone is to provide for places with enough open space and sufficient lot size to provide a predominance of landscape and yards over buildings. Buildings and development should be oriented to respect steep slopes, preserve open space, and provide for wildlife movement through the property. This zone is intended for Stable neighborhoods where increased residential density is not intended.
2. Buildings: Buildings can be up to 2 stories in height. Multiple buildings on a site is common. Incentives are provided to encourage variety in roof pitch and design.
3. Parking: Parking is provided primarily on-site in garages or with surface spaces. Parking is typically accessed from a primary street, often including longer driveways.
4. Land Use: Single-family detached homes, accessory structures, and ARUs are the primary land uses.
5. Comprehensive Plan: Based primarily on Subarea 6.2 in the Comprehensive Plan.

B. Physical Development

Standards applicable to physical development are provided in this Section. Where a cross-reference is listed, see the referenced division or section for additional standards. Standards in Article 5 apply unless stated otherwise.

1. Lot Standards

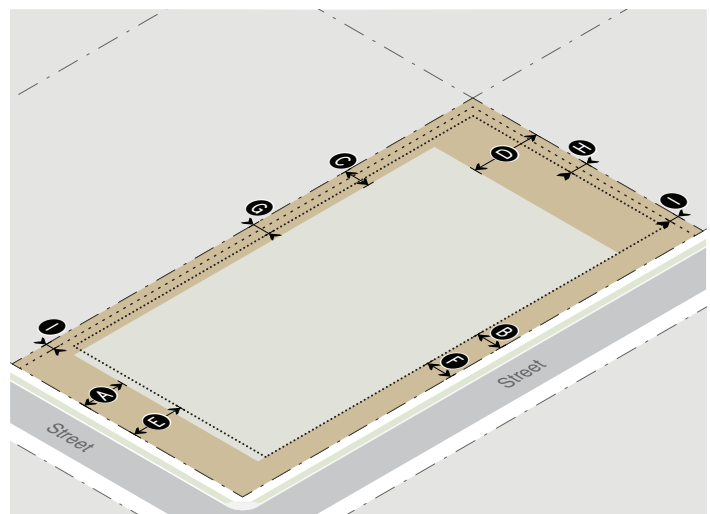

Primary Building Setbacks

(Sec. 9.4.8)

Primary street (min)	25'	A
Secondary street (min)	15'	B
Side interior (min)	15'	C
Rear (min)	40'	D

Accessory Structure Setbacks

(Sec. 9.4.8)

Primary street (min)	30'	E
Secondary street (min)	15'	F
Side interior/rear (min)	10'	G
Rear (min)	10'	H

Site Development Setbacks

All site development, excluding driveways or parking.

Primary/secondary street (min)	Same as primary building	
Side interior/rear (min)	5'	I

Landscaping

(Div. 5.5)

Landscape surface ratio (min)	.60
Plant units (min)	
Residential	1 per lot
Nonresidential	1 per 1,000 sf of landscape area
Parking lot (all uses)	1 per 12 parking spaces

2. Vehicle Access Standards

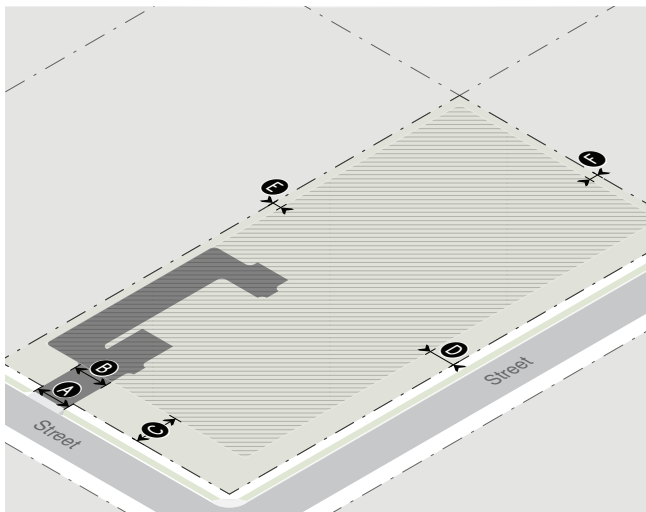

Access

Primary street	Allowed
Secondary street	Allowed
Alley	Allowed

Curb-cut width (max)	20' or 40% of lot frontage, whichever is less	A
----------------------	---	---

Driveway width in primary/secondary street setback (max)	20'	B
--	-----	---

Parking Setbacks

Primary street* (min)	25'	C
Secondary street* (min)	15'	D
Side interior (min)	5'	E
Rear (min)	5'	F

* Excludes 20' max driveway allowed in primary/secondary street setback

3. Bulk & Mass Standards

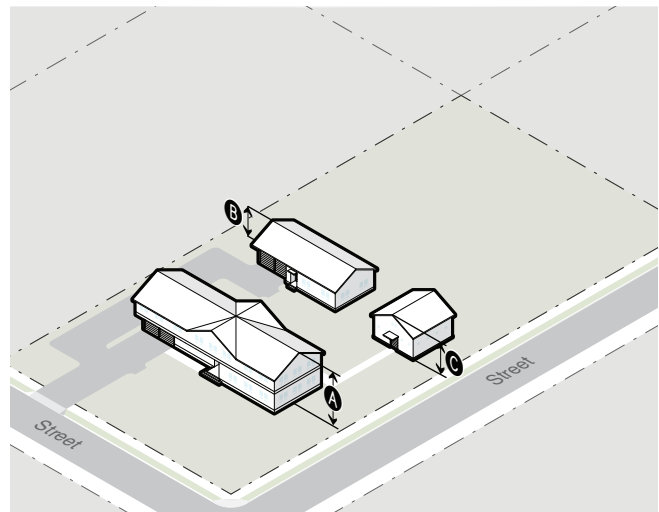

Design Guidelines

Div. 5.8

The Design Guidelines apply to all residential and nonresidential development of three attached units or greater, except where exempted by Planning Director for additions of 20% or less that are consistent with existing architecture.

Primary Building Height

Sec. 9.4.9

Height: roof pitch $\leq 3/12$ (max)	2 stories, not to exceed 26'	A
Height: roof pitch $4/12, 5/12$ (max)	2 stories, not to exceed 28'	A
Height: roof pitch $\geq 6/12$ (max)	2 stories, not to exceed 30'	A

Accessory Structure Height

Sec. 9.4.9

Accessory residential unit (max)	2 stories, not to exceed 26'	B
All other accessory structures (max)	14'	C

Scale of Development

Sec. 9.4.13

Floor area ratio (FAR max)	.40
Individual building (max gross floor area)	10,000 sf

4. Fencing	
Height (max)	
In street yard	4'
In side or rear yard	6'
Setback (min)	
Primary or secondary street lot line/R.O.W./sidewalk (min)	1'
Side or rear lot line	0'
Orientation	
The finished side of the fence shall face out to the neighbor, posts and supports shall face in to the owner	
5. Environmental Standards	
Natural Resource Setback (min)	(Sec. 5.1.1.)
Cache Creek South of Cache Creek Dr.	20'
Flat Creek North of Hansen Ave.	25'
Flat Creek South of Hansen Ave.	50'
Wetland	30'
Irrigation Ditch Setback (min)	(7.7.4.D.)
Irrigation Ditch	15'
Natural Resource Overlay (NRO) Standards	(Sec. 5.2.1.)
6. Scenic Standards	
Exterior Lighting	(Sec. 5.3.1.)
Light trespass prohibited	
All lights over 600 initial lumens shall be fully shielded	
Lumens per sf of site development (max)	1.5
Lumens per site (max)	
All fixtures	60,000
Unshielded fixtures	4,000
Light Color	≤3000 Kelvin
Scenic Resource Overlay (SRO) Standards	(Sec. 5.3.2.)
7. Natural Hazards to Avoid	
Steep Slopes	(Sec. 5.4.1.)
Development prohibited	Slopes > 25%
Hillside CUP required	Lot with average cross-slope ≥ 10%
Areas of Unstable Soils	(Sec. 5.4.2.)
Fault Area	(Sec. 5.4.3.)
Floodplains	(Sec. 5.4.4.)

Wildland Urban Interface		(Sec. 5.4.5.)
8. Signs		(Div. 5.6.)
Number of Signs (max)	3 per business per frontage	
Home occupation/business	1 unlit wall sign	
Background Color	No white or yellow	
Sign Area		
Total sign area (max)	3 sf per ft of street facade width up to 150 sf	
Home occupation/business	2 sf	
Penalty	10% per projecting and freestanding sign	
Sign Type Standards		
Canopy sign		
Clearance (min)	7'6" from average grade	
Setback (min)	18" from back of curb	
Freestanding sign		
Height (max)	6'	
Setback (min)	5'	
Projecting sign		
Height (max)	24' above grade	
Clearance (min)	7'6" from average grade	
Setback (min)	18" from back of curb	
Wall sign		
Window sign		
Window surface coverage (max)	25% up to 16 sf	
Temporary Signs	(Sec. 5.6.1.)	
9. Grading, Erosion Control, Stormwater		
Grading	(Sec. 5.7.2.)	
Erosion Control	(Sec. 5.7.3.)	
Erosion shall be controlled at all times		
Stormwater Management		
(Sec. 5.7.4.)		
No increase in peak flow rate or velocity across property lines		

10. Required Physical Development Permits						
Physical Development	Sketch Plan (Sec. 8.3.1.)	Development Plan (Sec. 8.3.2.)	Building Permit (Sec. 8.3.3.)	DRC Review (Sec. 8.2.6.)	Sign Permit (Sec. 8.3.5.)	Grading Permit (Sec. 8.3.4.)
Dwelling Unit						
< 5 units			X			(Sec. 5.7.1.)
5 - 10 units		X	X			(Sec. 5.7.1.)
> 10 units	X	X	X			(Sec. 5.7.1.)
Nonresidential Floor Area						
≤ 5,000 sf			X	X		(Sec. 5.7.1.)
5,001 - 15,000 sf		X	X	X		(Sec. 5.7.1.)
> 15,000 sf	X	X	X	X		(Sec. 5.7.1.)
Sign					X	(Sec. 5.7.1.)

C. Allowed Uses and Use Standards

Standards applicable to uses in the NL-1 zone are provided or referenced below. Allowed uses are listed in Subsection 1. Uses that are not listed are prohibited, unless a similar use determination is made pursuant to 6.1.2.D. Where a cross reference is provided, please see the referenced division or section for additional standards applicable in the NL-1 zone. This Subsection is intended to indicate all of the use standards applicable in the NL-1 zone, however, all standards in Article 6. are applicable in the NL-1 zone, unless stated otherwise.

1. Allowed Uses			2. Use Requirements		
Use	Permit	Density (max)	Individual Use	Parking (min) (Div. 6.2.)	Employee Housing Floor Area (min) (Div. 6.3.)
Open Space					to be amended pending Housing Mitigation LDR Update
Agriculture (6.1.3.B.)	B	n/a		n/a	
Residential					
Detached Single-Family Unit (6.1.4.B.)	Y	1 unit per lot	8,000 sf habitable excluding basement (max)	2/DU	to be amended pending Housing Mitigation LDR Update
Group Home (6.1.4.G.) (E.1.)	C	15 rooms per acre		0.5/bed	
Institutional					to be amended pending Housing Mitigation LDR Update
Assembly (6.1.8.B.)	C	n/a		independent calculation	
Transportation/Infrastructure					
Utility Facility (6.1.10.C.)	C	n/a		1/employee + 1/stored vehicle	to be amended pending Housing Mitigation LDR Update
Wireless Communications Facilities (6.1.10.D.)				1/employee + 1 per stored vehicle	
Minor	B	n/a			

Y=Use allowed, no use permit required, B=Basic Use Permit (Sec. 8.4.1.), C=Conditional Use Permit (Sec. 8.4.2.)

1. Allowed Uses			2. Use Requirements		
Use	Permit	Density (max)	Individual Use	Parking (min) (Div. 6.2.)	Employee Housing Floor Area (min) (Div. 6.3.)
Accessory Uses					
Accessory Residential Unit (6.1.11.B.) (E.2.)	B	1 unit per lot	Detached ARU on Lot < 18,000 sf (max): 500 sf habitable. All other ARUs (max): 800 sf habitable	1/DU 0-1 bedrooms 500 sf max; otherwise 1.5/DU	
Home Occupation (6.1.11.D.)	B	n/a		n/a	to be amended pending Housing Mitigation LDR Update
Home Business (6.1.11.E.)	C	n/a		1/employee	
Family Home Daycare (6.1.11.F.)	B	n/a		1/employee + 1 off-street pick-up/drop-off	
Home Daycare Center (6.1.11.G.)	C	n/a		1/employee + 2 off-street pick-up/drop-off	
Temporary Uses					
Temporary Shelter (6.1.12.D.)	B	1 unit per lot		2/DU	
Temp. Gravel Extraction and Processing (6.1.12.F.)	B	n/a		1/employee	

Y=Use allowed, no use permit required, B=Basic Use Permit (Sec. 8.4.1.), C=Conditional Use Permit (Sec. 8.4.2.)

3. Operational Standards	
Outdoor Storage	(Sec. 6.4.1.)
Refuse and Recycling	(Sec. 6.4.2.)
Trash & recycling enclosure required	> 4 DUs and all nonresidential
Noise	(Sec. 6.4.3.)
Sound level at property line (max)	65 DBA
Vibration	(Sec. 6.4.4.)
Electrical Disturbances	(Sec. 6.4.5.)
Fire and Explosive Hazards	(Sec. 6.4.6.)

D. Development Options and Subdivision

Standards applicable to development options and subdivision in the NL-1 zone are provided or referenced below. Where a cross reference is provided, please see the referenced division or section for additional standards applicable in the NL-1 zone. This Subsection is intended to indicate all of the development option and subdivision standards applicable in the NL-1 zone, however, all standards in Article 7. are applicable in the NL-1 zone, unless stated otherwise.

1. Allowed Subdivision and Development Options				
Option		Lot Size (min)	Standards	
Allowed Subdivision Options				
Land Division		43,560 sf	(Sec. 7.2.3.)	
2. Residential Subdivision Requirements				
Affordable Housing		<div>to be amended pending Housing Mitigation LDR Update</div>		
Required Affordable Housing				
Schools and Parks Exaction				
Schools exaction		.020 acres per 1- or 2-family unit .015 acres per multi-family unit		
Parks exaction		9 acres per 1,000 resident		
3. Infrastructure				
Transportation Facilities		(Div. 7.6.)		
Access		required		
Right-of-way for Minor Local Road (min)		60'		
Paved travel way for Minor Local Road (min)		20'		
Required Utilities		(Div. 7.7.)		
Water		public		
Sewer		public		
4. Required Subdivision and Development Option Permits				
Option	Sketch Plan (Sec. 8.3.1.)	Development Plan (Sec. 8.3.2.)	Development Option Plan (Sec. 8.5.2.)	Subdivision Plat (Sec. 8.5.3.)
Land Division				
≤ 10 Lots		X		X
> 10 Lots	X	X		X

E. Additional Zone-specific Standards

The following standards apply in addition to all other standards applicable in the NL-1 zone.

1. Group Home Use Standards

Group Home uses shall be located at least 300 feet from an existing dwelling unit, unless the group home use was proposed as part of a development that included both the group home use and the dwelling units.

2. Accessory Residential Units (ARUs)

- a. Home Occupations and Home Businesses in ARUs are prohibited.

F. Configuration Options

Configuration options in the NL-1 zone include, but are not limited to, the following:

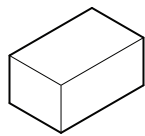

One Unit

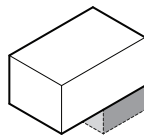

One Unit
+ One basement ARU

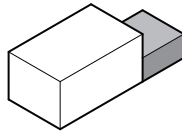

One Unit
+ One attached ARU

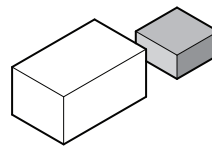

One Unit
+ One detached ARU

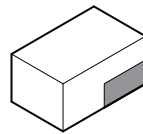

One Unit
+ One internal/basement ARU

2.2.3. NL-2: Neighborhood Low Density-2 (P17-077)

A. Intent

1. General Intent: The intent of the Neighborhood Low Density-2 (NL-2) zone is to provide for places with enough open space and sufficient lot size to provide a predominance of landscape and yards over buildings. Buildings and development should be oriented to respect steep slopes, preserve open space, and provide for wildlife movement through the property. This zone is intended for Stable neighborhoods where increased residential density is not intended.
2. Buildings: Buildings can be up to 2 stories in height. Multiple buildings on a site is common. Incentives are provided to encourage variety in roof pitch and design.
3. Parking: Parking is provided primarily on-site in garages or with surface spaces. Parking is typically accessed from a primary street, often including longer driveways.
4. Land Use: Single-family detached homes, accessory structures, and ARUs are the primary land uses.
5. Comprehensive Plan: Based primarily on Subarea 6.2 in the Comprehensive Plan.

B. Physical Development

Standards applicable to physical development are provided in this Section. Where a cross-reference is listed, see the referenced division or section for additional standards. Standards in Article 5 apply unless stated otherwise.

1. Lot Standards

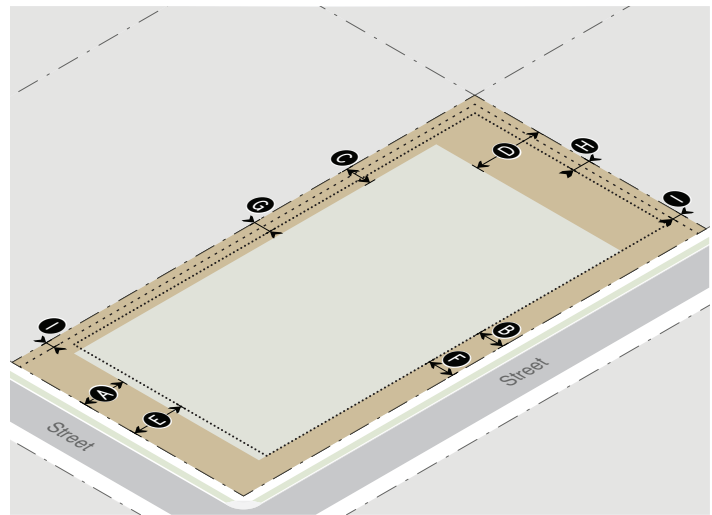

Primary Building Setbacks

(Sec. 9.4.8)

Primary street (min)	25'	A
Secondary street (min)	15'	B
Side interior (min)	15'	C
Rear (min)	25'	D

Accessory Structure Setbacks

(Sec. 9.4.8)

Primary street (min)	30'	E
Secondary street (min)	15'	F
Side interior/rear (min)	10'	G
Rear (min)	10'	H

Site Development Setbacks

All site development, excluding driveways or parking.

Primary/secondary street (min)	Same as primary building	
Side interior/rear (min)	5'	I

Landscaping

(Div. 5.5)

Landscape surface ratio (min)	.60
Plant units (min)	
Residential	1 per lot
Nonresidential	1 per 1,000 sf of landscape area
Parking lot (all uses)	1 per 12 parking spaces

2. Vehicle Access Standards

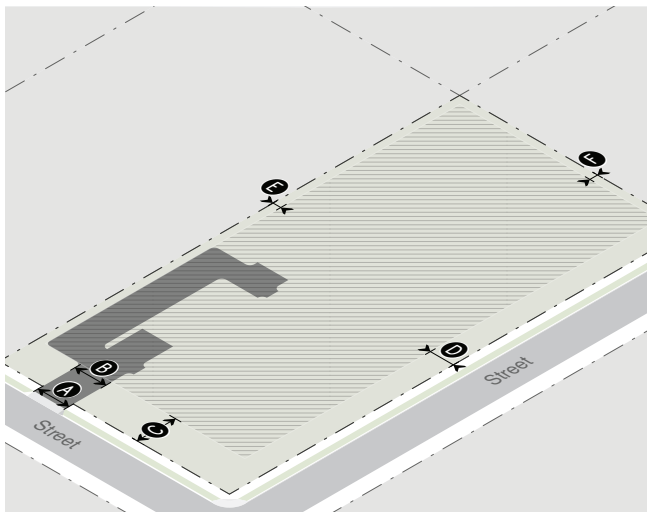

Access		
Primary street	Allowed	
Secondary street	Allowed	
Alley	Allowed	
Curb-cut width (max)	20' or 40% of lot frontage, whichever is less	A
Driveway width in primary/secondary street setback (max)	20'	B
Parking Setbacks		
Primary street* (min)	25'	C
Secondary street* (min)	15'	D
Side interior (min)	5'	E
Rear (min)	5'	F
* Excludes 20' max driveway allowed in primary/secondary street setback		

3. Bulk & Mass Standards

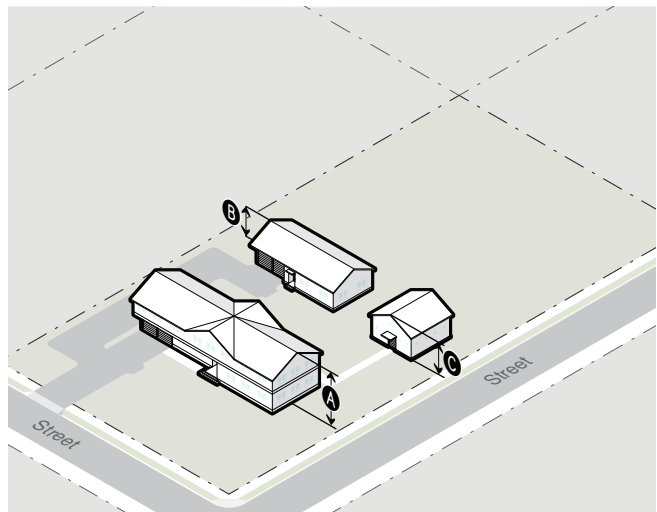

Design Guidelines

Div. 5.8

The Design Guidelines apply to all residential and nonresidential development of three attached units or greater, except where exempted by Planning Director for additions of 20% or less that are consistent with existing architecture.

Primary Building Height		Sec. 9.4.9
Height: roof pitch $\leq 3/12$ (max)	2 stories, not to exceed 26'	A
Height: roof pitch $4/12, 5/12$ (max)	2 stories, not to exceed 28'	A
Height: roof pitch $\geq 6/12$ (max)	2 stories, not to exceed 30'	A
Accessory Structure Height		Sec. 9.4.9
Accessory residential unit (max)	2 stories, not to exceed 26'	B
All other accessory structures (max)	14'	C
Scale of Development		Sec. 9.4.13
Floor area ratio (FAR max)	.40	
Individual Building (max gross floor area)	10,000 sf	

4. Fencing	
Height (max)	
In street yard	4'
In side or rear yard	6'
Setback (min)	
Primary or secondary street lot line/R.O.W./sidewalk (min)	1'
Side or rear lot line	0'
Orientation	
The finished side of the fence shall face out to the neighbor, posts and supports shall face in to the owner	
5. Environmental Standards	
Natural Resource Setback (min)	(Sec. 5.1.1.)
Cache Creek South of Cache Creek Dr.	20'
Flat Creek North of Hansen Ave.	25'
Flat Creek South of Hansen Ave.	50'
Wetland	30'
Irrigation Ditch Setback (min)	(7.7.4.D.)
Irrigation Ditch	15'
Natural Resource Overlay (NRO) Standards	(Sec. 5.2.1.)
6. Scenic Standards	
Exterior Lighting	(Sec. 5.3.1.)
Light trespass prohibited	
All lights over 600 initial lumens shall be fully shielded	
Lumens per sf of site development (max)	1.5
Lumens per site (max)	
All fixtures	60,000
Unshielded fixtures	4,000
Light Color	≤3000 Kelvin
Scenic Resource Overlay (SRO) Standards	(Sec. 5.3.2.)
7. Natural Hazards to Avoid	
Steep Slopes	(Sec. 5.4.1.)
Development prohibited	Slopes > 25%
Hillside CUP required	Lot with average cross-slope ≥ 10%
Areas of Unstable Soils	(Sec. 5.4.2.)
Fault Area	(Sec. 5.4.3.)

Floodplains	(Sec. 5.4.4.)
Wildland Urban Interface	(Sec. 5.4.5.)
8. Signs	
(Div. 5.6.)	
Number of Signs (max)	3 per business per frontage
Home occupation/business	1 unlit wall sign
Background Color	No white or yellow
Sign Area	
Total sign area (max)	3 sf per ft of street facade width up to 150 sf
Home occupation/business	2 sf
Penalty	10% per projecting and freestanding sign
Sign Type Standards	
Canopy sign	
Clearance (min)	7'6" from average grade
Setback (min)	18" from back of curb
Freestanding sign	
Height (max)	6'
Setback (min)	5'
Projecting sign	
Height (max)	24' above grade
Clearance (min)	7'6" from average grade
Setback (min)	18" from back of curb
Wall sign	
Window sign	
Window surface coverage (max)	25% up to 16 sf
Temporary Signs	(Sec. 5.6.1.)
9. Grading, Erosion Control, Stormwater	
Grading	(Sec. 5.7.2.)
Erosion Control	(Sec. 5.7.3.)
Erosion shall be controlled at all times	
Stormwater Management	(Sec. 5.7.4.)
No increase in peak flow rate or velocity across property lines	

10. Required Physical Development Permits						
Physical Development	Sketch Plan (Sec. 8.3.1.)	Development Plan (Sec. 8.3.2.)	Building Permit (Sec. 8.3.3.)	DRC Review (Sec. 8.2.6.)	Sign Permit (Sec. 8.3.5.)	Grading Permit (Sec. 8.3.4.)
Dwelling Unit						
< 5 units			X			(Sec. 5.7.1.)
5 - 10 units		X	X			(Sec. 5.7.1.)
> 10 units	X	X	X			(Sec. 5.7.1.)
Nonresidential Floor Area						
≤ 5,000 sf			X	X		(Sec. 5.7.1.)
5,001 - 15,000 sf		X	X	X		(Sec. 5.7.1.)
> 15,000 sf	X	X	X	X		(Sec. 5.7.1.)
Sign					X	(Sec. 5.7.1.)

C. Allowed Uses and Use Standards

Standards applicable to uses in the NL-2 zone are provided or referenced below. Allowed uses are listed in Subsection 1. Uses that are not listed are prohibited, unless a similar use determination is made pursuant to 6.1.2.D. Where a cross reference is provided, please see the referenced division or section for additional standards applicable in the NL-2 zone. This Subsection is intended to indicate all of the use standards applicable in the NL-2 zone, however, all standards in Article 6. are applicable in the NL-2 zone, unless stated otherwise.

1. Allowed Uses				2. Use Requirements	
Use	Permit	Density (max)	Individual Use (max)	Parking (min) (Div. 6.2.)	Employee Housing Floor Area (min) (Div. 6.3.)
Open Space					
Agriculture (6.1.3.B.)	B	n/a		n/a	to be amended pending Housing Mitigation LDR Update
Residential					
Detached Single-Family Unit (6.1.4.B.)	Y	1 unit per lot	8,000 sf habitable excluding basement	2/DU	to be amended pending Housing Mitigation LDR Update
Group Home (6.1.4.G.) (E.1.)	C	15 rooms per acre		0.5/bed	
Institutional					
Assembly (6.1.8.B.)	C	n/a		independent calculation	to be amended pending Housing Mitigation LDR Update
Transportation/Infrastructure					
Utility Facility (6.1.10.C.)	C	n/a		1/employee + 1/stored vehicle	to be amended pending Housing Mitigation LDR Update
Wireless Communications Facilities (6.1.10.D.)					
Minor	B	n/a		1/employee + 1 per stored vehicle	

Y=Use allowed, no use permit required, B=Basic Use Permit (Sec. 8.4.1.), C=Conditional Use Permit (Sec. 8.4.2.)

1. Allowed Uses				2. Use Requirements	
Use	Permit	Density (max)	Individual Use (max)	Parking (min) (Div. 6.2.)	Employee Housing Floor Area (min) (Div. 6.3.)
Accessory Uses					
Accessory Residential Unit (6.1.11.B.) (E.2.)	B	1 unit per lot	Detached ARU on Lot < 18,000 sf (max): 500 sf habitable All other ARUs: 800 sf habitable	1/DU 0-1 bedrooms 500 sf max; otherwise 1.5/DU	to be amended pending Housing Mitigation LDR Update
Home Occupation (6.1.11.D.)	B	n/a		n/a	
Home Business (6.1.11.E.)	C	n/a		1/employee	
Family Home Daycare (6.1.11.F.)	B	n/a		1/employee + 1 off-street pick-up/drop-off	
Home Daycare Center (6.1.11.G.)	C	n/a		1/employee + 2 off-street pick-up/drop-off	
Temporary Uses					
Temporary Shelter (6.1.12.D.)	B	1 unit per lot		2/DU	
Temp. Gravel Extraction and Processing (6.1.12.F.)	B	n/a		1/employee	

Y=Use allowed, no use permit required, B=Basic Use Permit (Sec. 8.4.1.), C=Conditional Use Permit (Sec. 8.4.2.)

3. Operational Standards	
Outdoor Storage	(Sec. 6.4.1.)
Refuse and Recycling	(Sec. 6.4.2.)
Trash & recycling enclosure required	> 4 DUs and all nonresidential
Noise	(Sec. 6.4.3.)
Sound level at property line (max)	65 DBA
Vibration	(Sec. 6.4.4.)
Electrical Disturbances	(Sec. 6.4.5.)
Fire and Explosive Hazards	(Sec. 6.4.6.)

D. Development Options and Subdivision

Standards applicable to development options and subdivision in the NL-2 zone are provided or referenced below. Where a cross reference is provided, please see the referenced division or section for additional standards applicable in the NL-2 zone. This Subsection is intended to indicate all of the development option and subdivision standards applicable in the NL-2 zone, however, all standards in Article 7. are applicable in the NL-2 zone, unless stated otherwise.

1. Allowed Subdivision and Development Options				
Option	Lot Size (min)	Standards		
Allowed Subdivision Options				
Land Division	21,780 sf	(Sec. 7.2.3.)		
2. Residential Subdivision Requirements				
Affordable Housing		to be amended pending Housing Mitigation LDR Update		
Required Affordable Housing				
Schools and Parks Exaction				
Schools exaction	.020 acres per 1- or 2-family unit .015 acres per multi-family unit			
Parks exaction	9 acres per 1,000 resident			
3. Infrastructure				
Transportation Facilities		(Div. 7.6.)		
Access		required		
Right-of-way for Minor Local Road (min)		60'		
Paved travel way for Minor Local Road (min)		20'		
Required Utilities		(Div. 7.7.)		
Water		public		
Sewer		public		
4. Required Subdivision and Development Option Permits				
Option	Sketch Plan (Sec. 8.3.1.)	Development Plan (Sec. 8.3.2.)	Development Option Plan (Sec. 8.5.2.)	Subdivision Plat (Sec. 8.5.3.)
Land Division				
≤ 10 Lots		X		X
> 10 Lots	X	X		X

E. Additional Zone-specific Standards

The following standards apply in addition to all other standards applicable in the NL-2 zone.

1. Group Home Use Standards

Group Home uses shall be located at least 300 feet from an existing dwelling unit, unless the group home use was proposed as part of a development that included both the group home use and the dwelling units.

2. Accessory Residential Units (ARUs)

- a. Home Occupations and Home Businesses in ARUs are prohibited.

F. Configuration Options

Configuration options in the NL-2 zone include, but are not limited to, the following:

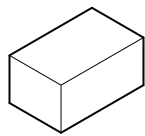

One Unit

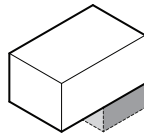

One Unit
+ One basement ARU

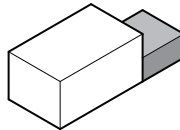

One Unit
+ One attached ARU

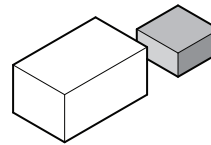

One Unit
+ One detached ARU

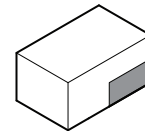

One Unit
+ One internal/basement ARU

2.2.4. NL-3: Neighborhood Low Density-3 (P17-077)

A. Intent

1. General Intent: The intent of the Neighborhood Low Density-3 (NL-3) zone is to recognize existing residential neighborhoods and subdivisions and allow development of Single-Family detached homes with up to one Accessory Residential Unit (ARU) in a way that is consistent with the existing neighborhood character. This zone is intended for Stable neighborhoods where increased residential density is not intended.
2. Buildings: Buildings can be up to 2 stories in height. Multiple buildings on a site is common. Incentives are provided to encourage variety in roof pitch and design.
3. Parking: Parking is provided primarily on-site in garages or with surface spaces. Parking is typically accessed from a primary street.
4. Land Use: Single-family detached homes, accessory structures, and ARUs are the primary land uses.
5. Comprehensive Plan: Based primarily on Subareas 3.1, 5.5, and 6.1 in the Comprehensive Plan.

B. Physical Development

Standards applicable to physical development are provided in this Section. Where a cross-reference is listed, see the referenced division or section for additional standards. Standards in Article 5 apply unless stated otherwise.

1. Lot Standards

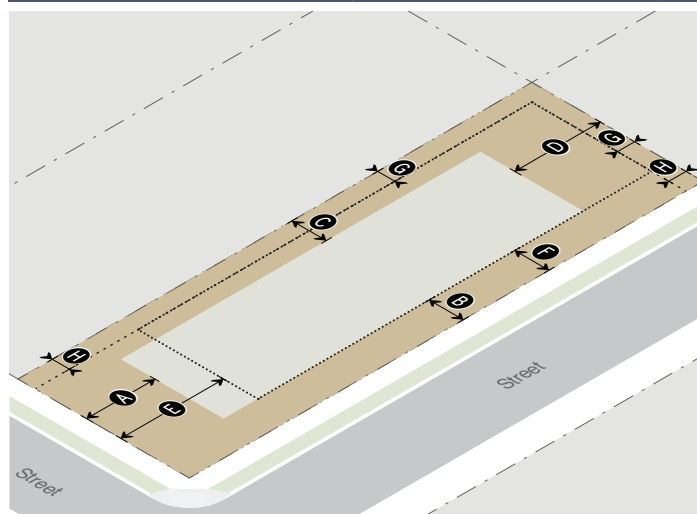

Primary Building Setbacks

(Sec. 9.4.8)

Primary street (min)	20'	A
Secondary street (min)	10'	B
Side interior (min)	10'	C
Rear (min)	25'	D

Accessory Structure Setbacks

(Sec. 9.4.8)

Primary street (min)	30'	E
Secondary street (min)	10'	F
Side interior/rear (min)		G
>14 feet in height	10'	
≤14 feet in height	5'	
Second floor deck	10'	

Site Development Setbacks

All site development, excluding driveways or parking.

Primary/secondary street (min)	Same as primary building	
Side interior/rear (min)	5'	H

Landscaping

(Div. 5.5)

Landscape surface ratio (min)	.45
Plant units (min)	1 per lot

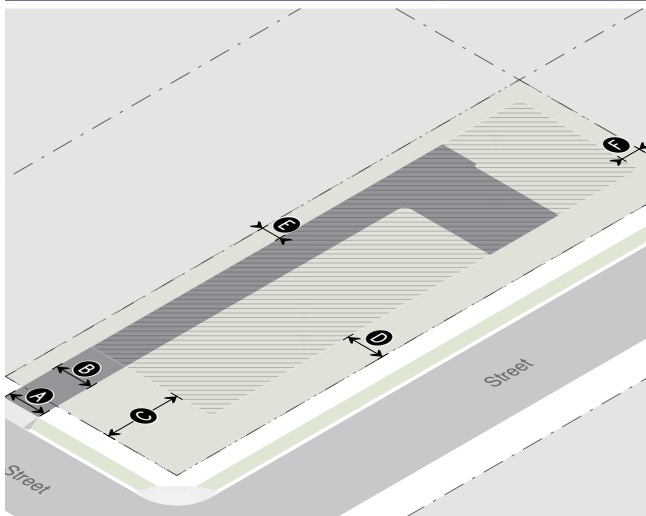
2. Vehicle Access Standards**Access**

Primary street	Allowed
Secondary street	Allowed
Alley	Allowed

Curb-cut width (max)	20' or 40% of lot frontage, whichever is less	A
----------------------	---	----------

Driveway width in primary/secondary street setback (max)	20'	B
--	-----	----------

Parking Setbacks

Primary street* (min)	20'	C
Secondary street* (min)	10'	D
Side interior (min)	5'	E
Rear (min)	5'	F

*Excludes 20' max driveway allowed in primary/secondary street setback

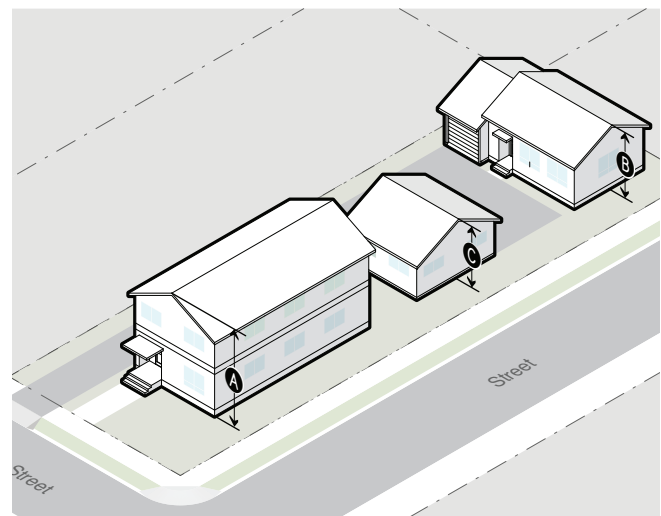
3. Bulk & Mass Standards**Design Guidelines**

Div. 5.8

The Design Guidelines apply to all residential and nonresidential development of three attached units or greater, except where exempted by Planning Director for additions of 20% or less that are consistent with existing architecture.

Primary Building Height (Sec. 9.4.9)

Height: roof pitch $\leq 3/12$ (max)	2 stories, not to exceed 26'	A
Height: roof pitch $4/12, 5/12$ (max)	2 stories, not to exceed 28'	A
Height: roof pitch $\geq 6/12$ (max)	2 stories, not to exceed 30'	A

Accessory Structure Height (Sec. 9.4.9)

Accessory residential unit (max)	2 stories, not to exceed 26'	B
All other accessory structures (max)	14'	C

Scale of Development (Sec. 9.4.13)

Floor area ratio (FAR max)	.40
Individual Building (max gross floor area)	n/a

4. Fencing	
Height (max)	
In street yard	4'
In side or rear yard	6'
Setback (min)	
Primary or secondary street lot line/R.O.W./sidewalk (min)	1'
Side or rear lot line	0'
Orientation	
The finished side of the fence shall face out to the neighbor, posts and supports shall face in to the owner	
5. Environmental Standards	
Natural Resource Setback (min)	(Sec. 5.1.1.)
Cache Creek South of Cache Creek Dr.	20'
Flat Creek North of Hansen Ave.	25'
Flat Creek South of Hansen Ave.	50'
Wetland	30'
Irrigation Ditch Setback (min)	(7.7.4.D.)
Irrigation Ditch	15'
Natural Resource Overlay (NRO) Standards	(Sec. 5.2.1.)
6. Scenic Standards	
Exterior Lighting	(Sec. 5.3.1.)
Light trespass prohibited	
All lights over 600 initial lumens shall be fully shielded	
Lumens per sf of site development (max)	1.5
Lumens per site (max)	
All fixtures	60,000
Unshielded fixtures	4,000
Light Color	≤3000 Kelvin
Scenic Resource Overlay (SRO) Standards	(Sec. 5.3.2.)
7. Natural Hazards to Avoid	
Steep Slopes	(Sec. 5.4.1.)
Development prohibited	Slopes > 25%
Hillside CUP required	Lot with average cross-slope ≥ 10%

Areas of Unstable Soils	(Sec. 5.4.2.)
Fault Area	(Sec. 5.4.3.)
Floodplains	(Sec. 5.4.4.)
Wildland Urban Interface	(Sec. 5.4.5.)
8. Signs	(Div. 5.6.1.)
Home occupation/business	1 unlit wall sign
Area (max)	2 sf
Background color	No white or yellow
Temporary Signs	(Sec. 5.6.1.)
9. Grading, Erosion Control, Stormwater	
Grading	(Sec. 5.7.2.)
Erosion Control	(Sec. 5.7.3.)
Erosion shall be controlled at all times	
Stormwater Management	(Sec. 5.7.4.)
No increase in peak flow rate or velocity across property lines	

10. Required Physical Development Permits

Physical Development	Sketch Plan (Sec. 8.3.1.)	Development Plan (Sec. 8.3.2.)	Building Permit (Sec. 8.3.3.)	DRC Review (Sec. 8.2.6.)	Sign Permit (Sec. 8.3.5.)	Grading Permit (Sec. 8.3.4.)
Dwelling Unit						
< 5 units			X			(Sec. 5.7.1.)
5 - 10 units		X	X			(Sec. 5.7.1.)
> 10 units	X	X	X			(Sec. 5.7.1.)
Sign					X	(Sec. 5.7.1.)

C. Allowed Uses and Use Standards

Standards applicable to uses in the NL-3 zone are provided or referenced below. Allowed uses are listed in Subsection 1. Uses that are not listed are prohibited, unless a similar use determination is made pursuant to 6.1.2.D. Where a cross reference is provided, please see the referenced division or section for additional standards applicable in the NL-3 zone. This Subsection is intended to indicate all of the use standards applicable in the NL-3 zone, however, all standards in Article 6. are applicable in the NL-3 zone, unless stated otherwise.

1. Allowed Uses				2. Use Requirements	
Use	Permit	Density (max)	Individual Use (max)	Parking (min) (Div. 6.2.)	Employee Housing Floor Area (min) (Div. 6.3.)
Open Space					
Agriculture (6.1.3.B.)	B	n/a		n/a	to be amended pending Housing Mitigation LDR Update
Residential					
Detached Single-Family Unit (6.1.4.B.)	Y	1 unit per lot	8,000 sf habitable excluding basement	2/DU	to be amended pending Housing Mitigation LDR Update
Transportation/Infrastructure					
Utility Facility (6.1.10.C.)	C	n/a		1/employee + 1/stored vehicle	to be amended pending Housing Mitigation LDR Update
Wireless Communications Facilities (6.1.10.D.)				1/employee + 1 per stored vehicle	
Minor	B	n/a			
Accessory Uses					
Accessory Residential Unit (Sec. 6.1.11.) (E.1)	B	1 unit per lot	Detached ARU on Lot < 11,250 sf: 500 sf habitable All other ARUs: 800 sf habitable	1/DU 0-1 bedrooms 500 sf max; otherwise 1.5/DU	to be amended pending Housing Mitigation LDR Update
Home Occupation (6.1.11.D.)	B	n/a		n/a	
Home Business (6.1.11.E.)	C	n/a		1/employee	

Y=Use allowed, no use permit required, B=Basic Use Permit (Sec. 8.4.1.), C=Conditional Use Permit (Sec. 8.4.2.)

1. Allowed Uses			2. Use Requirements		
Use	Permit	Density (max)	Individual Use (max)	Parking (min) (Div. 6.2.)	Employee Housing Floor Area (min) (Div. 6.3.)
Family Home Daycare (6.1.11.F.)	B	n/a		1/employee + 1 off-street pick-up/drop-off	to be amended pending Housing Mitigation LDR Update
Temporary Uses					
Temporary Shelter (6.1.12.D.)	B	1 unit per lot		2/DU	
Temp. Gravel Extraction and Processing (6.1.12.F.)	B	n/a		1/employee	

Y=Use allowed, no use permit required, B=Basic Use Permit (Sec. 8.4.1.), C=Conditional Use Permit (Sec. 8.4.2.)

3. Operational Standards	
Outdoor Storage	(Sec. 6.4.1.)
Refuse and Recycling	(Sec. 6.4.2.)
Trash & recycling enclosure not required	
Noise	(Sec. 6.4.3.)
Sound level at property line (max)	65 DBA
Vibration	(Sec. 6.4.4.)
Electrical Disturbances	(Sec. 6.4.5.)
Fire and Explosive Hazards	(Sec. 6.4.6.)

D. Development Options and Subdivision

Standards applicable to development options and subdivision in the NL-3 zone are provided or referenced below. Where a cross reference is provided, please see the referenced division or section for additional standards applicable in the NL-3 zone. This Subsection is intended to indicate all of the development option and subdivision standards applicable in the NL-3 zone, however, all standards in Article 7. are applicable in the NL-3 zone, unless stated otherwise.

1. Allowed Subdivision and Development Options		
Option	Lot Size (min)	Option Standards
Allowed Subdivision Options		
Land Division	7,500 sf	(Sec. 7.2.3.)
2. Residential Subdivision Requirements		
Affordable Housing	to be amended pending Housing Mitigation LDR Update	
Required Affordable Housing		
Schools and Parks Exaction		
Schools exaction	.020 acres per 1- or 2-family unit .015 acres per multi-family unit	
Parks exaction	9 acres per 1,000 resident	

3. Infrastructure
Transportation Facilities
Access
Right-of-way for Minor Local Road (min)
Paved travel way for Minor Local Road (min)
Required Utilities
Water
Sewer

4. Required Subdivision and Development Option Permits				
Option	Sketch Plan (Sec. 8.3.1.)	Development Plan (Sec. 8.3.2.)	Development Option Plan (Sec. 8.5.2.)	Subdivision Plat (Sec. 8.5.3.)
Land Division				
≤ 10 Lots		X		X
> 10 Lots	X	X		X

E. Additional Zone-specific Standards

The following standards apply in addition to all other standards applicable in the NL-3 zone.

1. Accessory Residential Units (ARUs)

- Accessory residential units are prohibited north of West Broadway accessed via Budge Drive and West Broadway Avenue.
- Home Occupations and Home Businesses in ARUs are prohibited.
- Detached ARUs shall only be permitted on lots that meet minimum lot size.

F. Configuration Options

Configuration options in the NL-3 zone include, but are not limited to, the following:

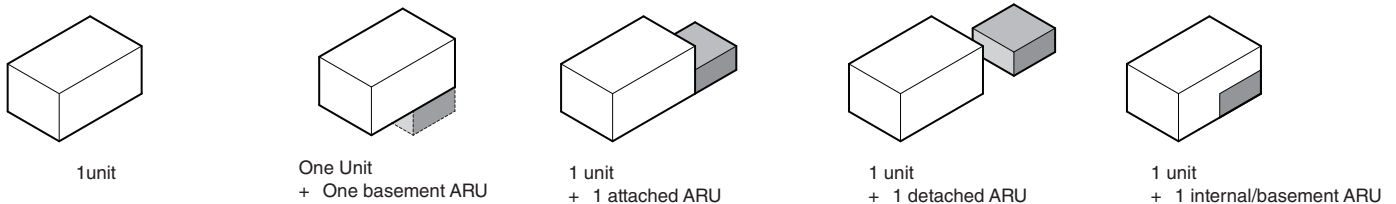

2.2.5. NL-4: Neighborhood Low Density-4 (P17-077)

A. Intent

1. General Intent: The intent of the Neighborhood Low Density-4 (NL-4) zone is to recognize existing residential neighborhoods and subdivisions and allow development of Single-Family detached homes with up to two Accessory Residential Units (ARUs) in a way that is consistent with the existing neighborhood character. This zone is intended for properties with alley access and for Stable neighborhoods where increased residential density is not intended.
2. Buildings: Buildings can be up to 2 stories in height. Multiple buildings on a site is common. Incentives are provided to encourage variety in roof pitch and design.
3. Parking: Parking is provided primarily on-site in garages or with surface spaces. Parking for new development will typically be accessed from an alley while existing development is often accessed from a primary street.
4. Land Use: Single-family detached homes, accessory structures, and ARUs are the primary land uses.
5. Comprehensive Plan: Based primarily on Subarea 3.1 in the Comprehensive Plan.

B. Physical Development

Standards applicable to physical development are provided in this Section. Where a cross-reference is listed, see the referenced division or section for additional standards. Standards in Article 5 apply unless stated otherwise.

1. Lot Standards

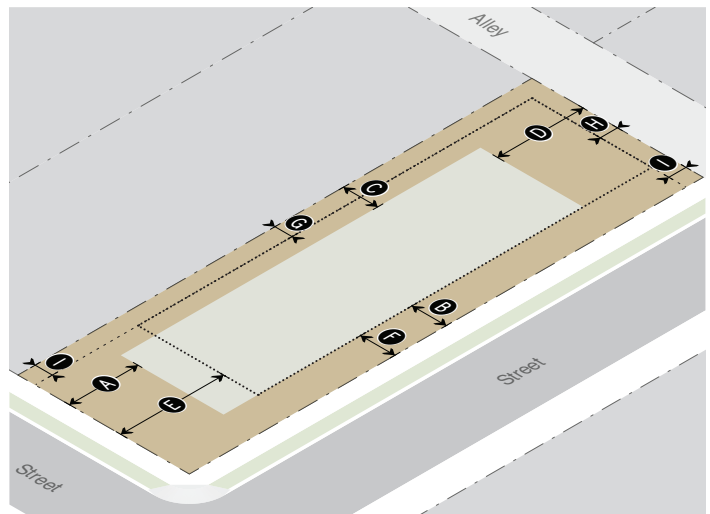

Primary Building Setbacks

(Sec. 9.4.8)

Primary street (min)	20'	A
Secondary street (min)	10'	B
Side interior (min)	10'	C
Rear (min)	25'	D

Accessory Structure Setbacks

(Sec. 9.4.8)

Primary street (min)	30'	E
Secondary street (min)	10'	F
Side interior/rear (min)		G H
>14 feet in height	10'	
≤14 feet in height	5'	
Second floor deck	10'	

Site Development Setbacks

All site development, excluding driveways or parking.

Primary/secondary street (min)	Same as primary building	
Side interior/rear (min)	5'	I

Landscaping

(Div. 5.5)

Landscape surface ratio (min)	.45
Plant units (min)	1 per lot

2. Vehicle Access Standards

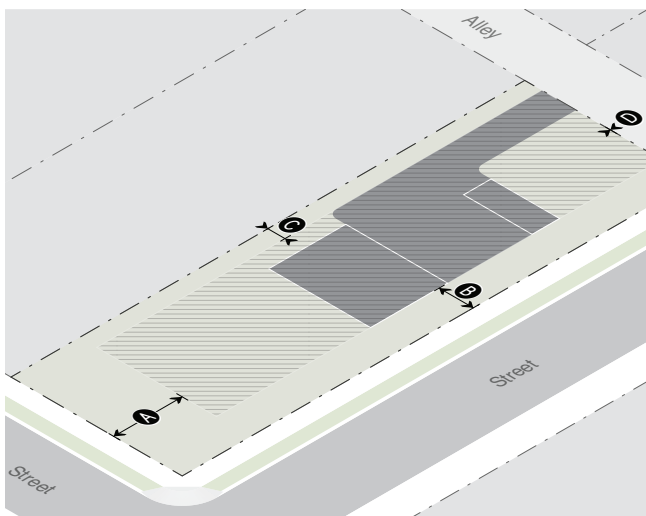

Access

Primary street	Allowed
Secondary street	Allowed
Alley	Allowed

Curb-cut width (max)	20' or 40% of lot frontage, whichever is less	A
Driveway width in primary/secondary street setback (max)	20'	B

Parking Setbacks

Primary street (min)	20'	A
Secondary street (min)	10'	B
Side interior (min)	5'	C
Rear (min)	5'	
Rear alley (min)	2'	D

3. Bulk & Mass Standards

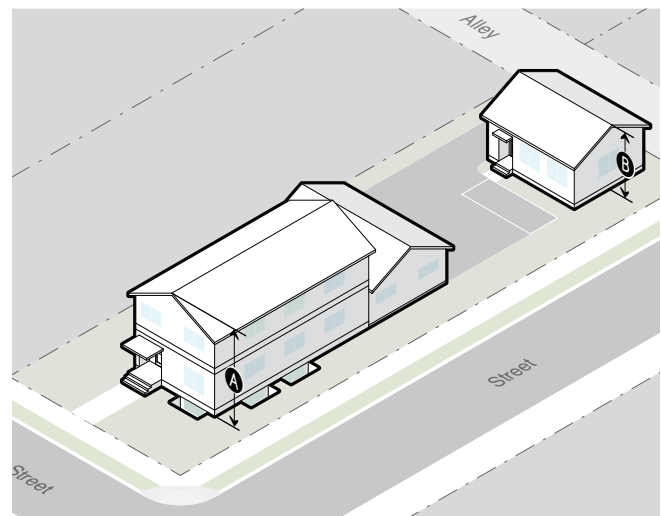

Design Guidelines

Div. 5.8

The Design Guidelines apply to all residential and nonresidential development of three attached units or greater, except where exempted by Planning Director for additions of 20% or less that are consistent with existing architecture.

Primary Building Height	(Sec. 9.4.9)
Height: roof pitch $\leq 3/12$ (max)	2 stories, not to exceed 26' A
Height: roof pitch $4/12, 5/12$ (max)	2 stories, not to exceed 28' A
Height: roof pitch $\geq 6/12$ (max)	2 stories, not to exceed 30' A

Accessory Structure Height	(Sec. 9.4.9)
Accessory residential unit (max)	2 stories, not to exceed 26' B
All other accessory structures (max)	14'

Scale of Development	(Sec. 9.4.13)
Floor area ratio (FAR max)	.40
Individual Building (max gross floor area)	n/a

4. Fencing	
Height (max)	
In street yard	4'
In side or rear yard	6'
Setback (min)	
Primary or secondary street lot line/R.O.W./sidewalk (min)	1'
Side or rear lot line	0'
Orientation	
The finished side of the fence shall face out to the neighbor, posts and supports shall face in to the owner	
5. Environmental Standards	
Natural Resource Setback (min)	(Sec. 5.1.1.)
Cache Creek South of Cache Creek Dr.	20'
Flat Creek North of Hansen Ave.	25'
Flat Creek South of Hansen Ave.	50'
Wetland	30'
Irrigation Ditch Setback (min)	(7.7.4.D.)
Irrigation Ditch	15'
Natural Resource Overlay (NRO) Standards	(Sec. 5.2.1.)
6. Scenic Standards	
Exterior Lighting	(Sec. 5.3.1.)
Light trespass prohibited	
All lights over 600 initial lumens shall be fully shielded	
Lumens per sf of site development (max)	1.5
Lumens per site (max)	
All fixtures	60,000
Unshielded fixtures	4,000
Light Color	≤3000 Kelvin
Scenic Resource Overlay (SRO) Standards	(Sec. 5.3.2.)

7. Natural Hazards to Avoid	
Steep Slopes	(Sec. 5.4.1.)
Development prohibited	Slopes > 25%
Hillside CUP required	Lot with average cross-slope ≥ 10%
Areas of Unstable Soils	(Sec. 5.4.2.)
Fault Area	(Sec. 5.4.3.)
Floodplains	(Sec. 5.4.4.)
Wildland Urban Interface	(Sec. 5.4.5.)
8. Signs	
Home occupation/business	1 unlit wall sign
Area (max)	2 sf
Background color	No white or yellow
Temporary Signs	(Sec. 5.6.1.)
9. Grading, Erosion Control, Stormwater	
Grading	(Sec. 5.7.2.)
Erosion Control	(Sec. 5.7.3.)
Erosion shall be controlled at all times	
Stormwater Management	(Sec. 5.7.4.)
No increase in peak flow rate or velocity across property lines	

10. Required Physical Development Permits						
Physical Development	Sketch Plan (Sec. 8.3.1.)	Development Plan (Sec. 8.3.2.)	Building Permit (Sec. 8.3.3.)	DRC Review (Sec. 8.2.6.)	Sign Permit (Sec. 8.3.5.)	Grading Permit (Sec. 8.3.4.)
Dwelling Unit						
< 5 units			X			(Sec. 5.7.1.)
5 - 10 units		X	X			(Sec. 5.7.1.)
> 10 units	X	X	X			(Sec. 5.7.1.)
Sign					X	(Sec. 5.7.1.)

C. Allowed Uses and Use Standards

Standards applicable to uses in the NL-4 zone are provided or referenced below. Allowed uses are listed in Subsection 1. Uses that are not listed are prohibited, unless a similar use determination is made pursuant to 6.1.2.D. Where a cross reference is provided, please see the referenced division or section for additional standards applicable in the NL-4 zone. This Subsection is intended to indicate all of the use standards applicable in the NL-4 zone, however, all standards in Article 6. are applicable in the NL-4 zone, unless stated otherwise.

1. Allowed Uses			2. Use Requirements		
Use	Permit	Density (max)	Individual Use (max)	Parking (min) (Div. 6.2.)	Employee Housing Floor Area (min) (Div. 6.3.)
Open Space					
Agriculture (6.1.3.B.)	B	n/a		n/a	to be amended pending Housing Mitigation LDR Update
Residential					
Detached Single-Family Unit (6.1.4.B.)	Y	1 unit per lot	8,000 sf habitable-excluding basemen	2/DU	to be amended pending Housing Mitigation LDR Update
Transportation/Infrastructure					
Utility Facility (6.1.10.C.)	C	n/a		1/employee + 1/stored vehicle	to be amended pending Housing Mitigation LDR Update
Wireless Communications Facilities (6.1.10.D.)					
Minor	B	n/a		1/employee + 1 per stored vehicle	
Accessory Uses					
Accessory Residential Unit (Sec. 6.1.11.) (E.1)	B	2 units per lot	Detached ARU on Lot < 11,250 sf: 500 sf habitable All other ARUs: 800 sf habitable	1/DU 0-1 bedrooms 500 sf max; otherwise 1.5/DU	to be amended pending Housing Mitigation LDR Update
Home Occupation (6.1.11.D.)	B	n/a		n/a	
Home Business (6.1.11.E.)	C	n/a		1/employee	

Y=Use allowed, no use permit required, B=Basic Use Permit (Sec. 8.4.1.), C=Conditional Use Permit (Sec. 8.4.2.)

1. Allowed Uses			2. Use Requirements		
Use	Permit	Density (max)	Individual Use (max)	Parking (min) (Div. 6.2.)	Employee Housing Floor Area (min) (Div. 6.3.)
Family Home Daycare (6.1.11.F.)	B	n/a		1/employee + 1 off-street pick-up/drop-off	to be amended pending Housing Mitigation LDR Update
Temporary Uses					
Temporary Shelter (6.1.12.D.)	B	1 unit per lot		2/DU	
Temp. Gravel Extraction and Processing (6.1.12.F.)	B	n/a		1/employee	

Y=Use allowed, no use permit required, B=Basic Use Permit (Sec. 8.4.1.), C=Conditional Use Permit (Sec. 8.4.2.)

3. Operational Standards	
Outdoor Storage	(Sec. 6.4.1.)
Refuse and Recycling	(Sec. 6.4.2.)
Trash & recycling enclosure not required	
Noise	(Sec. 6.4.3.)
Sound level at property line (max)	65 DBA
Vibration	(Sec. 6.4.4.)
Electrical Disturbances	(Sec. 6.4.5.)
Fire and Explosive Hazards	(Sec. 6.4.6.)

D. Development Options and Subdivision

Standards applicable to development options and subdivision in the NL-4 zone are provided or referenced below. Where a cross reference is provided, please see the referenced division or section for additional standards applicable in the NL-4 zone. This Subsection is intended to indicate all of the development option and subdivision standards applicable in the NL-4 zone, however, all standards in Article 7. are applicable in the NL-4 zone, unless stated otherwise.

1. Allowed Subdivision and Development Options		
Option	Lot Size (min)	Option Standards
Allowed Subdivision Options		
Land Division	7,500 sf	(Sec. 7.2.3.)
2. Residential Subdivision Requirements		
Affordable Housing	to be amended pending Housing Mitigation LDR Update	
Required Affordable Housing		
Schools and Parks Exaction		
Schools exaction	.020 acres per 1- or 2-family unit .015 acres per multi-family unit	
Parks exaction	9 acres per 1,000 resident	

3. Infrastructure
Transportation Facilities
Access
Right-of-way for Minor Local Road (min)
Paved travel way for Minor Local Road (min)
Required Utilities
Water
Sewer

4. Required Subdivision and Development Option Permits				
Option	Sketch Plan (Sec. 8.3.1.)	Development Plan (Sec. 8.3.2.)	Development Option Plan (Sec. 8.5.2.)	Subdivision Plat (Sec. 8.5.3.)
Land Division				
≤ 10 Lots		X		X
> 10 Lots	X	X		X

E. Additional Zone-specific Standards

The following standards apply in addition to all other standards applicable in the NL-4 zone.

1. Accessory Residential Units (ARUs)

- Home Occupations and Home Businesses in ARUs are prohibited.
- Detached ARUs shall only be permitted on lots that meet minimum lot size.

F. Configuration Options

Configuration options in the NL-4 zone include, but are not limited to, the following:

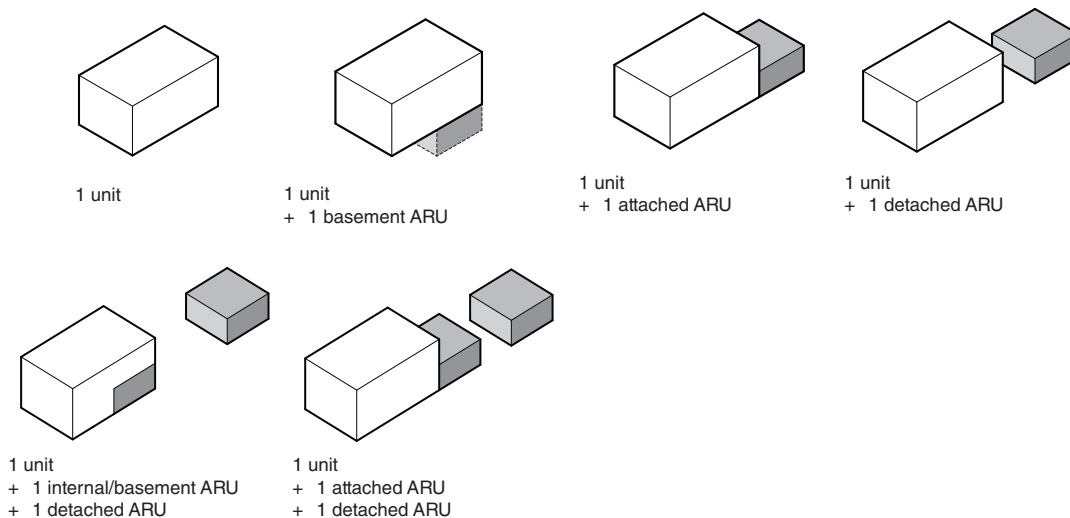

2.2.6. NL-5: Neighborhood Low Density-5 (P17-077)

A. Intent

1. General Intent: The intent of the Neighborhood Low Density-5 (NL-5) zone is to enhance the character and cohesiveness of residential neighborhoods while allowing for a flexible range of residential types, including single-family detached units, duplex units, and triplex units. A maximum of three detached or attached units per lot is permitted. This flexibility is intended to create opportunities for workforce housing because all apartment units are required to be rented to members of the local workforce. This zone is intended for Stable neighborhoods where increased residential density is not intended.
2. Buildings: Buildings can be up to 2 stories in height. Multiple detached buildings or multiple attached units on a site is common. Incentives are provided to encourage variety in roof pitch and design.
3. Parking: Parking is provided primarily on-site in garages or with surface spaces. Parking is typically accessed from an alley where present or a primary street where no alley exists.
4. Land Use: Single-family detached homes, duplex, and triplex units, with additional apartments as allowed to not exceed three units per lot maximum density.
5. Comprehensive Plan: Based primarily on Subarea 3.1 in the Comprehensive Plan.

B. Physical Development

Standards applicable to physical development are provided in this Section. Where a cross-reference is listed, see the referenced division or section for additional standards. Standards in Article 5 apply unless stated otherwise.

1. Lot Standards

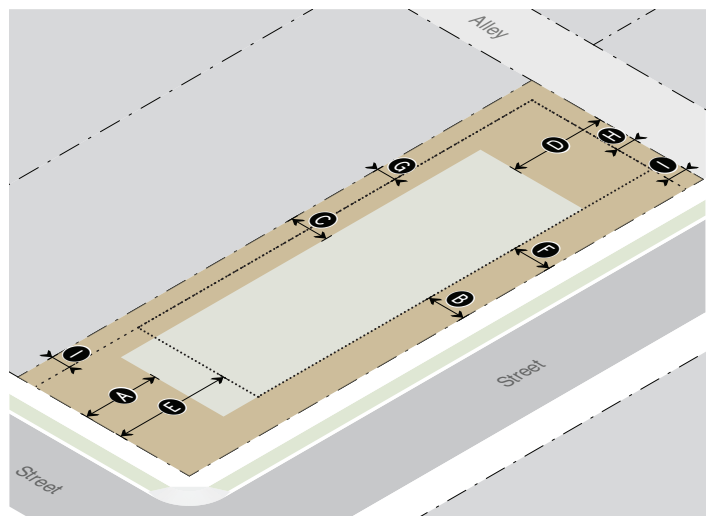

Primary Building Setbacks

(Sec. 9.4.8)

Primary street (min)	20'	A
Secondary street (min)	10'	B
Side interior (min)	10'	C
Rear (min)	10'	D

Accessory Structure Setbacks

(Sec. 9.4.8)

Primary street (min)	30'	E
Secondary street (min)	10'	F
Side interior (min)	5'	G
Rear (min)	5'	H

Site Development Setbacks

All site development, excluding driveways or parking.

Primary/secondary street (min)	Same as primary building	
Side interior/rear (min)	5'	I

Landscaping

(Div. 5.5)

Landscape surface ratio (min)

1 unit	.45
2 units	.35
3 units	.30
All other allowed uses	.45

Plant units (min)

Residential	1 per lot
Nonresidential	1 per 1,000 sf of landscape area
Parking Lot (all uses)	1 per 12 parking spaces

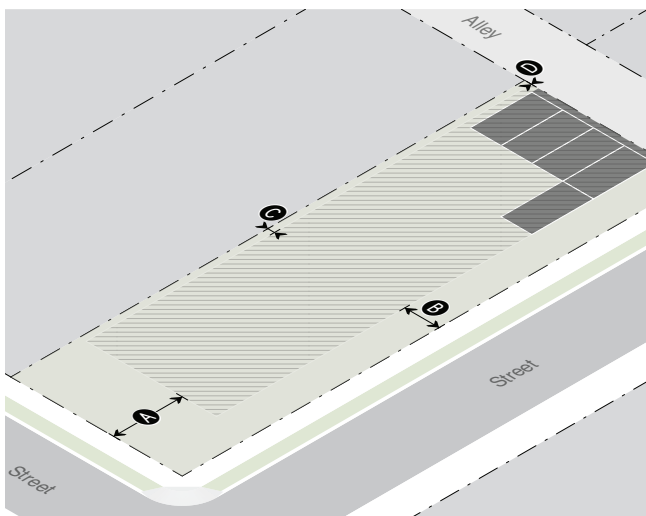
2. Vehicle Access Standards**Access**

Primary street	Allowed
Secondary street	Allowed
Alley	Allowed

Curb-cut width (max)	20' or 40% of lot frontage, whichever is less	A
----------------------	---	----------

Driveway width in primary/secondary street setback (max)	20'	B
--	-----	----------

Parking Setbacks

	1 or 2 units	3 units/nonresidential	
Primary street (min)	20'	20'*	A
Secondary street (min)	10'	10'*	B
Side interior (min)	5'	1'	C
Rear (min)	5'	5'	
Rear alley (min)	2'	2'	D

* Excludes 20' max driveway allowed in primary/secondary street setback

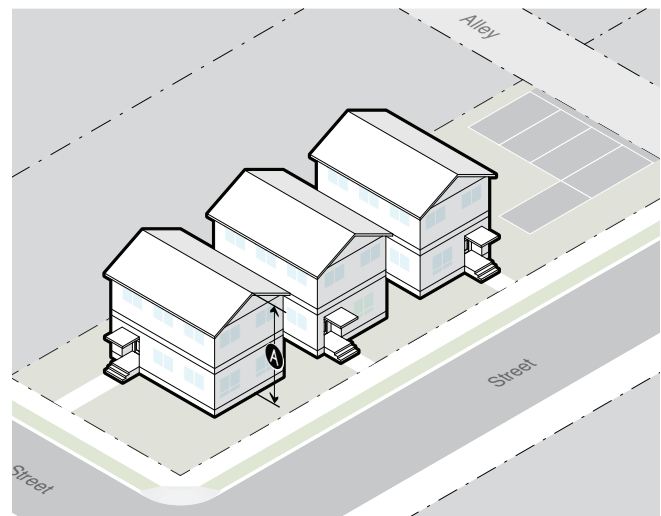
3. Bulk & Mass Standards**Design Guidelines**

Div. 5.8

The Design Guidelines apply to all residential and nonresidential development of three attached units or greater, except where exempted by Planning Director for additions of 20% or less that are consistent with existing architecture.

Primary Building Height

(Sec. 9.4.9)

Height: roof pitch $\leq 3/12$ (max)	2 stories, not to exceed 26'	A
--------------------------------------	------------------------------	----------

Height: roof pitch $4/12, 5/12$ (max)	2 stories, not to exceed 28'	A
---------------------------------------	------------------------------	----------

Height: roof pitch $\geq 6/12$ (max)	2 stories, not to exceed 30'	A
--------------------------------------	------------------------------	----------

Accessory Structure Height

(Sec. 9.4.9)

All other accessory structures (max)	14'
--------------------------------------	-----

Scale of Development

(Sec. 9.4.13)

Floor area ratio (FAR max)	
1 unit	.30
2 units	.35
3 units	.40
All other allowed uses	.40

Individual Building (max gross floor area)	10,000 sf
--	-----------

4. Fencing	
Height (max)	
In street yard	4'
In side or rear yard	6'
Setback (min)	
Primary or secondary street lot line/ R.O.W./sidewalk (min)	1'
Side or rear lot line	0'
Orientation	
The finished side of the fence shall face out to the neighbor, posts and supports shall face in to the owner	
5. Environmental Standards	
Natural Resource Setback (min)	(Sec. 5.1.1.)
Cache Creek South of Cache Creek Dr.	20'
Flat Creek North of Hansen Ave.	25'
Flat Creek South of Hansen Ave.	50'
Wetland	30'
Irrigation Ditch Setback (min)	(7.7.4.D.)
Irrigation Ditch	15'
Natural Resource Overlay (NRO) Standards	(Sec. 5.2.1.)
6. Scenic Standards	
Exterior Lighting	(Sec. 5.3.1.)
Light trespass prohibited	
All lights over 600 initial lumens shall be fully shielded	
Lumens per sf of site development (max)	3
Lumens per site (max)	
All fixtures	100,000
Unshielded fixtures	5,500
Light Color	≤3000 Kelvin
Scenic Resource Overlay (SRO) Standards	(Sec. 5.3.2.)
7. Natural Hazards to Avoid	
Steep Slopes	(Sec. 5.4.1.)
Development prohibited	Slopes > 25%
Hillside CUP required	Lot with average cross-slope ≥ 10%
Areas of Unstable Soils	(Sec. 5.4.2.)
Fault Area	(Sec. 5.4.3.)

Floodplains	(Sec. 5.4.4.)
Wildland Urban Interface	(Sec. 5.4.5.)
8. Signs	
(Div. 5.6.)	
Number of Signs (max)	3 per business per frontage
Home occupation/business	1 unlit wall sign
Background color	No white or yellow
Sign Area	
Total sign area (max)	3 sf per ft of street facade width up to 150 sf
Home occupation/business	2 sf
Penalty	10% per projecting and freestanding sign
Sign Type Standards	
Canopy sign	
Clearance (min)	7'6" from average grade
Setback (min)	18" from back of curb
Freestanding sign	
Height (max)	6'
Setback (min)	5'
Projecting sign	
Height (max)	24' above grade
Clearance (min)	7'6" from average grade
Setback (min)	18" from back of curb
Wall sign	
Window sign	
Window surface coverage (max)	25% up to 16 sf
Temporary Signs	(Sec. 5.6.1.)
9. Grading, Erosion Control, Stormwater	
Grading	(Sec. 5.7.2.)
Erosion Control	(Sec. 5.7.3.)
Erosion shall be controlled at all times	
Stormwater Management	(Sec. 5.7.4.)
No increase in peak flow rate or velocity across property lines	

10. Required Physical Development Permits						
Physical Development	Sketch Plan (Sec. 8.3.1.)	Development Plan (Sec. 8.3.2.)	Building Permit (Sec. 8.3.3.)	DRC Review (Sec. 8.2.6.)	Sign Permit (Sec. 8.3.5.)	Grading Permit (Sec. 8.3.4.)
Dwelling Unit						
< 5 units			X			(Sec. 5.7.1.)
5 - 10 units		X	X			(Sec. 5.7.1.)
> 10 units	X	X	X			(Sec. 5.7.1.)
Nonresidential Floor Area						
≤ 5,000 sf			X	X		(Sec. 5.7.1.)
5,001 - 15,000 sf		X	X	X		(Sec. 5.7.1.)
> 15,000 sf	X	X	X	X		(Sec. 5.7.1.)
Sign					X	(Sec. 5.7.1.)

C. Allowed Uses and Use Standards

Standards applicable to uses in the NL-5 zone are provided or referenced below. Allowed uses are listed in Subsection 1. Uses that are not listed are prohibited, unless a similar use determination is made pursuant to Section 6.1.2.D. Where a cross reference is provided, please see the referenced division or section for additional standards applicable in the NL-5 zone. This Subsection is intended to indicate all of the use standards applicable in the NL-5 zone, however, all standards in Article 6. are applicable in the NL-5 zone, unless stated otherwise.

1. Allowed Uses				2. Use Requirements	
Use	Permit	Density (max)	Individual Use (max)	Parking (min) (Div. 6.2.)	Employee Housing Floor Area (min) (Div. 6.3.)
Open Space					to be amended pending Housing Mitigation LDR Update
Agriculture (6.1.3.B.)	B	n/a		n/a	
Residential					
Detached Single-Family Unit (6.1.4.B.) (E.1)	Y	E.1	8,000 sf habitable-excluding basemen	2/DU	to be amended pending Housing Mitigation LDR Update
Apartment (6.1.4.D.) (E.2)	B	E.1		1/DU 0-1 bedrooms 500 sf max; otherwise 1.5/DU	
Dormitory (6.1.4.F.)	C	n/a		1/bed	
Group Home (6.1.4.G.)	C	n/a		0.5/bed	
Institutional					to be amended pending Housing Mitigation LDR Update
Assembly (6.1.8.B.)	C	n/a		independent calculation	
Transportation/Infrastructure					
Utility Facility (6.1.10.C.)	C	n/a		1/employee + 1/stored vehicle	to be amended pending Housing Mitigation LDR Update
Wireless Communications Facilities (6.1.10.D.)				1/employee + 1 per stored vehicle	
Minor	B	n/a			

Y=Use allowed, no use permit required, B=Basic Use Permit (Sec. 8.4.1.), C=Conditional Use Permit (Sec. 8.4.2.),

1. Allowed Uses			2. Use Requirements		
Use	Permit	Density (max)	Individual Use (max)	Parking (min) (Div. 6.2.)	Employee Housing Floor Area (min) (Div. 6.3.)
Accessory Uses					to be amended pending Housing Mitigation LDR Update
Home Occupation (6.1.11.D.)	B	n/a		n/a	
Home Business (6.1.11.E.)	C	n/a		1/employee	
Family Home Daycare (6.1.11.F.)	B	n/a		1/employee + 1 off-street pick-up/drop-off	
Home Daycare Center (6.1.11.G.)	C	n/a		1/employee + 2 off-street pick-up/drop-off	
Temporary Uses					
Temporary Shelter (6.1.12.D.)	B	1 unit per lot		2/DU	
Temp. Gravel Extraction and Processing (6.1.12.F.)	B	n/a		1/employee	

Y=Use allowed, no use permit required, B=Basic Use Permit (Sec. 8.4.1.), C=Conditional Use Permit (Sec. 8.4.2.),

3. Operational Standards	
Outdoor Storage	(Sec. 6.4.1.)
Refuse and Recycling	(Sec. 6.4.2.)
Trash & recycling enclosure required	> 4 DUs and all nonresidential
Noise	(Sec. 6.4.3.)
Sound level at property line (max)	65 DBA
Vibration	(Sec. 6.4.4.)
Electrical Disturbances	(Sec. 6.4.5.)
Fire and Explosive Hazards	(Sec. 6.4.6.)

D. Development Options and Subdivision

Standards applicable to development options and subdivision in the NL-5 zone are provided or referenced below. Where a cross reference is provided, please see the referenced division or section for additional standards applicable in the NL-5 zone. This Subsection is intended to indicate all of the development option and subdivision standards applicable in the NL-5 zone, however, all standards in Article 7. are applicable in the NL-5 zone, unless stated otherwise.

1. Allowed Subdivision and Development Options				
Option		Lot Size (min)	Option Standards	
Allowed Subdivision Options				
Land Division		7,500 sf	(Sec. 7.2.3.)	
2. Residential Subdivision Requirements				
Affordable Housing	to be amended pending Housing Mitigation LDR Update			
Required Affordable Housing				
Schools and Parks Exaction			(Div. 7.5.)	
Schools exaction				
Parks exaction				
3. Infrastructure				
Transportation Facilities			(Div. 7.6.)	
Access			required	
Right-of-way for Minor Local Road (min)			60'	
Paved travel way for Minor Local Road (min)			20'	
Required Utilities			(Div. 7.7.)	
Water			public	
Sewer			public	
4. Required Subdivision and Development Option Permits				
Option	Sketch Plan (Sec. 8.3.1.)	Development Plan (Sec. 8.3.2.)	Development Option Plan (Sec. 8.5.2.)	Subdivision Plat (Sec. 8.5.3.)
Land Division				
≤ 10 Lots		X		X
> 10 Lots	X	X		X

E. Additional Zone-specific Standards

The following standards apply in addition to all other standards applicable in the NL-5 zone.

1. **Single-Family Detached or Apartment.** No more than 3 units of any combination are permitted on the lot.
2. **Apartment**
 - a. Occupancy of an apartment shall be restricted to persons employed within Teton County, in accordance with the Jackson/Teton County Housing Rules and Regulations or the occupants shall be members of the same family occupying the principal dwelling unit, such as parents or adult children, or intermittent, nonpaying guests

F. Configuration Options

Configuration options in the NL-5 zone include, but are not limited to, the following:

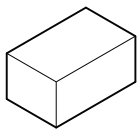

1 unit

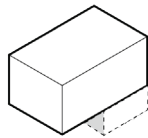

1 unit
+ 1 basement apartment

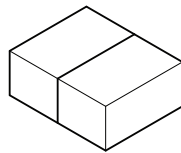

2 attached units (side by side)

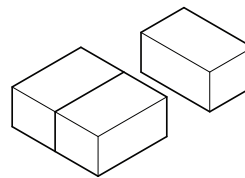

2 attached units (side by side)
+ 1 detached Unit

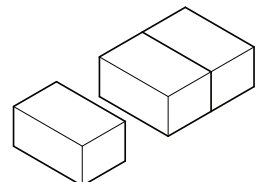

1 detached unit
+ 2 attached Units

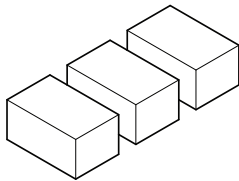

3 detached units

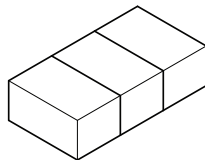

3 attached units

2.2.7. NM-1: Neighborhood Medium Density-1 (P17-077)

A. Intent

1. General Intent: The intent of the Neighborhood Medium Density 1 (NM-1) zone is to recognize existing residential neighborhood character while allowing flexibility in design and ownership for single-family detached, duplex homes, and Accessory Residential Units (ARUs) on smaller lots when feasible. This zone is intended for Stable neighborhoods where increased residential density is not intended.
2. Buildings: Buildings can be up to 2 stories in height. Multiple buildings on a site is common. Incentives are provided to encourage variety in roof pitch and design.
3. Parking: Parking is provided primarily on-site in garages or with surface spaces. Parking is typically accessed from a primary street or alley when present.
4. Land Use: Single-family detached and attached homes, accessory structures, and ARUs are the primary land uses. Lots are typically either 7,500 or 3,750 square feet but may also be any size within this range.
5. Comprehensive Plan: Based primarily on Subarea 3.2 in the Comprehensive Plan.

B. Physical Development

Standards applicable to physical development are provided in this Section. Where a cross-reference is listed, see the referenced division or section for additional standards. Standards in Article 5 apply unless stated otherwise.

1. Lot Standards

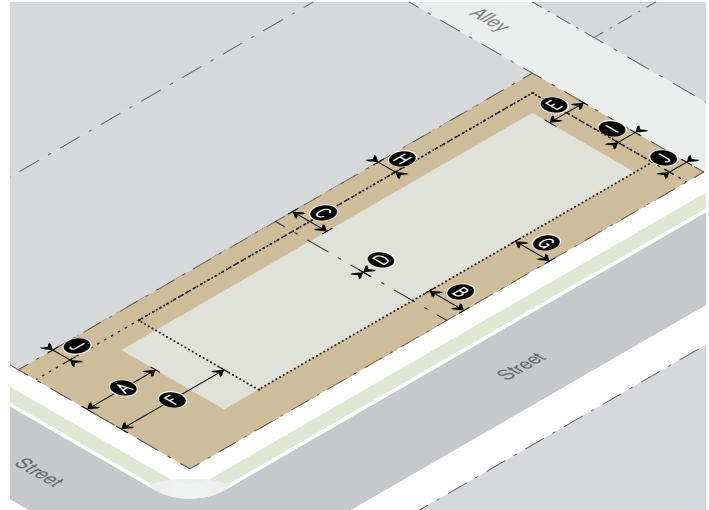

Primary Building Setbacks (Sec. 9.4.8)

Primary street (min)	20'	A
Secondary street (min)	10'	B
Side interior (min)	10'	C
Duplex interior (min)	0'	D
Rear (min)	10'	
Rear alley (min)	10'	E

Accessory Structure Setbacks (Sec. 9.4.8)

Primary street (min)	30'	F
Secondary street (min)	10'	G
Side interior/rear* (min)		H
>14 feet in height	10'	
≤14 feet in height	5'	
Second floor deck	10'	
Rear alley (min)	10'	I

Site Development Setbacks

All site development, excluding driveways or parking.

Primary/secondary street (min)	Same as primary building	
Side interior/rear (min)	5'	J

Landscaping (Div. 5.5)

	<7,500 sf	≥7,500 sf
Landscape surface ratio (min)		
Single-family detached	.50	.45
Single-family attached	.50	n/a
Apartment	n/a	.40
LSR decrease for each ARU	.10	.10
All other uses	.50	.45
Plant units (min)	1 per lot	

2. Vehicle Access Standards

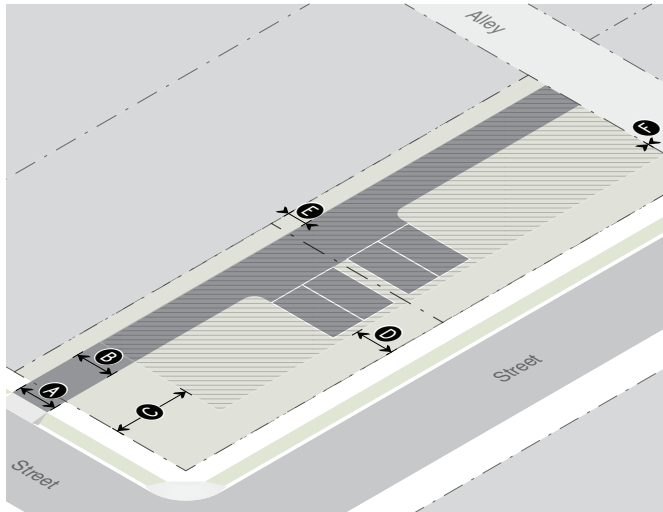

	SFD/SFA Lot width ≤25'	SFD/SFA Lot width >25'	All Other Uses
--	------------------------------	------------------------------	-------------------

Access			
Primary street	Allowed	Allowed	Allowed
Secondary street	Allowed	Allowed	Allowed
Alley	Required	Allowed	Allowed
Curb-cut width (max)	Not allowed	20' or 40% of lot frontage, whichever is less	20' or 40% of lot frontage, whichever is less A
Driveway width in primary/secondary street setback (max)	Not allowed	20'	20' B
Parking Setbacks			
Primary street (min)	20'*	20'*	20'* C
Secondary street (min)	10'	10'*	10'* D
Side interior (min)	5'	5'	5' E
Rear (min)	5'	5'	5' F
Rear alley (min)	2'	2'	2' F

* Excludes 20' max driveway allowed in primary/secondary street setback

3. Bulk & Mass Standards

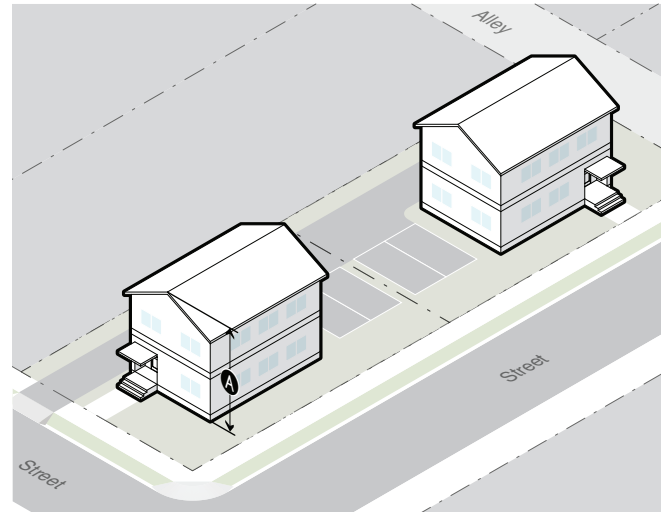

Design Guidelines

Div. 5.8

The Design Guidelines apply to all residential and nonresidential development of three attached units or greater, except where exempted by Planning Director for additions of 20% or less that are consistent with existing architecture.

Primary Building Height

(Sec. 9.4.9)

Height: roof pitch ≤ 3/12 (max)	2 stories, not to exceed 26' A
Height: roof pitch 4/12, 5/12 (max)	2 stories, not to exceed 28' A
Height: roof pitch ≥ 6/12 (max)	2 stories, not to exceed 30' A

Accessory Structure Height

(Sec. 9.4.9)

Accessory residential unit (max)	2 stories, not to exceed 26'
All other accessory structures (max)	14'

Scale of Development

(Sec. 9.4.13)

Floor area ratio (FAR max)	<7,500 sf	≥7,500 sf
Single-family detached	.40	.40
Single-family attached	.40	n/a
Apartment	n/a	.40
FAR increase for each ARU	.10	.05
All other uses	n/a	.40

4. Fencing	
Height (max)	
In street yard	4'
In side or rear yard	6'
Setback (min)	
Primary or secondary street lot line/R.O.W./sidewalk (min)	1'
Side or rear lot line	0'
Orientation	
The finished side of the fence shall face out to the neighbor, posts and supports shall face in to the owner	
5. Environmental Standards	
Natural Resource Setback (min)	(Sec. 5.1.1.)
Cache Creek (South of Cache Creek Drive)	20'
Flat Creek north of Hansen Ave.	25'
Flat Creek south of Hansen Ave.	50'
Wetland	30'
Irrigation Ditch Setback (min)	(7.7.4.D.)
Irrigation Ditch	15'
Natural Resource Overlay (NRO) Standards	(Sec. 5.2.1.)
6. Scenic Standards	
Exterior Lighting	(Sec. 5.3.1.)
Light trespass prohibited	
All lights over 600 initial lumens shall be fully shielded	
Lumens per sf of site development (max)	1.5
Lumens per site (max)	
All fixtures	60,000'
Unshielded fixtures	4,000
Light Color	≤3000 Kelvin
Scenic Resource Overlay (SRO) Standards	(Sec. 5.3.2.)
7. Natural Hazards to Avoid	
Steep Slopes	(Sec. 5.4.1.)
Development prohibited	Slopes > 25%
Hillside CUP required	Lot with average cross-slope ≥ 10%
Areas of Unstable Soils	(Sec. 5.4.2.)

Fault Area	(Sec. 5.4.3.)
Floodplains	(Sec. 5.4.4.)
Wildland Urban Interface	(Sec. 5.4.5.)
8. Signs	(Div. 5.6.)
Home occupation/business	1 unlit wall sign
Area (max)	2 sf
Background color	No white or yellow
Temporary Signs	(Sec. 5.6.1.)
9. Grading, Erosion Control, Stormwater	
Grading	(Sec. 5.7.2.)
Erosion Control	(Sec. 5.7.3.)
Erosion shall be controlled at all times	
Stormwater Management	(Sec. 5.7.4.)
No increase in peak flow rate or velocity across property lines	

10. Required Physical Development Permits						
Physical Development	Sketch Plan (Sec. 8.3.1.)	Development Plan (Sec. 8.3.2.)	Building Permit (Sec. 8.3.3.)	DRC Review (Sec. 8.2.6.)	Sign Permit (Sec. 8.3.5.)	Grading Permit (Sec. 8.3.4.)
Dwelling Unit						
< 5 units			X			(Sec. 5.7.1.)
5 - 10 units		X	X			(Sec. 5.7.1.)
> 10 units	X	X	X			(Sec. 5.7.1.)
Sign					X	(Sec. 5.7.1.)

C. Allowed Uses and Use Standards

Standards applicable to uses in the NM-1 zone are provided or referenced below. Allowed uses are listed in Subsection 1. Uses that are not listed are prohibited, unless a similar use determination is made pursuant to 6.1.2.D. Where a cross reference is provided, please see the referenced division or section for additional standards applicable in the NM-1 zone. This Subsection is intended to indicate all of the use standards applicable in the NM-1 zone, however, all standards in Article 6. are applicable in the NM-1 zone, unless stated otherwise.

1. Allowed Uses			2. Use Requirements		
Use	Permit	Density (max)	Individual Use (max)	Parking (min) (Div. 6.2.)	Employee Housing Floor Area (min) (Div. 6.3.)
Open Space					
Agriculture (6.1.3.B.)	B	n/a		n/a	to be amended pending Housing Mitigation LDR Update
Residential					
Detached Single-Family Unit (6.1.4.B.)	Y	2 units per lot	8,000 sf habitable- excluding basement	2/DU	to be amended pending Housing Mitigation LDR Update
Attached Single-Family Unit (6.1.4.C.)	B	1 unit per lot		1/DU 0-1 bedrooms 500 sf max; otherwise 1.5/DU	
Apartment (6.1.4.D.) (E.1)	B	2 units per lot			
Dormitory (6.1.4.F.)	C	n/a		1/bed	
Group Home (6.1.4.G.)	C	n/a		0.5/bed	
Transportation/Infrastructure					
Utility Facility (6.1.10.C.)	C	n/a		1/employee + 1/stored vehicle	to be amended pending Housing Mitigation LDR Update
Wireless Communications Facilities (6.1.10.D.)					
Minor	B	n/a		1/employee + 1 per stored vehicle	

Y=Use allowed, no use permit required, B=Basic Use Permit (Sec. 8.4.1.), C=Conditional Use Permit (Sec. 8.4.2.)

1. Allowed Uses			2. Use Requirements		
Use	Permit	Density (max)	Individual Use (max)	Parking (min) (Div. 6.2.)	Employee Housing Floor Area (min) (Div. 6.3.)
Accessory Uses					
Accessory Residential Unit (6.1.11.B.) (E.2)	B	1 per unit	Detached ARU on lot <11,250 sf: 500 sf habitable All other ARUs: 800 sf habitable	1/DU 0-1 bedrooms 500 sf max; otherwise 1.5/DU	to be amended pending Housing Mitigation LDR Update
Home Occupation (6.1.11.D.)	B	n/a		n/a	
Home Business (6.1.11.E.)	C	n/a		1/employee	
Family Home Daycare (6.1.11.F.)	B	n/a		1/employee + 1 off-street pick-up/drop-off	
Temporary Uses					
Temporary Shelter (6.1.12.D.)	B	1 unit per lot		2/DU	to be amended pending Housing Mitigation LDR Update
Temp. Gravel Extraction and Processing (6.1.12.F.)	B	n/a		1/employee	

Y=Use allowed, no use permit required, B=Basic Use Permit (Sec. 8.4.1.), C=Conditional Use Permit (Sec. 8.4.2.)

3. Operational Standards	
Outdoor Storage	(Sec. 6.4.1.)
Refuse and Recycling	(Sec. 6.4.2.)
Trash & recycling enclosure required	> 4 DUs and all nonresidential
Noise	(Sec. 6.4.3.)
Sound level at property line (max)	65 DBA
Vibration	(Sec. 6.4.4.)
Electrical Disturbances	(Sec. 6.4.5.)
Fire and Explosive Hazards	(Sec. 6.4.6.)

D. Development Options and Subdivision

Standards applicable to development options and subdivision in the NM-1 zone are provided or referenced below. Where a cross reference is provided, please see the referenced division or section for additional standards applicable in the NM-1 zone. This Subsection is intended to indicate all of the development option and subdivision standards applicable in the NM-1 zone, however, all standards in Article 7. are applicable in the NM-1 zone, unless stated otherwise.

1. Development Options and Subdivision				
Option			Lot Size (min)	Option Standards
Allowed Subdivision Options				
Land Division			3,750 sf	(Sec. 7.2.3.)
2. Residential Subdivision Requirements				
Affordable Housing			to be amended pending Housing Mitigation LDR Update	
Required Affordable Housing				
Schools and Parks Exaction			(Div. 7.5.)	
Schools exaction				
Parks exaction				
3. Infrastructure				
Transportation Facilities			(Div. 7.6.)	
Access			required	
Right-of-way for Minor Local Road (min)			60'	
Paved travel way for Minor Local Road (min)			20'	
Required Utilities			(Div. 7.7.)	
Water			public	
Sewer			public	
4. Required Subdivision and Development Option Permits				
Option	Sketch Plan (Sec. 8.3.1.)	Development Plan (Sec. 8.3.2.)	Development Option Plan (Sec. 8.5.2.)	Subdivision Plat (Sec. 8.5.3.)
Land Division				
≤ 10 Lots		X		X
> 10 Lots	X	X		X

E. Additional Zone-specific Standards

The following standards apply in addition to all other standards applicable in the NM-1 zone.

1. Maximum Allowed Density

- a. The maximum allowed density on an individual lot of 7,500 sf or greater in size is four units (two primary units and two ARUs), except that a building with two Single-Family attached units (i.e. duplex) is only allowed to have ARUs if the lot is served by either two street frontages or by a street and an alley. The two primary units may either be detached (i.e., two Detached Single-Family homes) or attached (i.e., Apartments attached in the form of a duplex).
- b. The maximum allowed density on an individual lot smaller than 7,500 sf in size is two units (one Detached Single-Family home and one ARU).

2. Accessory Residential Units (ARUs)

- a. Home Occupations and Home Businesses in ARUs are prohibited.
- b. Detached ARUs shall only be permitted on lots that meet minimum lot size.

F. Configuration Options

Configuration options in the NM-1 zone include, but are not limited to, the following:

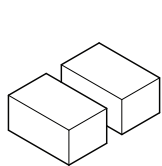

2 detached units

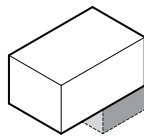

1 unit
+ 1 basement ARU

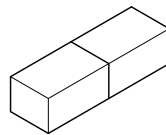

2 attached units
(back to back)

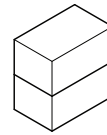

2 attached units
(up and down)

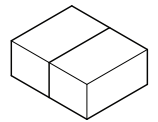

2 attached units
(Side by side)

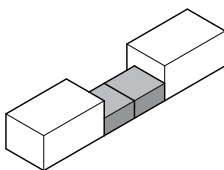

2 detached units
+ 2 attached ARUs

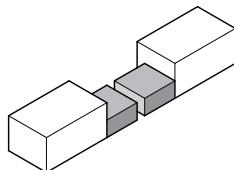

2 detached units
+ 2 detached attached ARUs

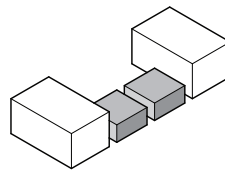

2 detached units
+ 2 detached ARUs

2.2.8. NM-2: Neighborhood Medium Density-2 (P17-077)

A. Intent

1. General Intent: The intent of the Neighborhood Medium Density-2 (NM-2) zone is to provide for medium to higher density residential development and to promote workforce housing types using a broad range of detached and attached residential types in a pedestrian-oriented environment. The size of individual buildings will be limited in order to respect and enhance the character and cohesiveness of existing residential neighborhoods. This zone is intended for Transitional neighborhoods where increased residential density and workforce housing are intended.
2. Buildings: Buildings can be up to 3 stories in height. Multiple detached buildings or multiple attached units on a site is common. No more than 8 units will be permitted within an individual building. Incentives are provided to encourage variety in roof pitch and design.
3. Parking: Parking is provided primarily on-site in garages or with surface spaces. Parking is typically accessed from a primary street or alley if present.
4. Land Use: The full spectrum from a single-family detached home to an 8-unit apartment/condo building is allowed.
5. Comprehensive Plan: Based primarily on Subarea 3.2 in the Comprehensive Plan

B. Physical Development

Standards applicable to physical development are provided in this Section. Where a cross-reference is listed, see the referenced division or section for additional standards. Standards in Article 5 apply unless stated otherwise.

1. Lot Standards

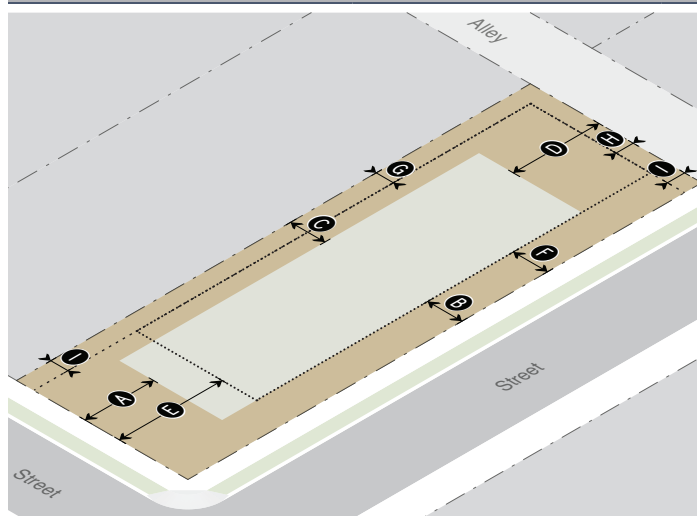

Primary Building Setbacks (Sec. 9.4.8)

Primary street (min)	20'	A
Secondary street (min)	10'	B
Side interior (min)	10'	C
Rear (min)	20'	D

Accessory Structure Setbacks (Sec. 9.4.8)

Primary street (min)	30'	E
Secondary street (min)	10'	F
Side interior (min)	5'	G
Rear (min)	5'	
Rear alley (min)	10'	H

Site Development Setbacks

All site development, excluding driveways or parking.

Primary/secondary street (min)	Same as primary building	
Side interior/rear (min)	5'	I

Landscaping (Div. 5.5)

Landscape surface ratio (min)	(9.4.6.D.2)
Single-Family Detached	.45
Apartments/ Single-Family Attached	.21 & 70% in front 1/3 of lot
All other allowed uses	.35
Plant units (min)	
Single-Family and Duplex	1 per unit
All other uses	1/1,000 sf of landscape area
Parking Lot (all uses)	1 per 12 parking spaces

2. Vehicle Access Standards

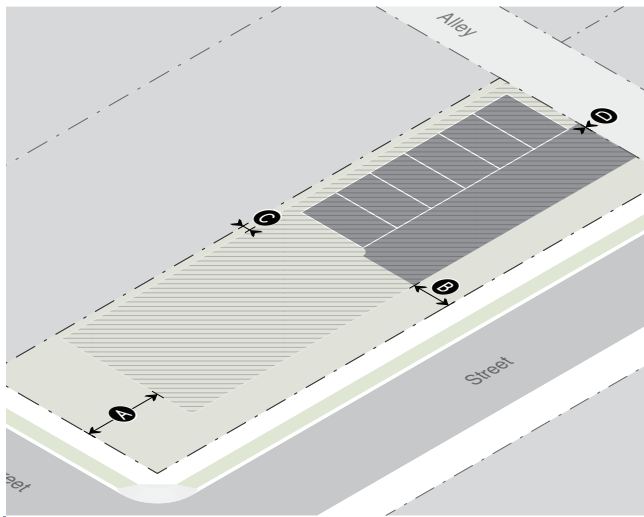

Access

Primary street	Allowed
Secondary street	Allowed
Alley	Allowed
Curb-cut width (max)	20' or 40% of lot frontage, whichever is less
Driveway width in primary/secondary street setback (max)	20'

Parking Setbacks

Primary street* (min)	20'	A
Secondary street* (min)	20'	B
Side interior (min)	1'	C
Rear (min)	5'	
Rear alley (min)	0'	D

* Excludes 20' max driveway allowed in primary/secondary street setback

3. Bulk & Mass Standards

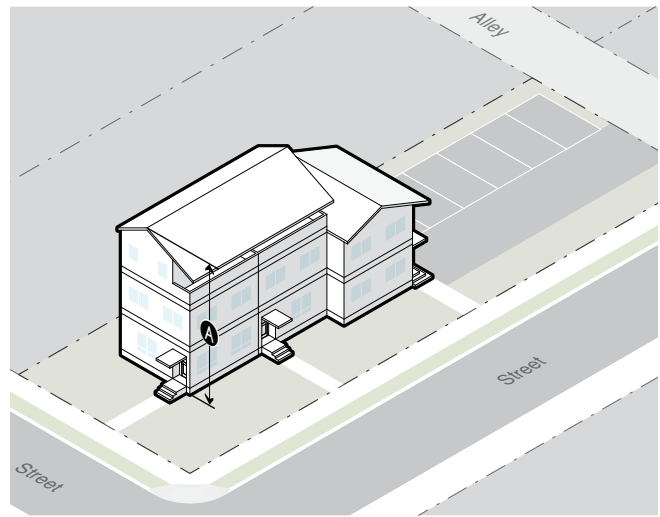

Primary Building Height

(Sec. 9.4.9)

Height: roof pitch $\leq 3/12$ (max)	3 stories, not to exceed 35'	A
Height: roof pitch $4/12, 5/12$ (max)	3 stories, not to exceed 37'	A
Height: roof pitch $\geq 6/12$ (max)	3 stories, not to exceed 39'	A

Accessory Structure Height

Sec. 9.4.9

All accessory structures (max)	14'
--------------------------------	-----

Scale of Development

Sec. 9.4.13

Floor area ratio (FAR max)

Single-Family Detached	.30
All other allowed uses	.40
Deed restricted housing exemption	Sec. 7.8.3.
Workforce housing floor area bonus	Sec. 7.8.4.

Individual building (max gross floor area)	10,000 sf
--	-----------

4. Fencing	
Height (max)	
In street yard	4'
In side or rear yard	6'
Setback (min)	
Primary or secondary street lot line/R.O.W./sidewalk (min)	1'
Side or rear lot line	0'
Orientation	
The finished side of the fence shall face out to the neighbor, posts and supports shall face in to the owner	
5. Environmental Standards	
Natural Resource Setback (min) (Sec. 5.1.1.)	
Cache Creek South of Cache Creek Dr.	20'
Flat Creek North of Hansen Ave.	25'
Flat Creek South of Hansen Ave.	50'
Wetland	30'
Irrigation Ditch Setback (min) (7.7.4.D.)	
Irrigation Ditch	15'
Natural Resource Overlay (NRO) Standards (Sec. 5.2.1.)	
6. Scenic Standards	
Exterior Lighting (Sec. 5.3.1.)	
Light trespass prohibited	
All lights over 600 initial lumens shall be fully shielded	
Lumens per sf of site development (max)	3
Lumens per site (max)	
All fixtures	100,000
Unshielded fixtures	5,500
Light Color	≤3000 Kelvin
Scenic Resource Overlay (SRO) Standards (Sec. 5.3.2.)	
7. Natural Hazards to Avoid	
Steep Slopes (Sec. 5.4.1.)	
Development prohibited	Slopes > 25%
Hillside CUP required	Lot with average cross-slope ≥ 10%
Areas of Unstable Soils (Sec. 5.4.2.)	
Fault Area (Sec. 5.4.3.)	
Floodplains (Sec. 5.4.4.)	

Wildland Urban Interface (Sec. 5.4.5.)	
8. Signs (Div. 5.6.)	
Number of Signs (max)	3 per business per frontage
Home occupation/business	1 unlit wall sign
Background Color	No white or yellow
Sign Area	
Total sign area (max)	3 sf per ft of street facade width up to 150 sf
Home occupation/business	2 sf
Penalty	10% per projecting and freestanding sign
Sign Type Standards	
Canopy sign	
Clearance (min)	7'6" from average grade
Setback (min)	18" from back of curb
Freestanding sign	
Height (max)	6'
Setback (min)	5'
Projecting sign	
Height (max)	24' above grade
Clearance (min)	7'6" from average grade
Setback (min)	18" from back of curb
Wall sign	
Window sign	
Window surface coverage (max)	25% up to 16 sf
Temporary Signs	(Sec. 5.6.1.)
9. Grading, Erosion Control, Stormwater	
Grading (Sec. 5.7.2.)	
Erosion Control (Sec. 5.7.3.)	
Erosion shall be controlled at all times	
Stormwater Management (Sec. 5.7.4.)	
No increase in peak flow rate or velocity across property lines	

10. Required Physical Development Permits						
Physical Development	Sketch Plan (Sec. 8.3.1.)	Development Plan (Sec. 8.3.2.)	Building Permit (Sec. 8.3.3.)	DRC Review (Sec. 8.2.6.)	Sign Permit (Sec. 8.3.5.)	Grading Permit (Sec. 8.3.4.)
Site area						
≤ 15,000 sf			X			(Sec. 5.7.1.)
15,001 - 30,000 sf		X	X			(Sec. 5.7.1.)
> 30,000 sf	X	X	X			(Sec. 5.7.1.)
Sign					X	(Sec. 5.7.1.)

C. Use Standards

Standards applicable to uses in the NM-2 zone are provided or referenced below. Allowed uses are listed in Subsection 1. Uses that are not listed are prohibited, unless a similar use determination is made pursuant to 6.1.2.D. Where a cross reference is provided, please see the referenced division or section for additional standards applicable in the NM-2 zone. This Subsection is intended to indicate all of the use standards applicable in the NM-2 zone, however, all standards in Article 6. are applicable in the NM-2 zone, unless stated otherwise.

1. Allowed Uses				2. Use Requirements	
Use	Permit	Density (max)	Individual Use (max)	Parking (min) (Div. 6.2.)	Employee Housing Floor Area per 1,000 sf (min) (Div. 6.3.)
Residential					to be amended pending Housing Mitigation LDR Update
Detached Single-Family Unit (6.1.4.B.)	Y	1 unit per lot	8,000 sf habitable-excluding basement	2/DU	
Attached Single-Family unit (6.1.4.C.) (E.1)	B	E.1		1/DU 0-1 bedrooms 500 sf max; otherwise 1.5/DU	
Apartment (6.1.4.D.) (E.1)	B	E.1			
Dormitory (6.1.4.F.)	C	n/a		1/bed	
Group Home (6.1.4.G.)	C	n/a		0.5/bed	
Institutional					to be amended pending Housing Mitigation LDR Update
Assembly (6.1.8.B.)	C	n/a		independent calculation	
Transportation/Infrastructure					to be amended pending Housing Mitigation LDR Update
Utility Facility (6.1.10.C.)	C	n/a		1/employee + 1/stored vehicle	
Wireless Communications Facilities (6.1.10.D.)				1/employee + 1 per stored vehicle	
Minor	B	n/a			
Accessory Uses					to be amended pending Housing Mitigation LDR Update
Home Occupation (6.1.11.D.)	B	n/a		n/a	
Home Business (6.1.11.E.)	C	n/a		1/employee	
Family Home Daycare (6.1.11.F.)	B	n/a		1/employee + 1 off-street pick-up/drop-off	

Y=Use allowed, no use permit required, B=Basic Use Permit (Sec. 8.4.1.), C=Conditional Use Permit (Sec. 8.4.2.)

1. Allowed Uses			2. Use Requirements		
Use	Permit	Density (max)	Individual Use (max)	Parking (min) (Div. 6.2.)	Employee Housing Floor Area per 1,000 sf (min) (Div. 6.3.)
Home Daycare Center (6.1.11.G.)	C	n/a		1/employee + 2 off-street pick-up/drop-off	to be amended pending Housing Mitigation LDR Update
Temporary Uses					
Temporary Shelter (6.1.12.D.)	B	1 unit per lot		2/DU	
Temp. Gravel Extraction and Processing (6.1.12.F.)	B	n/a		1/employee	

Y=Use allowed, no use permit required, B=Basic Use Permit (Sec. 8.4.1.), C=Conditional Use Permit (Sec. 8.4.2.)

3. Operational Standards	
Outdoor Storage	(Sec. 6.4.1.)
Refuse and Recycling	(Sec. 6.4.2.)
Trash & recycling enclosure required	> 4 DUs and all nonresidential
Noise	(Sec. 6.4.3.)
Sound level at property line (max)	65 DBA
Vibration	(Sec. 6.4.4.)
Electrical Disturbances	(Sec. 6.4.5.)
Fire and Explosive Hazards	(Sec. 6.4.6.)

D. Development Options

Standards applicable to development options and subdivision in the NM-2 zone are provided or referenced below. Where a cross reference is provided, please see the referenced division or section for additional standards applicable in the NM-2 zone. This subsection is intended to indicate all of the development option and subdivision standards applicable in the NM-2 zone, however, all standards in Article 7. are applicable in the NM-2 zone, unless stated otherwise.

1. Allowed Subdivision and Development Options				
Option	Lot Size (min)	Option Standards		
Allowed Subdivision Options				
Land Division	7,500 sf	(Sec. 7.2.3.)		
Condominium/Townhouse	n/a	(Sec. 7.2.4.)		
2. Residential Subdivision Requirements				
Affordable Housing		to be amended pending Housing Mitigation LDR Update		
Required Affordable Housing				
Schools and Parks Exaction		(Div. 7.5.)		
Schools exaction				
Parks exaction				
3. Infrastructure				
Transportation Facilities		(Div. 7.6.)		
Access		required		
Right-of-way for Minor Local Road (min)		60'		
Paved travel way for Minor Local Road (min)		20'		
Required Utilities		(Div. 7.7.)		
Water		public		
Sewer		public		
4. Required Subdivision and Development Option Permits				
Option	Sketch Plan (Sec. 8.3.1.)	Development Plan (Sec. 8.3.2.)	Development Option Plan (Sec. 8.5.2.)	Subdivision Plat (Sec. 8.5.3.)
Land Division				
≤ 10 Lots		X		X
> 10 Lots	X	X		X
Condominium/Townhouse				X

E. Additional Zone-specific Standards

The following standards apply in addition to all other standards applicable in the NM-2 zone.

1. **Attached Single-Family Unit/Apartment.** No more than 8 units are allowed per building.

F. Configuration Options

Configuration options in the NM-2 zone include, but are not limited to, the following:

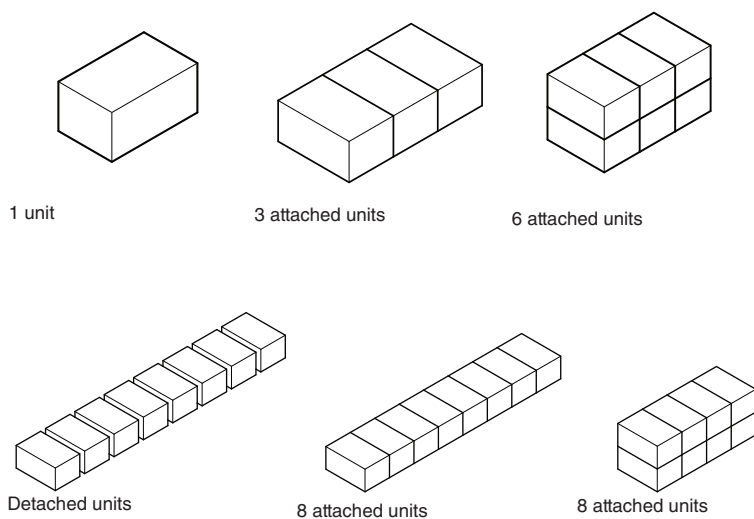

2.2.9. NH-1: Neighborhood High Density 1 (P17-077)

A. Intent

1. **General Intent:** The intent of the Neighborhood High Density 1 (NH-1) zone is to provide for high density residential development and to promote workforce housing types using a broad range of attached residential types in a pedestrian-oriented environment. The size of individual buildings will be limited by the application of required dimensional standards, such as FAR, setbacks, and parking, and not by a prescribed standard. Care will be given to ensure that new development respects and enhances the character and cohesiveness of existing residential neighborhoods. This zone is intended for Transitional neighborhoods where increased residential density and workforce housing are intended.
2. **Buildings:** Buildings can be up to 3 stories in height. Single or multiple detached buildings, each building with multiple units, on a site is common. Incentives are provided to encourage variety in roof pitch and design.
3. **Parking:** Parking is provided primarily on-site in surface or underground garages or with surface parking. Parking is typically accessed from a primary street or alley if present.
4. **Land Use:** The full spectrum from a Single-family home to whatever size building can fit the site based on the minimum required density (17.4 units/acre) and the dimensional limitations, such as FAR, setbacks, and parking. Apartments take the place of ARUs because they provide greater flexibility.
5. **Comprehensive Plan:** Based primarily on Subarea 3.2 in the Comprehensive Plan.

B. Physical Development

Standards applicable to physical development are provided in this Section. Where a cross-reference is listed, see the referenced division or section for additional standards. Standards in Article 5 apply unless stated otherwise.

1. Lot Standards

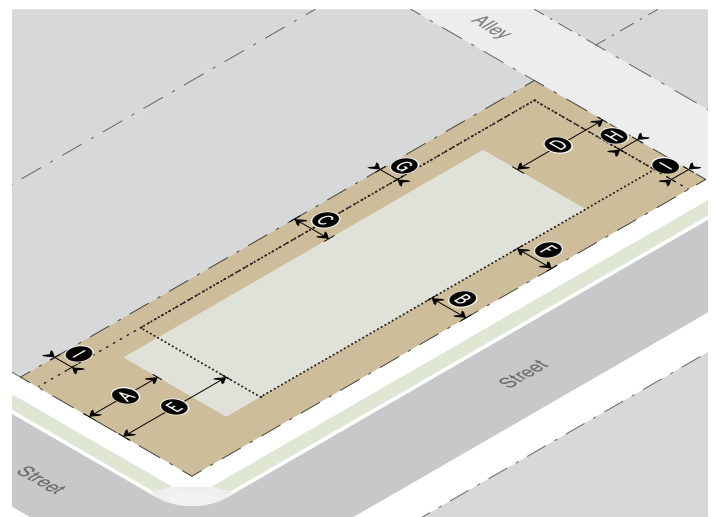

Primary Building Setbacks

(Sec. 9.4.8)

Primary street (min)	20'	A
Secondary street (min)	10'	B
Side interior (min)	10'	C
Rear (min)	20'	D

Accessory Structure Setbacks

(Sec. 9.4.8)

Primary street (min)	30'	E
Secondary street (min)	10'	F
Side interior/rear (min)	5'	G
Rear alley (min)	10'	H

Site Development Setbacks

All site development, excluding driveways or parking.

Primary/secondary street (min)	Same as primary building	
Side interior/rear (min)	5'	I

Landscaping

(Div. 5.5)

Landscape surface ratio (min)	(9.4.6.D.2)	
Apartment/ Single-Family Attached	.21 & 70% in front 1/3 of lot	
All other allowed uses	.30	
Plant units (min)		
Single-Family and Duplex	1 per unit	
All other uses	1/1,000 sf of landscape area	
Parking Lot (all uses)	1 per 12 parking spaces	

2. Vehicle Access Standards

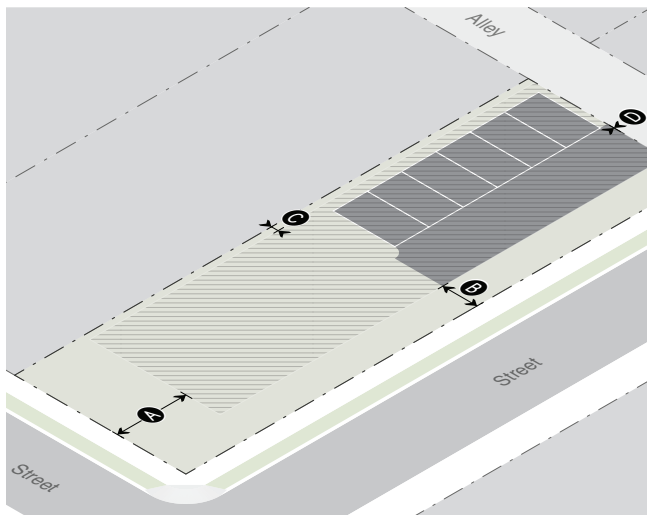

Access

Primary street	Allowed
Secondary street	Allowed
Alley	Allowed

Curb-cut width (max)	20' or 40% of lot frontage, whichever is less
----------------------	---

Driveway width in primary/secondary street setback (max)	20'
--	-----

Driveway Setbacks

Primary street* (min)	20'	A
Secondary street* (min)	10'	B
Side interior (min)	1'	C
Rear (min)	5'	
Rear alley (min)	0'	D

* Excludes 20' max driveway allowed in primary/secondary street setback

3. Bulk & Mass Standards

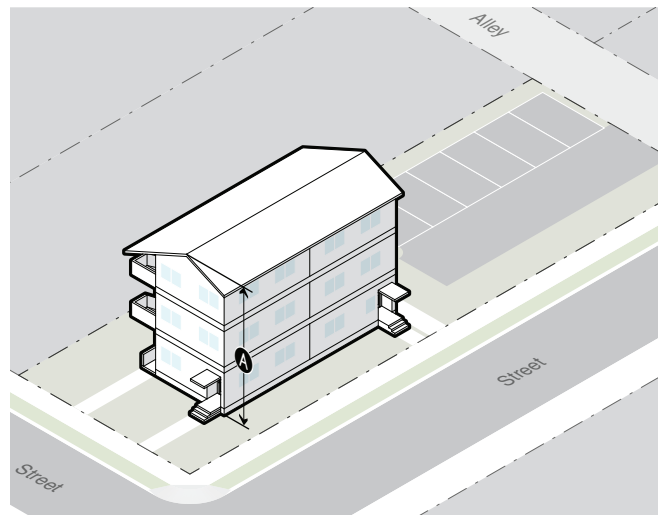

Design Guidelines

Div. 5.8

The Design Guidelines apply to all residential and nonresidential development of three attached units or greater, except where exempted by Planning Director for additions of 20% or less that are consistent with existing architecture.

Primary Building Height (Sec. 9.4.9)

Height: roof pitch $\leq 3/12$ (max)	3 stories, not to exceed 35'	A
Height: roof pitch $4/12, 5/12$ (max)	3 stories, not to exceed 37'	A
Height: roof pitch $\geq 6/12$ (max)	3 stories, not to exceed 39'	A

Accessory Structure Height (Sec. 9.4.9)

All accessory structures (max)	14'
--------------------------------	-----

Scale of Development (Sec. 9.4.13)

Floor area ratio (FAR max)	.40
Deed restricted housing exemption	Sec. 7.8.3.
Workforce housing floor area bonus	Sec. 7.8.4.
Individual Building (max gross floor area)	10,000 sf

4. Fencing	
Height (max)	
In street yard	4'
In side or rear yard	6'
Setback (min)	
Primary or secondary street lot line/R.O.W./sidewalk (min)	1'
Side or rear lot line	0'
Orientation	
The finished side of the fence shall face out to the neighbor, posts and supports shall face in to the owner	
5. Environmental Standards	
Natural Resource Setback (min)	(Sec. 5.1.1.)
Cache Creek South of Cache Creek Dr.	20'
Flat Creek North of Hansen Ave.	25'
Flat Creek South of Hansen Ave.	50'
Wetland	30'
Irrigation Ditch Setback (min)	(7.7.4.D.)
Irrigation Ditch	15'
Natural Resource Overlay (NRO) Standards	(Sec. 5.2.1.)
6. Scenic Standards	
Exterior Lighting	(Sec. 5.3.1.)
Light trespass prohibited	
All lights over 600 initial lumens shall be fully shielded	
Lumens per sf of site development (max)	3
Lumens per site (max)	
All fixtures	100,000
Unshielded fixtures	5,500
Light Color	≤3000 Kelvin
Scenic Resource Overlay (SRO) Standards	(Sec. 5.3.2.)
7. Natural Hazards to Avoid	
Steep Slopes	(Sec. 5.4.1.)
Development prohibited	Slopes > 25%
Hillside CUP required	Lot with average cross-slope ≥ 10%
Areas of Unstable Soils	(Sec. 5.4.2.)
Fault Area	(Sec. 5.4.3.)
Floodplains	(Sec. 5.4.4.)

Wildland Urban Interface		(Sec. 5.4.5.)
8. Signs		(Div. 5.6.)
Number of Signs (max)	3 per business per frontage	
Home occupation/business	1 unlit wall sign	
Background Color	No white or yellow	
Sign Area		
Total sign area (max)	3 sf per ft of street facade width up to 150 sf	
Home occupation/business	2 sf	
Penalty	10% per projecting and freestanding sign	
Sign Type Standards		
Canopy sign		
Clearance (min)	7'6" from average grade	
Setback (min)	18" from back of curb	
Freestanding sign		
Height (max)	6'	
Setback (min)	5'	
Projecting sign		
Height (max)	24' above grade	
Clearance (min)	7'6" from average grade	
Setback (min)	18" from back of curb	
Wall sign		
Window sign		
Window surface coverage (max)	25% up to 16 sf	
Temporary Signs	(Sec. 5.6.1.)	
9. Grading, Erosion Control, Stormwater		
Grading	(Sec. 5.7.2.)	
Erosion Control	(Sec. 5.7.3.)	
Erosion shall be controlled at all times		
Stormwater Management		(Sec. 5.7.4.)
No increase in peak flow rate or velocity across property lines		

10. Required Physical Development Permits						
Physical Development	Sketch Plan (Sec. 8.3.1.)	Development Plan (Sec. 8.3.2.)	Building Permit (Sec. 8.3.3.)	DRC Review (Sec. 8.2.6.)	Sign Permit (Sec. 8.3.5.)	Grading Permit (Sec. 8.3.4.)
Site area						
≤ 15,000 sf			X			(Sec. 5.7.1.)
15,001 - 30,000 sf		X	X			(Sec. 5.7.1.)
> 30,000 sf	X	X	X			(Sec. 5.7.1.)
Sign					X	(Sec. 5.7.1.)

C. Use Standards

Standards applicable to uses in the NH-1 zone are provided or referenced below. Allowed uses are listed in Subsection 1. Uses that are not listed are prohibited, unless a similar use determination is made pursuant to 6.1.2.D. Where a cross reference is provided, please see the referenced division or section for additional standards applicable in the NH-1 zone. This subsection is intended to indicate all of the use standards applicable in the NH-1 zone, however, all standards in Article 6. are applicable in the NH-1 zone, unless stated otherwise.

1. Allowed Uses				2. Use Requirements	
Use	Permit	Density	Individual Use (max)	Parking (min) (Div. 6.2.)	Employee Housing Floor Area per 1,000 sf (min) (Div. 6.3.)
Residential					
Detached Single-Family unit	B	E.1	8,000 sf habitable-excluding basement	1/DU 0-1 bedrooms 500 sf max; otherwise 1.5/DU	to be amended pending Housing Mitigation LDR Update
Attached Single-Family unit (6.1.4.C.) (E.1)	B	E.1			
Apartment (6.1.4.D.) (E.2)	B	E.1			
Dormitory (6.1.4.F.)	C	n/a		1/bed	to be amended pending Housing Mitigation LDR Update
Group Home (6.1.4.G.)	C	n/a		0.5/bed	
Institutional					
Assembly (6.1.8.B.)	C	n/a		independent calculation	
Transportation/Infrastructure					
Utility Facility (6.1.10.C.)	C	n/a		1/employee + 1/stored vehicle	to be amended pending Housing Mitigation LDR Update
Wireless Communications Facilities (6.1.10.D.)				1/employee +	
Minor	B	n/a		1 per stored vehicle	
Accessory Uses					
Home Occupation (6.1.11.D.)	B	n/a		n/a	to be amended pending Housing Mitigation LDR Update
Home Business (6.1.11.E.)	C	n/a		1/employee	
Family Home Daycare (6.1.11.F.)	B	n/a		1/employee + 1 off-street pick-up/drop-off	
Home Daycare Center (6.1.11.G.)	C	n/a		1/employee + 2 off-street pick-up/drop-off	

Y=Use allowed, no use permit required, B=Basic Use Permit (Sec. 8.4.1.), C=Conditional Use Permit (Sec. 8.4.2.)

1. Allowed Uses				2. Use Requirements	
Use	Permit	Density	Individual Use (max)	Parking (min) (Div. 6.2.)	Employee Housing Floor Area per 1,000 sf (min) (Div. 6.3.)
Temporary Uses					to be amended pending Housing Mitigation LDR Update
Temporary Shelter (6.1.12.D.)	B	1 unit per lot (max)		2/DU	
Temp. Gravel Extraction and Processing (6.1.12.F.)	B	n/a		1/employee	
Y=Use allowed, no use permit required, B=Basic Use Permit (Sec. 8.4.1.), C=Conditional Use Permit (Sec. 8.4.2.)					

3. Operational Standards	
Outdoor Storage	(Sec. 6.4.1.)
Refuse and Recycling	(Sec. 6.4.2.)
Trash & recycling enclosure required	> 4 DUs and all nonresidential
Noise	(Sec. 6.4.3.)
Sound level at property line (max)	65 DBA
Vibration	(Sec. 6.4.4.)
Electrical Disturbances	(Sec. 6.4.5.)
Fire and Explosive Hazards	(Sec. 6.4.6.)

D. Development Options

Standards applicable to development options and subdivision in the NH-1 zone are provided or referenced below. Where a cross reference is provided, please see the referenced division or section for additional standards applicable in the NH-1 zone. This Subsection is intended to indicate all of the development option and subdivision standards applicable in the NH-1 zone, however, all standards in Article 7. are applicable in the NH-1 zone, unless stated otherwise.

1. Allowed Subdivision and Development Options		
Option	Lot Size (min)	Option Standards
Allowed Subdivision Options		
Land Division	7,500 sf	(Sec. 7.2.3.)
Condominium/Townhouse	n/a	(Sec. 7.2.4.)
2. Residential Subdivision Requirements		
Affordable Housing	to be amended pending Housing Mitigation LDR Update	
Required Affordable Housing		
Schools and Parks Exaction	(Div. 7.5.)	
Schools exaction		
Parks exaction		

3. Infrastructure				
Transportation Facilities				(Div. 7.6.)
Access				required
Right-of-way for Minor Local Road (min)				60'
Paved travel way for Minor Local Road (min)				20'
Required Utilities				(Div. 7.7.)
Water				public
Sewer				public
4. Required Subdivision and Development Option Permits				
Option	Sketch Plan (Sec. 8.3.1.)	Development Plan (Sec. 8.3.2.)	Development Option Plan (Sec. 8.5.2.)	Subdivision Plat (Sec. 8.5.3.)
Land Division				
≤ 10 Lots		X		X
> 10 Lots	X	X		X
Condominium/Townhouse				X

E. Additional Zone-specific Standards

The following standards apply in addition to all other standards applicable in the NH-1 zone.

1. **Minimum Density.** The minimum density for lots in the NH-1 is based on requiring a minimum density of 17.4 units per acre and are as follows:
 - a. Lots 5,125 sf or less: One Detached Single-Family Unit;
 - b. Lots 5,126 - 7,499 sf: Two units (either detached or attached)
 - c. Lots 7,500 or larger: Three units (either detached or attached)

2.2.13. CR-3: Commercial Residential-3 (P17-077)

A. Intent

1. **General Intent.** The intent of the Commercial Residential-3 (CR-3) zone is to provide for a vibrant mixed-use zone consisting primarily of retail, office and residential uses. This zone is located on both sides of Highway 89/191 from High School Road to Flat Creek bridge at the entrance to downtown Jackson.
2. **Buildings.** Buildings can be up to 3 or 4 stories in height. Massing, articulation, openings, and step backs are used to reduce bulk and mass. Front setbacks are varied, with some buildings pulled up to the street and others set back with landscaping in front, creating an attractive and green street edge.
3. **Parking.** Parking is primarily provided on-site, to the rear or side of buildings and screened from view with a screen-wall.
4. **Land Use.** Active uses, such as retail and service, are encouraged on the ground level, often with residential or office on the upper floors. Buildings of all residential uses are encouraged.
5. **Comprehensive Plan.** Based primarily on sub areas 4.1, 4.2, 4.3, 5.1 and 5.3 of the Comprehensive Plan.

B. Physical Development

Standards applicable to physical development are provided on the following pages. Where a cross-reference is listed, see the referenced division or section for additional standards. Standards in Article 5 apply unless stated otherwise.

1. Lot Standards

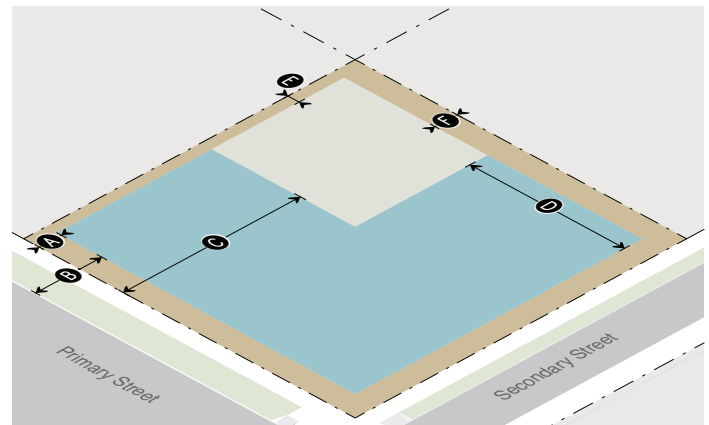

Building Setbacks

Sec. 9.4.11

Highway 89/191

Primary street setback range

Property line (min)	20'	A
Back of curb (min)	30'	B
Property line (max)	85'*	C
Secondary street range (min-max)	10' - 85'*	D

All Other Streets

Primary street setback range (min-max)	10' - 65'	*
Secondary street setback range (min-max)	10' - 65'	*
Side interior (min)	5'	E
Rear (min)	10'	F
Abutting protected zone (min)	10'	

*Residential projects are exempt from the max setback requirement

Landscaping

Div. 5.5

Landscape surface ratio (min)	10%
Highway 89 streetscape standards	see E.5

Plant Units

All uses	1/1,000 sf of landscape area
Parking lot (all uses)	1/12 parking spaces

Parking Setbacks

Sec. 9.4.8.

Highway: primary street (min)	20'
All Other Streets: primary street (min)	10'
Secondary street (min)	10'

Access

Curb cut width (max)	24'
----------------------	-----

2. Bulk Standards

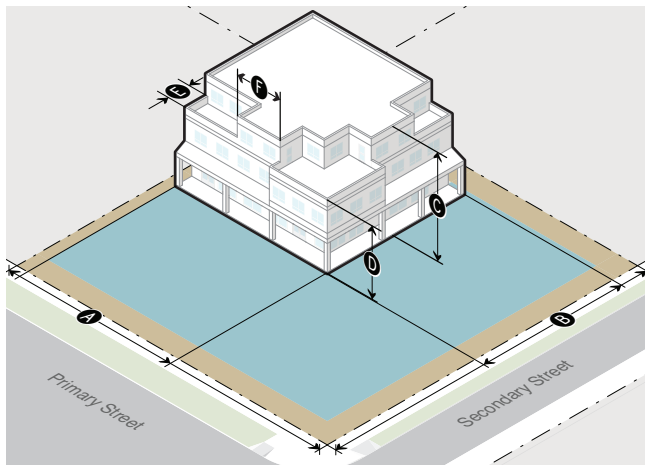

Street Facade	Sec. 9.4.11.
Width of ground and 2nd story in primary street setback range	A
% of lot width (min)	50%*
Length from street corner (min)	n/a
Width of ground and 2nd story in secondary street setback range	B
% of lot width (min)	50%*
Length from street corner	n/a

*Residential projects are exempt from the % of lot width requirement

Building Height	Sec. 9.4.9.
Height (max) roof pitch $\geq 5/12$	46' C
Height (max) roof pitch $< 5/12$	42' C
Stories (max) - see E.4 for additional height provisions	3 C
Height (min) - applies fronting Highway 89/191 only - see E.6	24' D

Building Stepback	Sec. 9.4.12.
Stepback for any 3rd story street facade or street facade over 30' (min)	10' E
Encroachment in stepback (max % of overall facade width)	60% F

A building with only residential use that has at least 4 units is exempt from the stepback requirement

Scale of Development	
Floor area ratio (FAR max)	0.40
Deed restricted housing exemption	Sec. 7.8.3.
Workforce housing floor area bonus	Sec. 7.8.4.

3. Form Standards

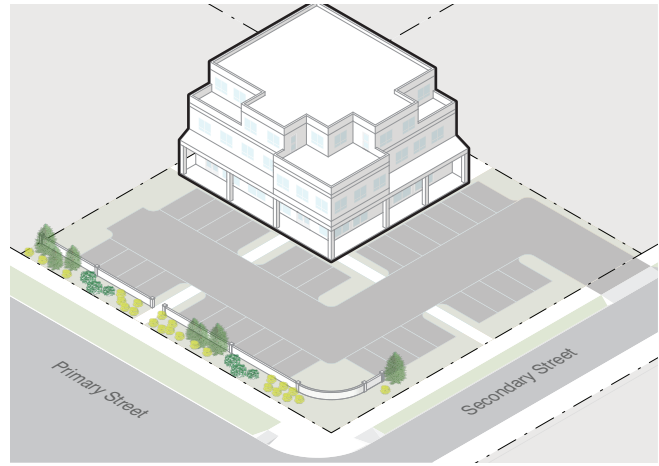

Design Guidelines	Sec. 5.8
The Design Guidelines apply to all residential and nonresidential development of three attached units or greater, except where exempted by Planning Director for additions of 20% or less that are consistent with existing architecture.	

Pedestrian Frontage Options	
Trees in grates	see Sec. 2.2.1.C.2
Trees in lawn	see Sec. 2.2.1.C.3

Building Frontage Options	
Shopfront	see Sec. 2.2.1.D.1
Office	see Sec. 2.2.1.D.2
Residential	see Sec. 2.2.1.D.3
Highway	see Sec. 2.2.1.D.5

Parking Type Options	
On-street parking	see Sec. 2.2.1.E.1
Surface parking	see Sec. 2.2.1.E.2
Enclosed parking	see Sec. 2.2.1.E.3
Tuck-Under Parking	see Sec. 2.2.1.E.4
Structured parking	see Sec. 2.2.1.E.5
Underground parking	see Sec. 2.2.1.E.6
Remote parking	see Sec. 2.2.1.E.7

4. Fencing	
Height (max)	
In street yard	4'
In side yard	6'
Setback (min)	
Primary or side street lot line/R.O.W/ sidewalk	1'
Side or rear lot line	0'
5. Environmental Standards	
Natural Resource Setback (min)	Sec. 5.1.1.
Cache Creek south of Cache Creek Dr.	20'
Flat Creek north of Hansen Ave.	25'
Flat Creek south of Hansen Ave.	50'
Wetland	30'
Irrigation Ditch Setback (min)	Sec. 7.7.4.D.
Irrigation Ditch	15'
Natural Resource Overlay (NRO)	Sec. 5.2.1.
6. Scenic Standards	
Exterior Lighting	Sec. 5.3.1.
Light trespass is prohibited.	
All lights over 600 lumens shall be fully shielded.	
Lumens per site (max)	3
All fixtures	100,000
Unshielded fixtures	5,500
Light Color	≤3000 Kelvin
Scenic Resource Overlay (SRO)	Sec. 5.3.2.
7. Natural Hazards to Avoid	

Steep Slopes	Sec. 5.4.1.
Development prohibited	Slopes > 30%
Hillside CUP required	Parcel with average cross-slope ≥ 10%
Areas of Unstable Soils	Sec. 5.4.2.
Fault Area	Sec. 5.4.3.
Floodplains	Sec. 5.4.4.
Wildland Urban Interface	Sec. 5.4.5.

8. Physical Development Permits Required							
Physical Development	Sketch Plan (Sec. 8.3.1.)	Development Plan (Sec. 8.3.2.)	Building Permit (Sec. 8.3.3.)	DRC Review (Sec. 8.2.6.)	Sign Permit (Sec. 8.3.5.)	Grading Permit (Sec. 8.3.4.)	Floodplain Permit
Site Area							
< 15,000 sf			X	X		Sec. 5.7.1.	Sec. 5.4.4.
15,000 - 30,000 sf		X	X	X		Sec. 5.7.1.	Sec. 5.4.4.
> 30,000 sf	X	X	X	X		Sec. 5.7.1.	Sec. 5.4.4.
> 30,000 sf for only residential use	optional	X	X	X		Sec. 5.7.1.	Sec. 5.4.4.
Sign					X	Sec. 5.7.1.	Sec. 5.4.4.

C. Allowed Uses and Use Standards

Standards applicable to use are provided below. Where a cross-reference is listed see the referenced division or section for additional standards. Allowed uses are listed in subsection 1. Uses that are not listed are prohibited unless a similar use determination is made pursuant to Sec. 6.1.2.C. All standards in Article 6. are applicable unless stated otherwise.

1. Allowed Uses				2. Use Requirements	
Use	Permit	Individual Use (max)	Density (max)	Parking (min) (Div. 6.2.) (E.1.)	Employee Housing (min) (Div. 6.3.)
Residential Uses					
Attached Single-Family Unit (6.1.4.B.)	B	8,000 sf habitable excluding basement	n/a	1/DU if < 2 bedrooms and < 500 sf; otherwise, 1.5/DU	to be amended pending Housing Mitigation LDR Update
Apartment (6.1.4.D.)	B				
Dormitory (6.1.4.F.)	B	n/a	n/a	0.25/bed	
Group Home (6.1.4.G.)	C	n/a	n/a	0.5/bed	
Commercial Uses					
Office (6.1.6.B.)	B	n/a	n/a	2.47/1,000 sf	to be amended pending Housing Mitigation LDR Update
Retail (6.1.6.C.)	B	50,000 sf excluding basement storage	n/a	3.37/1,000 sf	
Service (6.1.6.D.)	B			2.25/1,000 sf	
Restaurant/Bar (6.1.6.E.)	B	n/a	1/73 sf dining area + 1/40 sf bar area		
Mini-Storage Warehouse (6.1.6.G.)	B	n/a	1/10 storage units + 1/employee		
Heavy Retail/Service (6.1.6.F) (E.3)	C	n/a	n/a	1.5/1,000 sf + 2.25 per repair bay + 0.75/wash bay	
Amusement/Recreation					
Amusement (6.1.7.B.)	B	n/a	n/a	1/40 sf seating area or independent calculation	to be amended pending Housing Mitigation LDR Update
Developed Recreation (6.1.7.D.)	B	n/a	n/a	3.37/1,000 sf	
Outfitter/Tour Operator (6.1.7.E.)	B	n/a	n/a	independent calculation	
Institutional Uses					
Assembly (6.1.8.B.)	C	n/a	n/a	independent calculation	to be amended pending Housing Mitigation LDR Update
Day Care/Education (6.1.8.C.)	B	n/a	n/a	independent calculation	
Industrial Uses					
Light Industry (6.1.9.B)(E.3)	C	n/a	n/a	0.75/1,000sf + 0.75/company vehicle	to be amended pending Housing Mitigation LDR Update

Y = Use allowed, no use permit required B = Basic Use Permit (Sec. 8.4.1.) C = Conditional Use Permit (Sec. 8.4.2.)

1. Allowed Uses				2. Use Requirements	
Use	Permit	Individual Use (max)	Density (max)	Parking (min) (Div. 6.2.) (E.1.)	Employee Housing (min) (Div. 6.3.)
Transportation/Infrastructure					
Parking (6.1.10.B.)	C	n/a	n/a	n/a	
Utility Facility (6.1.10.C.)	C	n/a	n/a	0.75/employee + 0.75/stored vehicle	to be amended pending Housing Mitigation LDR Update
Wireless Communications Facilities (6.1.10.D.)				0.75/employee + 0.75/stored vehicle	
Minor	B	n/a	n/a		
Accessory Uses					
Accessory Residential Unit (6.1.11.B.)	B	n/a	n/a	1/DU	to be amended pending Housing Mitigation LDR Update
Home Occupation (6.1.11.D.)	B	n/a	n/a	n/a	
Family Home Daycare (6.1.11.F.)	B	n/a	n/a	0.75/employee + 0.75 off-street pick-up/drop-off	
Temporary Uses					
Christmas Tree Sales (6.1.12.B.)	Y	n/a	n/a	0.75/1,000 sf outdoor display area + 0.75/employee	to be amended pending Housing Mitigation LDR Update
Farm Stand (6.1.12.E.)	B	n/a	n/a	3.75/1,000 sf display area	

Y = Use allowed, no use permit required B = Basic Use Permit (Sec. 8.4.1.) C = Conditional Use Permit (Sec. 8.4.2.)

3. Operational Standards	
Outdoor Storage	Sec. 6.4.1.
Outdoor Storage	Prohibited
Freestanding storage units (trailers, sheds, "Bully Barns", tarpaulin structures, etc.) not made a permanent part of a structure	Prohibited
Refuse and Recycling	Sec. 6.4.2.
Trash & recycling enclosure required	> 4 DUs and all nonresidential
Noise	Sec. 6.4.3.
Sound level at property line (max)	65 DBA
Vibration	Sec. 6.4.4.
Electrical Disturbances	Sec. 6.4.5.
Fire and Explosive Hazards	Sec. 6.4.6.

D. Development Options and Subdivision

Standards applicable to development options and subdivision are provided below. Where a cross-reference is provided see the referenced division or section for additional standards. All standards in Article 7. are applicable unless stated otherwise.

1. Allowed Subdivision and Development Options		
Option	Lot Size (min)	Option Standards
Allowed Subdivision Options		
Land Division	7,500 sf	Sec. 7.2.3.
Townhouse Condominium Subdivision	n/a	Sec. 7.2.4.
2. Residential Subdivision Requirements		
Affordable Housing		
Required Affordable Housing		To be amended, pending Housing Mitigation LDR update
Schools and Parks Exaction		
Schools exaction	.020 acres per 1- or 2-family unit .015 acres per multi-family unit	
Parks exaction	9 acres per 1,000 resident	
3. Infrastructure		
Transportation Facilities		(Div. 7.6.)
Access		required
Right-of-way for Minor Local Road (min)		60'
Paved travel way for Minor Local Road (min)		20'
Required Utilities		(Div. 7.7.)
Water		public
Sewer		public

4. Required Subdivision and Development Option Permits				
Option	Sketch Plan (Sec. 8.3.1.)	Development Plan (Sec. 8.3.2.)	Development Option Plan (Sec. 8.5.2.)	Subdivision Plat (Sec. 8.5.3.)
Land Division				
≤ 10 Lots		X		X
> 10 Lots	X	X		X
Condominium/Townhouse				X

E. Additional Zone-Specific Standards

1. Provision of Nonresidential, Nonlodging Parking

- a. **Applicability.** The following options for providing required parking shall apply to allowed uses except:

- i. Residential Uses (Sec. 6.1.4.);
- ii. Lodging Uses (Sec. 6.1.5.); and
- iii. Accessory Residential Unit (6.1.11.B.).

- b. **On-street Parking.** Required parking may be provided on-street provided the following standards are met.

- i. An on-street parking space shall have the following length of uninterrupted curb adjoining to the lot of record of the use.

Uninterrupted Curb per On-street Parking Space	
Parking Space Angle	Uninterrupted Curb
Parallel	22'
45°/60°	18'
90°	9'

- ii. On-street parking shall not be provided along a red curb or other no-parking area put in place by the Town or WYDOT.
 - iii. The on-street parking shall follow the established configuration of existing on-street parking.
 - iv. On-street parking spaces shall be available for general public use at all times. No signs or actions limiting general public use of on-street spaces shall be permitted.
2. **Loading Requirement.** Sufficient off-street loading facilities must be provided. The requirements of Sec. 6.2.2.E. are not applicable. The applicant must address how their specific loading needs are being met in the proposed application.
3. **South Highway 191/89 or South Park Loop Frontage.** Heavy Service/Retail and Light Industry uses are only allowed on sites with Highway 191/89 frontage south of South Park Loop Road and sites with South Park Loop frontage.

4. **Workforce Housing Incentive for Additional Height.** A structure may be 48' in height and four stories provided the following criteria are met.
 - a. The following standards apply to the amount of additional floor area achieved through the increase in structure height; however, the actual floor area to which the following standards apply may be distributed throughout the structure.
 - i. It shall be deed restricted workforce, affordable, or employee housing with an occupancy restriction;
 - ii. It may have an employment and/or price restriction.
 - iii. It shall be exempt from the calculation of affordable housing required by Division 7.4, but shall not be used to meet the affordable housing requirement for the project.
 - b. The project shall provide the affordable housing required by Division 7.4 on site.
 - c. The site shall be at least 2 acres to provide opportunity for sufficient setback from, and building height step down to small scale development.
 - d. The site shall be served by transit within 1/4 mile.
 - e. The site shall be within 1/4 mile walking distance from numerous commercial services routinely needed by residents.
 - f. The additional building height shall not increase the floor area allowance or decrease the required open space.

5. **Highway 89/191 Streetscape Standards**

The following standards apply to all development abutting Highway 89/191. The goal is to provide for an attractive, high-quality streetscape.

- a. **Landscape Strip**
 - i. The first 20 feet adjacent to the right-of-way must be landscaped along the entire property frontage, except for breaks allowing pedestrian, bicycle and vehicular connections.
 - ii. The required landscape strip must include 1.5 plant units per 125 linear feet, as described in Div. 5.5. In order to maximize year-round screening, Alternative C is preferred.
- b. **Screening Wall for Parking Lots**
 - i. A screening wall (or year round vegetative hedge) must be placed within the landscape strip when the landscape strip abuts a parking lot. The screening wall or hedge must range in height from 2.5 feet minimum to 4 feet maximum. Variations in height are encouraged.
 - ii. The screening wall cannot be located in the public right-of-way.

- iii. The screening wall must be constructed of high-quality materials that are a combination of one or more of the following: stone, cast-stone, split-faced block, stucco over concrete masonry blocks, glass block, or other material approved by the Planning Director.
- iv. The maximum allowed length of a continuous, unbroken and uninterrupted wall plane of the screening is 50 feet. Breaks must be provided through the use of columns with an alternative material or through staggering the wall by at least 1 foot.
- v. The following graphic shows standards for required landscape strip and screening wall.

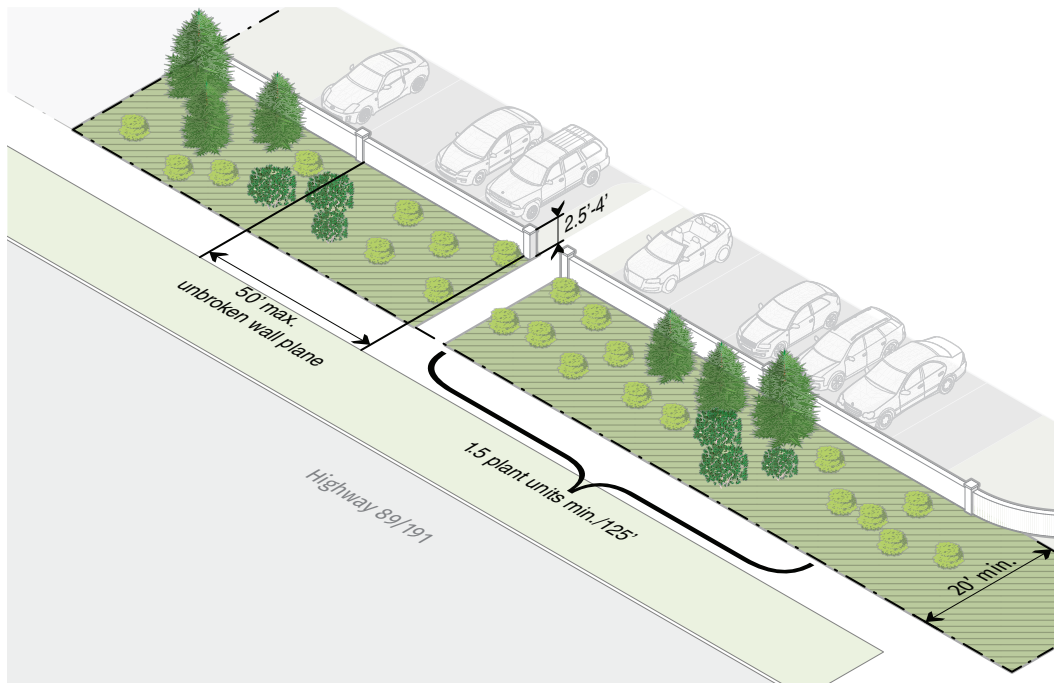

6. Highway 89/191 Minimum Height and Building Material Standards

The following standards apply to any building located within 85 feet of the ROW of Highway 89/191.

a. Minimum Height

The minimum height requirement applies to all building facades that face Highway 89/19. The minimum height requirement must wrap the corner of the building and extend at least 20 feet down the side of all building facades that do not have an immediately abutting building.

b. Building Materials

- i. Any building materials and treatments applied to building facades that face Highway 89/19 must wrap the corner of the building and extend at least 20 feet down the side of all building facades that do not have an immediately abutting building.
- ii. The following graphic shows standards for building height and building materials for buildings within 85' of Hwy. 89/191.

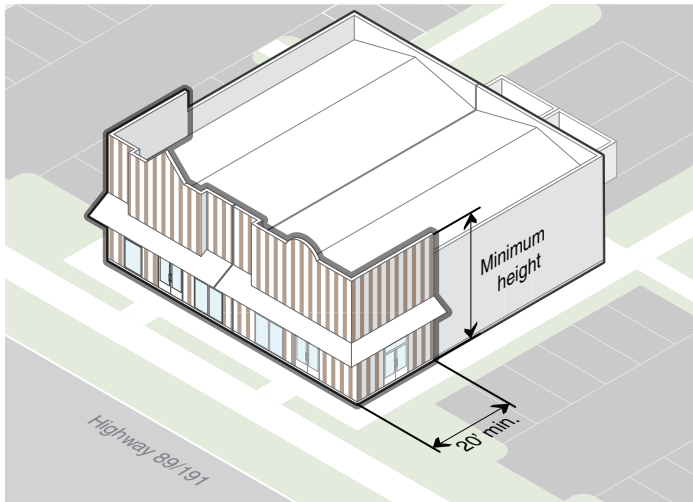

E. Establishment of a New PUD

Establishment of PUD zoning shall be achieved through an application for approval of a PUD development option established in this Division. PUD applications shall be reviewed pursuant to Sec. 8.7.3.

F. Amendment of an Existing PUD or Other Special Project

An amendment to an existing PUD or other special project listed in 1.8.2.C. shall be reviewed and approved pursuant to 8.2.13.D.

G. PUD Option Schedule

The below table establishes the PUD options allowed in each zoning district and references the standards for each option. Any PUD option not specifically established in this Division is prohibited.

PUD Option Schedule: Character Zones														
	Complete Neighborhood Zones													Rural Area Zones
	NL-1	NL-2	NL-3	NL-4	NL-5	NM-1	NM-2	NH-1	DC	CR-1	CR-2	CR-3	OR	n/a
	No PUD options are allowed in the Town													

PUD Option Schedule: Legacy Zones							
	Complete Neighborhood Zones				Rural Area Zones	Civic Zones	
	TS	UC	BP-ToJ	MHP-ToJ	R-ToJ	P/SP-ToJ	P-ToJ
No PUD Options are allowed in the Town							

H. List of Approved Planned Unit Development Zones - Town (PUD-ToJ)

The following PUD-ToJ Zones have been approved by the Town. The approved physical development, use, development option, and subdivision standards are hereby adopted by reference into the LDRs and are on file for public review with the Town Clerk and Planning Department. A copy of the approved development plan for each PUD-ToJ is also on file for review with the Town Clerk and Planning Department.

1. Planned Unit Development - Urban Residential (P15-029) (PUD-UR (P15-029)) (135 West Kelly Avenue)
2. Planned Unit Development - Urban Residential (P16-017) (PUD-UR (P16-017)) (1255 West Highway 22)
3. Planned Unit Development - Urban Residential (P16-019) (PUD-UR (P16-019)) (655 Powderhorn Lane)
4. Planned Unit Development - Auto-Urban Residential (P16-061) (PUD-AR (P16-061)) (335 Redmond Street)

5.2.1. Natural Resources Overlay (NRO) Standards (P17-077)

- i. **Winter Habitat Is Important.** During winter, heavy snow accumulation and freezing water surfaces reduces the availability of spring, summer, and fall habitat. At these times, bald eagles forage on wild ungulate and livestock carrion, supplemented by fish and waterfowl carcasses. Ungulate carrion is readily available but sparsely distributed on ungulate winter ranges, meaning that in addition to its nesting habitat, the crucial ungulate winter ranges also become critical to the bald eagle's survival.
- j. **Additional Crucial Winter Habitat Essential to Survival.** It is vital that bald eagle crucial winter habitat be protected to ensure the survival of this species in Teton County.

D. Applicability of NRO Standards

In addition to all other standards required by these LDRs, all physical development, use, development options and subdivision within the NRO shall comply with all standards of this Section, unless exempted below. Demonstration of compliance with the standards of this Section shall come from a qualified professional, even if an EA is exempt.

- 1. **Alterations and Additions.** Structural alterations and additions to existing structures shall be exempt from the standards of this Section.
- 2. **Land in Conservation Easement.** Land protected by a conservation easement where proposed development density is one house per 70 acres or less and the total acreage subject to the easement is 320 acres or more, shall be exempt from the standards of this Section, except that F.4. and F.6., shall apply.

E. Impacting the NRO

The base site area shall not be reduced because a portion of the lot of record is in the NRO. When conflicts exist between the NRO and SRO, the standards of this Section shall have priority and be achieved to the maximum extent practical. The requirements of Sec. 5.3.2. shall receive second priority. Where densities/intensities permitted cannot be achieved by locating development outside of the NRO, then lands protected by the NRO may be impacted pursuant to the standards of this Subsection.

- 1. **Minimizes Wildlife Impact.** The location of the proposed development shall minimize impacts on the areas protected (e.g., crucial migration routes, crucial winter range, nesting areas). For the purposes of this standard, "minimize" is defined as locating development to avoid higher quality habitats or vegetative cover types for lesser quality habitats or vegetative cover types. Only when avoidance is not practicable due to significant topographical constraints related to the property, may higher quality habitats or vegetative cover types be impacted.

5.3.1. Exterior Lighting Standards (P17-077)

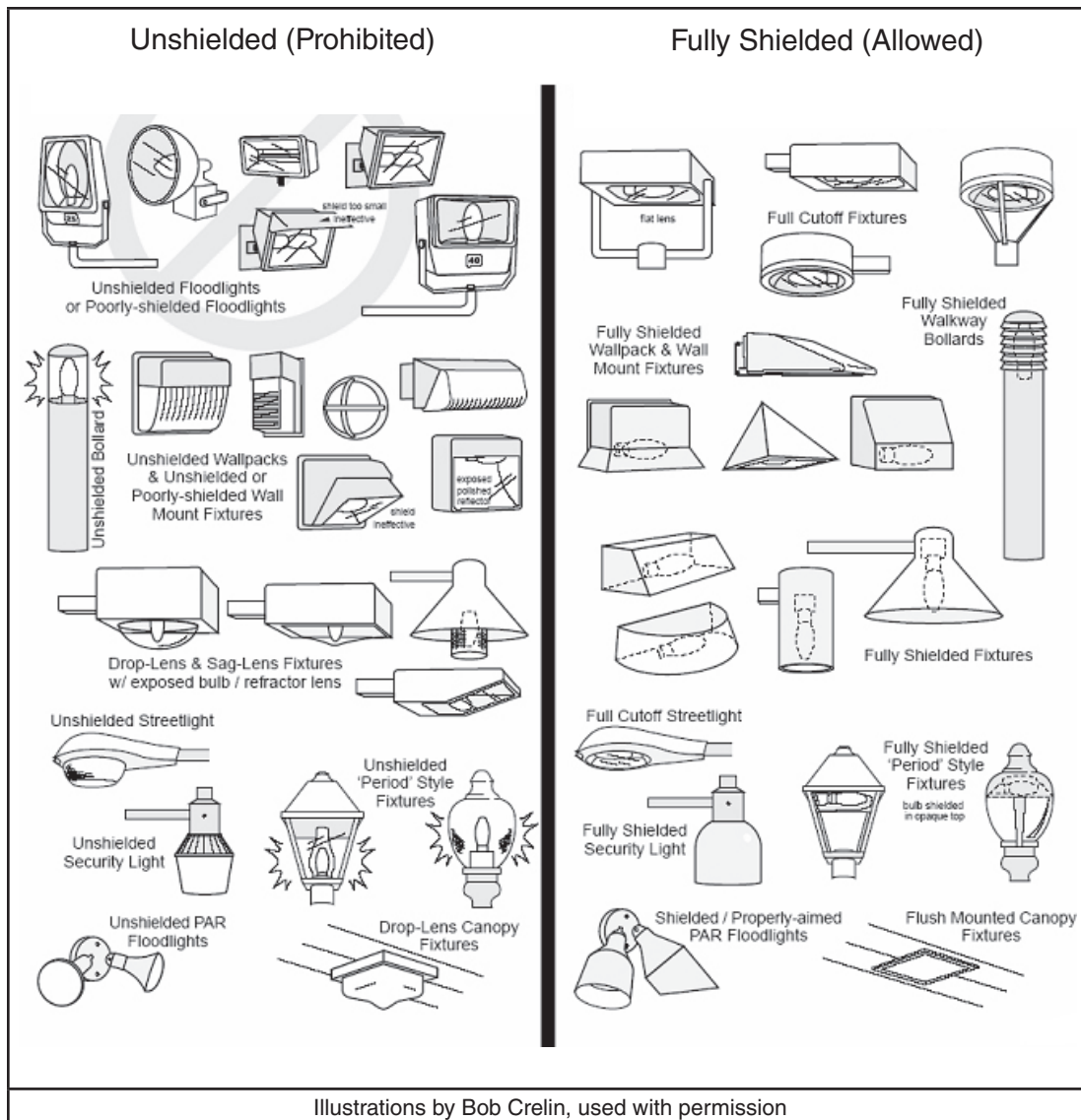

2. **Total Exterior Light Output.** Total exterior light output for light fixtures on a site shall not exceed the limits shown in the table below.

How much light is permitted?	All Fixtures	Unshielded Fixtures (for lights emitting fewer than 600 lumens)
Maximum lumens per sq ft of site development		
DC, CR-1, CR-2, CR-3, OR, TS, UC, BP-ToJ, MHP-ToJ, P/SP, P-ToJ, NL-5, NM-2, NH-1	3	Not applicable
R-ToJ, NL-1, NL-2, NL-3, NL-4, NM-1	1.5	Not applicable
Maximum lumens per site		
DC, CR-1, CR-2, CR-3, OR, TS, UC, BP-ToJ, MHP-ToJ, P/SP, P-ToJ, NL-5, NM-2, NH-1	100,000	5,500
R-ToJ, NL-1, NL-2, NL-3, NL-4, NM-1	60,000	4,000

- a. These lumen limits are upper limits and not a design goal; the design goal should be the lowest levels of lighting possible.
 - b. Individuals with visual impairments and organizations that primarily serve individuals with visual impairments (e.g. retirement communities, hospices, and hospitals) may use up to 4 times the illumination allowed by this section.
3. **Light Color.** Correlated color temperature of any exterior light source shall not exceed 3000 Kelvin.

EXAMPLE: Many light bulb manufacturers include correlated color temperature on packaging. Where packaging does not indicate light color in Kelvins, it is often indicated in descriptive terms. Lights with a “cool” quality typically exceed 3000 Kelvin in color temperature. Light bulbs that create a more “warm” tone are typically under 3000 K..

4. **Light Trespass.** All lighting fixtures shall limit horizontal light levels such that no light falls onto the adjacent property as shown in the diagram below.

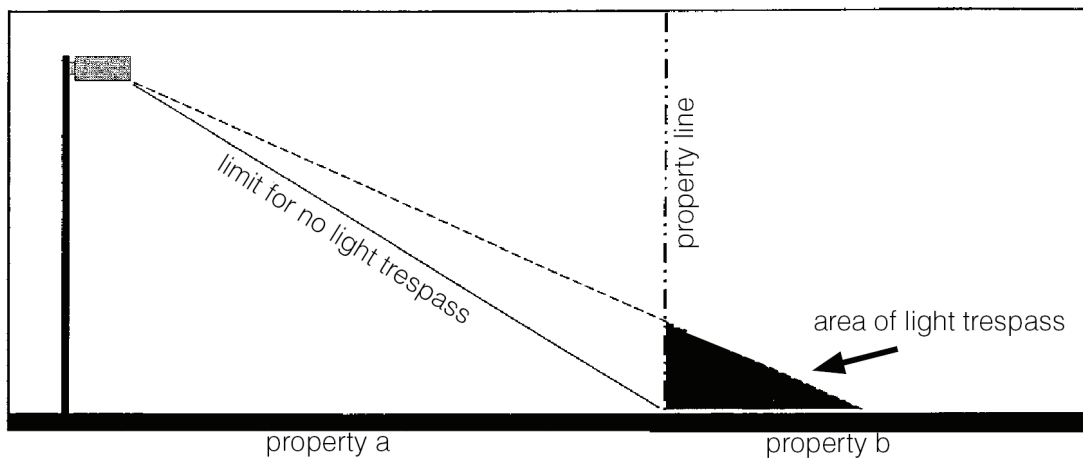

5. **Maximum Pole Height of Light Fixture.**

Zone	Maximum Pole Height of Light Fixtures
DC, CR-1, CR-2, CR-3, OR, TS, UC, BP-ToJ, MHP-ToJ, P/SP, P-ToJ, NL-5, NM-2, NH-1	18 feet
R-ToJ, NL-1, NL-2, NL-3, NL-4, NM-1	15 feet

6. **Controls.** All nonresidential lighting fixtures shall employ automatic lighting controls that extinguish exterior lighting when sufficient daylight is available. Such controls include, but are not limited to: timers, wireless remote monitoring with turn on/off capabilities, photo sensitive light controls, photoelectric switches, astronomic time switches or equivalent functions from a programmable lighting controller, building automation system or lighting energy management system, all with battery or similar backup power or device.

D. Applicability

1. **Foreground Standards.** All physical development, use, development options, and subdivision within the Foreground of the Scenic Areas described above shall comply with the foreground standards of 5.3.2.G.
2. **Development in Skyline.** All physical development, use, development options, and subdivision within the Skyline of the SRO shall comply with the skyline standards of 5.3.2.H.
3. **Exemptions**
 - a. **Remodeling or Expansion of Existing Structures.** Remodeling or expansion of structures that existed prior to November 9, 1994, shall be exempt from the foreground standards of 5.3.2.G.
 - b. **Land in Conservation Easement.** Land protected by a conservation easement where proposed development density is one house per 70 acres or less and the total acreage subject to the easement is 320 acres or more, shall be exempt from the foreground standards of 5.3.2.G.

E. Impact on SRO

1. The base site area shall not be reduced because a portion of a lot of record is located within the SRO.
2. When conflicts exist between the NRO and SRO, the standards of Sec. 5.2.1. shall have priority and be achieved to the maximum extent practical. The requirements of this Section shall receive second priority.

F. Visual Resource Analysis

1. If a proposed physical development, use, development option, or subdivision is in the SRO, the application shall contain a visual analysis narrative, provide a photographic simulation or other comparable visual analysis of the proposed development, depict the boundaries of the SRO, compare the visual impacts of alternative site designs, if any, and include plans identifying how the proposal complies with the standards of this Section.
2. A visual resource analysis shall demonstrate and document for review the visual impact of the proposed development on surrounding designated scenic corridors and viewpoints. The analysis shall show, in accurate perspective format, what portions of the proposed development are visible from various points along the scenic corridor or from critical viewpoints. Multiple perspectives may be required along scenic corridors to accurately reflect the appearance of the development as the viewpoint is moved along the corridor.
3. For development which is shown to be visible from the designated corridors or viewpoints, the analysis shall demonstrate, in accurate perspective format, the measures proposed to blend the development into the context of the setting. The setting shall include the view frame of the picture when viewing the development from a particular viewpoint and will typically include the backdrop

Div. 5.4. Natural Hazard Protection Standards

The purpose of this Division is to limit development in naturally hazardous areas.

Development in hazardous areas threatens the health, safety and welfare of human inhabitants, steep slopes, poor soils, avalanche chutes, floodplains, dense forest and areas along fault lines offer unique opportunities for interaction with the environment, but when natural events do occur in these areas the results can be disastrous.

5.4.1. Steep Slopes (P17-077)

A. Slopes in Excess of 25%

No physical development shall be permitted on natural slopes in excess of 25%.

B. Exceptions

1. **Manmade Slopes.** Physical development on manmade slopes is permitted, provided that the proposed finish grade complies with all other applicable standards of these LDRs.
2. **Small Slopes.** Physical development of isolated slopes that cover less than 1,000 square feet and have less than 10 feet of elevation change is permitted.
3. **Essential Access.** Physical development of steep slopes is permitted to provide essential access for vehicles and/or utilities when no other alternative access exists.

C. Standards in Hillside Areas

The purpose of this Section is to provide requirements, standards, criteria, and review procedures which are supplementary to those found elsewhere in these LDRs, and which apply only to hillside areas of the Town of Jackson.

1. **Definition.** For purposes of this Section, hillside areas within the Town of Jackson shall be defined as any lot of record which has an average cross-slope (in any direction) of 10% or greater. This definition shall include any lot of record upon which proposed physical development, use, development option, or subdivision may affect any portion of said lot of record having a slope of 10% or greater, even though the average cross-slope of the subject property may be less than 10%.
2. **Applicability and Exceptions.** The requirements and procedures of this Subsection shall apply when any hillside area is proposed for subdivision, lot split, or development or terrain disturbance of any kind, including a building permit. The only exception shall be in the case of a detached single-family unit on a lot which has been legally platted prior November 9, 1994.
3. **Conditional Use Permit Required.** Prior to any terrain disturbance, removal of vegetation, or any physical development, use, development option, or subdivision, a Conditional Use Permit shall be required.

C. Parking Lot Requirements

1. **General.** All parking lots shall comply with the plant unit requirements below.

Required Plant Units per Parking Space by Use and Zone				
Zone	Use			
	Agriculture	Residential	Institutional	All Other Uses
R	0	--	--	1 per 8 spaces
MHP-ToJ	--	--	--	1 per 8 spaces
NL-1	--	--	1 per 12 spaces	1 per 12 spaces
NL-2	--	--	1 per 12 spaces	1 per 12 spaces
NL-3	--	--	--	--
NL-4	--	--	--	--
NL-5	--	--	1 per 12 spaces	1 per 12 spaces
NM-1	--	--	--	--
NM-2	--	1 per 12 spaces	1 per 12 spaces	1 per 12 spaces
NH-1	--	1 per 12 spaces	1 per 12 spaces	1 per 12 spaces
BP-ToJ	--	--	--	1 per 16 spaces
UC	--	--	--	1 per 12 spaces
TS	--	--	--	0
DC	--	--	--	0
CR-1	--	--	--	1 per 12 spaces
CR-2	--	--	--	1 per 12 spaces
CR-3	--	--	--	1 per 12 spaces
OR	--	--	--	1 per 12 spaces
P/SP-ToJ	--	--	--	1 per 8 spaces

2. **Existing Trees Can Be Counted.** Existing trees that can be preserved by leaving the area under their canopy substantially undisturbed shall count towards the plant unit requirement for parking lots.
3. **Landscape Objectives.** The primary objectives of parking lot plant units shall be:
- To avoid large, unbroken expanses of asphalt;
 - To screen or soften parked vehicles as viewed from off site;
 - To provide attractive, pleasing streetscapes; and
 - To better define and organize vehicular and pedestrian spaces.

D. Loading Area Requirement

Except in the UC, DC, CR-1, CR-2, CR-3, and OR zones, two plant units per loading bay shall be provided.

EXAMPLE: Landscaping placed on a hillside or slope should consist of plant material that is typically found on a similar hillside or slope. Similarly, landscaping plant material placed in a floodplain or drainageway should be native vegetation that is generally found in a similar floodplain or drainageway. Further, the use of native vegetation should acknowledge the relative attractiveness of certain plant species to wildlife. Responsive planting designs should therefore position plants, which are palatable to wildlife in areas where browsing damage will not affect the screening or ornamental qualities of the planting plan.

C. Removal of Existing Vegetation Prohibited

Removal of specimen trees of 3 inch caliper or greater, and removal of shrub stands and rows with an average height of 3 feet or greater is prohibited in the DC, CR-1, CR-2, CR-3, OR, UC, PRD, MHP-ToJ, and BP-ToJ zones except in accordance with an approved landscape plan. Removal of dead, diseased, or damaged trees and shrubs which are a potential hazard to life and property may be approved by the Planning Director. In addition, vegetation may be removed to meet fuel reduction mitigation measures required by the Fire Marshal.

D. Use of Landscaped Areas

No portion of a site required to be landscaped shall be used for the parking of vehicles or for open storage of any kind.

E. Open Space Standards

All areas of required open space that are presently covered with natural vegetation and are to remain undisturbed shall not be required to be landscaped. Areas of open space that have been disturbed, except those to be used as sports fields and other areas that are to be paved, must be restored to prior conditions, as much as feasible. In addition, adequate ground cover shall be provided so that no landscaped ground areas are exposed to erosion. Noxious weeds appearing on the designated list under the Wyoming Weed and Pest Control Act of 1973 shall be controlled.

F. Landscaping in Public Rights-of-Way

In addition to required landscaping on private property, the property owner shall be responsible for the provision and maintenance of landscaping in accordance with the requirements of this Section for that area between the property line and the back of curb or the edge of the traveled way of any public street, alley or other public way, in a manner which provides consistency of landscaping and maintenance between the public properties to be landscaped and maintained and the adjacent private property. When such property lies within the right-of-way of a street or highway maintained by the Wyoming Department of Transportation (WYDOT), a landscape permit from WYDOT must be obtained.

7. Freestanding Signs

a. Height

- i. Permitted freestanding signs and support structures within the Town Square Sign District and DC, CR-1, CR-2, CR-3, OR, UC, NL-1, NL-2, NL-3, NL-4, NL-5, NM-1, NM-2, and NH-1 zones in the General Sign District and shall not exceed 6 feet in height.
- ii. Permitted freestanding signs and support structures within the CR-2, CR-3, BP-ToJ, and R-ToJ zones in the General Sign District shall not exceed 12 feet in height.
- iii. Sign heights for freestanding signs including support structures and any decorative extensions above the sign shall be measured from the adjacent road grade to the top of the sign including support structures. If the adjacent road grade is lower than the proposed freestanding sign, the sign shall be measured from the approved grade at the base of the proposed sign to the top of the sign including support structures.

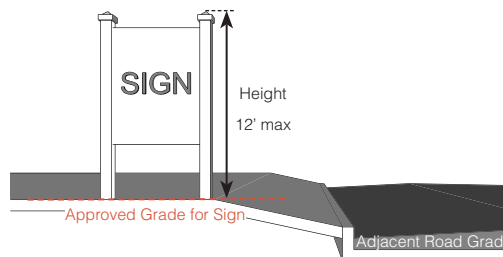
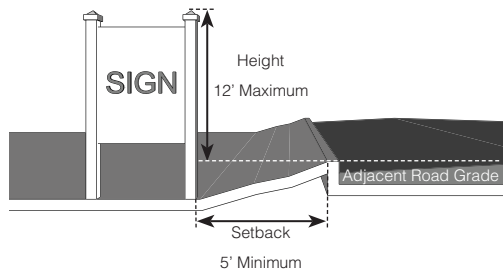

Div. 5.8. Design Guidelines

5.8.1. Applicability (P17-077)

A. General

The following applications shall be required to complete design review based upon criteria established in the Town's Design Guidelines prior to the issuance of a building permit or development plan, as established in [Div. 8.3](#).

1. All applications for nonresidential development and redevelopment within the Town.
2. All applications within the DC, CR-1, CR-2, CR-3, and OR zones.
3. All applications for residential development that includes three or more attached units.

B. Zone-Specific Applicability

In certain zones only portions of the Town's Design Guidelines apply. The zone-specific applicability of the design guidelines is established in [Article 2.-Article 4](#).

C. Planning Director Exemption

The Planning Director may exempt certain building additions and exterior modifications to existing buildings that require only a building permit approval, provided that the modifications do not expand the floor area of the building by more than 20% and such additions and modifications are consistent with the materials and architecture of the existing structure.

5.8.2. Design Guidelines (1/1/15, Ord. 1074)

The Town's Design Guidelines are established and adopted pursuant to Resolution No. 04-02 and are available in the office of the Planning Department or on the Town's website: www.townofjackson.com.

5.8.3. Design Review Committee (1/1/15, Ord. 1074)

Procedures and requirements for conduct of the Town's Design Review Committee are established in [Article 8](#).

Div. 6.1. Allowed Uses

6.1.1. Use Schedule (P17-077)

The Use Schedule establishes the principal, accessory, and temporary uses allowed in each zone. The definitions and standards for each use are established in Sec. 6.1.2.-Sec. 6.1.12. and referenced in the table. Additional uses may be allowed in a zone as part of an allowed development option as specified in Div. 7.1. The permit required for each allowed use is designated using the following symbols.

- A. “Y” denotes an allowed use that does not require a use permit. Physical development permits are still required as applicable.
- B. “B” denotes an allowed use that requires a Basic Use Permit to be obtained pursuant to Sec. 8.4.1.
- C. “C” denotes an allowed use that requires a Conditional Use Permit to be obtained pursuant to Sec. 8.4.2. A conditional use is generally compatible with the character of a zone but requires individual review of its configuration, density, and intensity in order to mitigate effects that may be adverse to the desired character of the zone.
- D. “S” denotes an allowed use that requires a Special Use Permit to be obtained pursuant to Sec. 8.4.3. Special uses are inherently incompatible with the character of the zone, but essential to the community; and therefore some provision must be made for their existence and operation. Special uses require specified locations due to common neighborhood opposition. These locations shall be determined by a comprehensive community-wide selection process designed to identify locations that best serve the special use while minimizing the negative impacts and obtrusiveness. Special uses also require individual review of their configuration, density, and intensity in order to mitigate effects that are adverse to the desired character of the zone.

E. Permit Exemption for Emergency Response

From time to time, a use may be a necessary part of an emergency response under the Comprehensive Emergency Management Plan, implemented by Teton County Emergency Management. In such instances, the requirement for a use permit shall be waived.

EXAMPLE: A heliport is an aviation use requiring a Conditional Use Permit. Temporary heliports are sometimes established in proximity to a forest fire for purposes of helicopter fire suppression. In the case of an emergency response, the requirement for a CUP is waived.

F. Use Schedule

The use schedule is established in the following tables.

Town Character Zones															
USE CATEGORY		Complete Neighborhood Zones												Rural Area Zones	Def/ Stds
Specific Use	NL-1	NL-2	NL-3	NL-4	NL-5	NM-1	NM-2	NH-1	DC	CR-1	CR-2	CR-3	OR	n/a	
Open Space															<u>6.1.2.</u>
Agriculture	B	B	B	B	B	B	--		--	--	--	--	--	--	<u>6.1.3.B.</u>
Outdoor Recreation	--	--	--	--	--	--	--	--	--	--	--	--	--	--	<u>6.1.3.C.</u>
Residential															<u>6.1.4.</u>
Detached Single-Family Unit	Y	Y	Y	Y	Y	Y	Y	Y	--	--	--	--	--	--	<u>6.1.4.B.</u>
Attached Single-Family Unit	--	--	--	--	--	B	B	B	B	B	B	B	B	--	<u>6.1.4.C.</u>
Apartment	--	--	--	--	B	B	B	B	B	B	B	B	B	--	<u>6.1.4.D.</u>
Mobile Home	--	--	--	--	--	--	--	--	--	--	--	--	--	--	<u>6.1.4.E.</u>
Dormitory	--	--	--	--	C	C	B	C	C	C	C	B	C	--	<u>6.1.4.F.</u>
Group Home	C	C	--	--	C	C	B	C	C	C	C	C	C	--	<u>6.1.4.G.</u>
Lodging															<u>6.1.5.</u>
Conventional Lodging	--	--	--	--	--	--	--	--	B(LO)	B(LO)	B(LO)	--	--	--	<u>6.1.5.B.</u>
Short-Term Rental Unit	--	--	--	--	--	--	--	--	B(LO)	B(LO)	B(LO)	--	--	--	<u>6.1.5.C.</u>
Commercial															<u>6.1.6.</u>
Office	--	--	--	--	--	--	--	--	B	B	B	B	B	--	<u>6.1.6.B.</u>
Retail	--	--	--	--	--	--	--	--	B	B	B	B	B ^z	--	<u>6.1.6.C.</u>
Service	--	--	--	--	--	--	--	--	B	B	B	B	B ^z	--	<u>6.1.6.D.</u>
Restaurant/Bar	--	--	--	--	--	--	--	--	B	B	B	B	--	--	<u>6.1.6.E.</u>
Heavy Retail/Service	--	--	--	--	--	--	--	--	--	--	--	B	--	--	<u>6.1.6.F.</u>
Mini-Storage Warehouse	--	--	--	--	--	--	--	--	--	--	--	B	--	--	<u>6.1.6.G.</u>
Nursery	--	--	--	--	--	--	--	--	--	--	--	--	--	--	<u>6.1.6.H.</u>
Amusement/Recreation															<u>6.1.7.</u>
Amusement	--	--	--	--	--	--	--	--	B	B	B	B	--	--	<u>6.1.7.B.</u>
Developed Recreation	--	--	--	--	--	--	--	--	B	B	B	B	--	--	<u>6.1.7.D.</u>
Outfitter/Tour Operator	--	--	--	--	--	--	--	--	C	B	B	B	--	--	<u>6.1.7.E.</u>
Adult Entertainment Business	--	--	--	--	--	--	--	--	--	--	--	--	--	--	<u>6.1.7.F.</u>
Institutional															<u>6.1.8.</u>

Y = Use allowed, no use permit required (LO) = Only allowed in Lodging Overlay -- = Use not allowed

B = Basic Use Permit required C = Conditional Use Permit required S = Special Use Permit required ^z = Use subject to zone specific standards

Town Character Zones															
USE CATEGORY		Complete Neighborhood Zones												Rural Area Zones	Def/ Stds
Specific Use	NL-1	NL-2	NL-3	NL-4	NL-5	NM-1	NM-2	NH-1	DC	CR-1	CR-2	CR-3	OR	n/a	
Assembly	C	C	--	--	C	--	C	C	C	C	C	C	C	--	6.1.8.B.
Daycare/Education	--	--	--	--	--	--	--	--	B	B	B	B	B	--	6.1.8.C.
Industrial															6.1.9.
Light Industry	--	--	--	--	--	--	--	--	--	--	--	B	--	--	6.1.9.B.
Heavy Industry	--	--	--	--	--	--	--	--	--	--	--	--	--	--	6.1.9.C.
Disposal	--	--	--	--	--	--	--	--	--	--	--	--	--	--	6.1.9.D.
Transportation/Infrastructure															6.1.10.
Parking	--	--	--	--	--	--	--	--	C	C	C	C	--	--	6.1.10.B.
Utility Facility	C	C	C	C	C	C	C	C	C	C	C	C	C	--	6.1.10.C.
Wireless Communication Facilities															6.1.10.D.
Minor	B	B	B	B	B	B	B	B	B	B	B	B	B	--	
Major	---	---	--	--	--	--	--	--	--	--	--	--	--	--	
Heliport	--	--	--	--	--	--	--	--	--	--	--	C	--	--	6.1.10.E.
Accessory Uses															6.1.11.
Accessory Residential Unit	B	B	B	B	--	B	--	--	B	B	B	B	B	--	6.1.11.B.
Bed and Breakfast	--	--	--	--	--	--	--	--	--	--	--	--	--	--	6.1.11.C.
Home Occupation	B	B	B	B	B	B	B	B	B	B	B	B	B	--	6.1.11.D.
Home Business	C	C	C	C	C	C	C	C	--	--	--	--	--	--	6.1.11.E.
Family Home Daycare	B	B	B	B	B	B	B	B	B	B	B	B	B	--	6.1.11.F.
Home Daycare Center	C	C	--	--	C	--	C	C	--	--	--	--	--	--	6.1.11.G.
Drive-In Facility	--	--	--	--	--	--	--	--	--	--	--	B	--	--	6.1.11.H.
Temporary Uses															6.1.12.
Christmas Tree Sales	--	--	--	--	--	--	--	--	Y	Y	Y	Y	--	--	6.1.12.B.
Real Estate Sales Office	--	--	--	--	--	--	--	--	--	--	--		--	--	6.1.12.C.
Temporary Shelter	B	B	B	B	B	B	B	B	--	--	--	--	--	--	6.1.12.D.
Farm Stand	--	--	--	--	--	--	--	--	B	B	B	B	--	--	6.1.12.E.
Temp. Gravel Extraction and Processing	B	B	B	B	B	B	B	B	--	--	--	--	--	--	6.1.12.F.

Y = Use allowed, no use permit required (LO) = Only allowed in Lodging Overlay -- = Use not allowed

B = Basic Use Permit required C = Conditional Use Permit required S = Special Use Permit required ^z = Use subject to zone specific standards

Town Legacy Zones								
USE CATEGORY	Complete Neighbor- hood Zones				Rural Area Zones	Civic Zones		Def/ Stds
Specific Use	TS	UC	BP- ToJ	MHP- ToJ	R-ToJ	P/SP- ToJ	P-ToJ	
Open Space								<u>6.1.2.</u>
Agriculture	--	--	--	--	B	Y	Y	<u>6.1.3.B.</u>
Outdoor Recreation	--	--	C	--	C	C	C	<u>6.1.3.C.</u>
Residential								<u>6.1.4.</u>
Detached Single-Family Unit	--	Y	--	--	Y	--	--	<u>6.1.4.B.</u>
Attached Single-Family Unit	--	B ^z	--	--	--	--	--	<u>6.1.4.C.</u>
Apartment	--	B ^z	--	--	--	--	--	<u>6.1.4.D.</u>
Mobile Home	--	--	--	B ^z	--	--	--	<u>6.1.4.E.</u>
Dormitory	--	C	--	--	C	C	--	<u>6.1.4.F.</u>
Group Home	--	C	--	--	C ^z	C	--	<u>6.1.4.G.</u>
Lodging								<u>6.1.5.</u>
Conventional Lodging	C(LO)	B(LO)	--	--	--	--	--	<u>6.1.5.B.</u>
Short-Term Rental Unit	C(LO)	B(LO)	--	--	--	--	--	<u>6.1.5.C.</u>
Commercial								<u>6.1.6.</u>
Office	B	B	--	--	--	C	--	<u>6.1.6.B.</u>
Retail	B	B	--	--	--	--	--	<u>6.1.6.C.</u>
Service	B	B	--	--	--	C	--	<u>6.1.6.D.</u>
Restaurant/Bar	B	B	--	--	--	--	--	<u>6.1.6.E.</u>
Heavy Retail/Service	--	--	B	--	--	C	--	<u>6.1.6.F.</u>
Mini-Storage Ware-house	--	--	B	--	--	C	--	<u>6.1.6.G.</u>
Nursery	--	--	C	--	C	--	--	<u>6.1.6.H.</u>
Amusement/Recreation								<u>6.1.7.</u>
Amusement	C	C	--	--	--	--	--	<u>6.1.7.B.</u>
Developed Recreation	--	B	C	--	--	C	--	<u>6.1.7.D.</u>
Outfitter/Tour Operator	--	C	C	--	--	--	--	<u>6.1.7.E.</u>
Adult Entertainment Business	--	--	C	--	--	--	--	<u>6.1.7.F.</u>
Institutional								<u>6.1.8.</u>
Assembly	--	C	C	--	C	C	--	<u>6.1.8.B.</u>
Daycare/Education	--	B	C	--	--	C	--	<u>6.1.8.C.</u>

Key: Y = Use allowed, no use permit required (LO) = Only allowed in Lodging Overlay
(OF) = Only allowed in Office Overlay -- = Use not allowed

B = Basic Use Permit required C = Conditional Use Permit required S = Special Use
Permit required ^z = Use subject to zone specific standards

Town Legacy Zones								
USE CATEGORY	Complete Neighbor- hood Zones				Rural Area Zones	Civic Zones		Def/ Stds
Specific Use	TS	UC	BP- ToJ	MHP- ToJ	R-ToJ	P/SP- ToJ	P-ToJ	
Industrial								<u>6.1.9.</u>
Light Industry	--	--	B	--	--	C	--	<u>6.1.9.B.</u>
Heavy Industry	--	--	C	--	--	C	--	<u>6.1.9.C.</u>
Disposal	--	--	C	--	--	C	--	<u>6.1.9.D.</u>
Transportation/Infrastructure								<u>6.1.10.</u>
Parking	--	--	--	--	--	C	--	<u>6.1.10.B.</u>
Utility Facility	--	C	C	C	C	C	C	<u>6.1.10.C.</u>
Wireless Communication Facilities								<u>6.1.10.D.</u>
Minor	B	B	B	B	B	B	B	
Major	--	--	C	--	--	C	C	
Heliport	--	--	C	--	--	C	--	<u>6.1.10.E.</u>
Accessory Uses								<u>6.1.11.</u>
Accessory Residential Unit	B	B	C	--	B	B	--	<u>6.1.11.B.</u>
Bed and Breakfast	--	B(LO)	--	--	--	--	--	<u>6.1.11.C.</u>
Home Occupation	B	B	B	B	B	B	--	<u>6.1.11.D.</u>
Home Business	--	B	--	--	C	--	--	<u>6.1.11.E.</u>
Family Home Daycare	--	B	B	--	B	--	--	<u>6.1.11.F.</u>
Home Daycare Center	--	B	C	--	--	B	--	<u>6.1.11.G.</u>
Drive-In Facility	--	B	--	--	--	--	--	<u>6.1.11.H.</u>
Temporary Uses								<u>6.1.12.</u>
Christmas Tree Sales	--	Y	Y	--	Y	Y	Y	<u>6.1.12.B.</u>
Real Estate Sales Office	--	--	B	--	B	--	--	<u>6.1.12.C.</u>
Temporary Shelter	--	B	--	B	B	--	--	<u>6.1.12.D.</u>
Farm Stand	--	B	--	--	B	B	--	<u>6.1.12.E.</u>
Temp. Gravel Ex- traction and Process- ing	--	B	B	B	B	B	B	<u>6.1.12.F.</u>

Key: Y = Use allowed, no use permit required (LO) = Only allowed in Lodging Overlay
(OF) = Only allowed in Office Overlay -- = Use not allowed

B = Basic Use Permit required C = Conditional Use Permit required S = Special Use
Permit required ² = Use subject to zone specific standards

Div. 6.4. Operational Standards

6.4.1. Outside Storage (3/22/17, Ord. 1170)

A. Use of Front Yards

The use of the front yard (street yard) of a residential use for the storage of boats, snowmobiles, trailers, RVs, and similar motor vehicles and equipment is prohibited.

B. Storage of Structures

The storing of structures of any kind is not permitted in any residential zone.

C. Vehicle and Equipment Storage - Vacant Property

The storage of any vehicle on vacant property in a residential zone for more than 3 consecutive days is prohibited. This includes boats, rafts, trailers, snowmobiles, campers, RVs and similar vehicles, and equipment. This also includes heavy equipment, construction equipment, and construction materials. Nothing herein shall be construed to prohibit the storage of vehicles and equipment for temporary construction, provided the storage area is fenced, well marked, and posted. For purposes of this provision, lots which are normally kept and maintained as yard area for an adjacent residence shall not be considered vacant property, provided the vehicles, equipment, and materials stored thereon are owned, supervised, and controlled by an occupant of the adjacent residence.

D. Outdoor Display

The organized outdoor display of goods for sale in association with a nonresidential use is allowed, except an Adult Entertainment Business (see 6.1.7.F.), provided it is contained on private property.

6.4.2. Refuse and Recycling (1/1/15, Ord. 1074)

A. Town Trash and Recycling Enclosures

Trash and recycling enclosures shall be provided for all nonresidential uses and multi-family developments of 4 or more units. Enclosures shall be of similar material and color to the building. Enclosures shall be entirely enclosed with the side facing the street or alley to be a gate whenever feasible. Enclosures shall provide adequate space for recycling as determined by the Planning Director. Enclosures shall be consolidated wherever possible.

6.4.3. Noise (P17-077)

All uses shall conform with the following standards.

A. Maximum Noise

Noises shall not exceed the maximum sound levels prescribed in the table below, beyond the site boundary lines, except that when a nonresidential activity in contiguous to a residential zone, the residential zone standard shall govern.

Noise Level Restrictions	
Zone	Maximum Permitted Sound Level
R, MHP-ToJ, NL-1, NL-2, NL-3, NL-4, NL-5, NM-1, NM-2, NH-1	55 DBA
All other zones	65 DBA

B. Exceptions

1. **General.** Noises of vehicles, home appliances, and chain saws in private use, occasionally used safety signals, warning signals, emergency pressure relief valves, and temporary construction operations shall be exempt from the requirements of this Section.
2. **Limited Exception/Limited Interval of Time/One Day.** The maximum permitted sound level may be exceeded by 10 DBA for a single period, not to exceed 15 minutes, in any one day.
3. **Impact Noises.** For the purposes of this Section, impact noises are those noises whose peak values are more than 6 DBA higher than the values indicated on the sound level meter, and are of short duration, such as the noise of a forging hammer or punch press. For impact noises, the maximum permitted sound level may be exceeded by 10 DBA.

C. Measurement

Noise shall be measured with a sound level meter meeting the standards of the American National Standards Institute (ANSI S1.4-1961) "American Standard Specification for General Purpose Sound Level Meters." The instrument shall be set to the A-weighted response scale and the meter to the slow response. Measurements shall be conducted in accord with ANSI S1.2-1962 "American Standard Method for the Physical Measurement of Sound" (or most current standards). Measurements may be made at any point along a zone boundary or site boundary line.

6.4.4. Vibration (1/4/17, Ord. 1163)

All uses shall conform with the following standards:

A. General

Vibration shall be measured at the site boundary line. Except for temporary construction operations and blasting for avalanche control, no activity shall cause or create a displacement for the frequencies prescribed in the table below.

Maximum Permitted Steady State Vibration Displacement	
Frequency (cycles per second)	Vibration Displacement (inches)

Div. 7.1. Development Option Standards

7.1.1. Development Options Schedule (P17-077)

The table below establishes the development options allowed in each zone. The standards for each development option are established in this Division. The density and intensity requirements for each development option are located in the standards for the zone, found in [Article 2.-Article 4.](#) The thresholds for permitting allowed development options are also established by zone.

Town Character Zones - Development Options															
	Complete Neighborhood Zones													Rural Area Zones	
Option	NL-1	NL-2	NL-3	NL-4	NL-5	NM-1	NM-2	NH-1	DC	CR-1	CR-2	CR-3	OR	n/a	Stds
MHP	--	--	--	--	--	--	--	--	--	--	--	--	--	--	<u>7.1.3.</u>

Key: P = Development option allowed with appropriate permit -- = Development option prohibited

Town Legacy Zones - Development Options								
	Complete Neighborhood Zones				Rural Area Zones	Civic Zones		
Option	TS	UC	BP- ToJ	MHP- ToJ	R- ToJ	P/SP- ToJ	P- ToJ	Stds
MHP	--	--	--	P	--	--	--	<u>7.1.3.</u>

Key: P = Development option allowed with appropriate permit -- = Development option prohibited

7.1.2. Planned Residential Development (PRD) (1/1/15, Ord. 1074)

[Section number reserved, standards only apply in County]

7.1.3. [deleted] (P17-077)

[Section number reserved, original Section deleted]

7.1.4. Mobile Home Park (1/1/15, Ord. 1074)

Mobile Home Parks shall meet the following standards. Mobile Home Parks may be proposed in the MHP-ToJ or as an Urban Cluster Development.

A. Existing Mobile Home Parks in the MHP-ToJ. Existing mobile home parks within the MHP-ToJ zone shall be allowed to continue, expand, and redevelop, provided the standards in this Subsection are met.

- 1. Density.** The number of units in an existing mobile home park in the MHP-ToJ shall not be limited.

Div. 7.2. Subdivision Standards

This Division contains the development standards required for subdivision, such as requirements for new roads, water and sewer infrastructure, utilities, parks, and other physical improvements necessary to safely serve newly subdivided property and minimize impacts on existing community services and infrastructure. See [Sec. 8.5.3](#), for the procedure to subdivide property.

7.2.1. Subdivision Types Schedule (P17-077)

The table below establishes the subdivision types allowed in each zone. The standards for all subdivisions and each subdivision type are established in this Division. The density and intensity requirements for each subdivision type are located in the standards for the zone, found in [Article 2](#)-[Article 4](#). The thresholds for permitting allowed subdivision are also established by zone.

Town Character Zones - Subdivision Types															
			Complete Neighborhood Zones											Rural Area Zones	
	NL-1	NL-2	NL-3	NL-4	NL-5	NM-1	NM-2	NH-1	DC	CR-1	CR-2	CR-3	OR	n/a	Stds
Land Division	P	P	P	P	P	P	P	P	P	P	P	P	P	--	7.2.3.
Condominium/ Townhouse	--	--	--	--	--	--	P	p	P	P	P	p	P	--	7.2.4.

Key: P = Development option allowed with appropriate permit
 -- = Development option prohibited

Town Legacy Zones - Subdivision Types								
	Complete Neighborhood Zones				Rural Area Zones	Civic Zones		
	BP- TS	MHP- UC	ToJ	ToJ	R- ToJ	P/SP- ToJ	P- ToJ	Stds
Land Division	P	P	P	--	P	P	P	7.2.3.
Condominium/ Townhouse	P	P	P	--	--	P	P	7.2.4.

Key: P = Development option allowed with appropriate permit
 -- = Development option prohibited

7.8.4. Workforce Housing Floor Area Bonus (P17-077)

A. Intent

In most cases, the volume of building allowed by the minimum setbacks and maximum height exceeds the volume of building allowed by the FAR of a property. The purpose of the workforce housing floor area bonus is to encourage development, especially by the private sector, of additional deed restricted housing in that excess volume by allowing additional unrestricted floor area.

B. Applicability

The exemptions of this Section shall apply to both the deed restricted and unrestricted floor area approved pursuant to this Section.

1. **Maximum Amount of Unrestricted Housing.** The maximum amount of unrestricted floor area that can be approved pursuant to this Section is limited by the amount of restricted floor area provided pursuant to this Section, as tabulated below.

Maximum Exempt Unrestricted Floor Area per Voluntarily Restricted Floor Area	
Zone	Unrestricted Floor Area : Restricted Floor Area
NM-2	2:1
NH-1	2:1
DC	2:1
CR-1	2:1
CR-2	2:1
CR-3	2:1
OR	2:1

2. **Restricted Housing.** The restricted floor area provided pursuant to this Section shall be subject to an affordable, employee, employment-based, or rental workforce deed restriction, acceptable to the Jackson/Teton County Housing Department, which is recorded with the County Clerk.
3. **Required Restrictions Do Not Apply.** Floor area that is required to be restricted in order to comply with Div. 6.3., Div. 7.4., or another standard of these LDRs shall not be included in the calculation of the maximum amount of unrestricted floor area allowed by this Section.
4. **Allowed Use.** Floor area approved pursuant to this Section shall only be used for one of the following uses:
 - a. Attached Single Family Dwelling (6.1.4.C.); or
 - b. Apartment (6.1.4.D.); or
 - c. Dormitory (6.1.4.F.); or

D. Timing

A pre-application conference shall be held prior to the submittal of an application.

A potential applicant shall initiate a request for a pre-application conference pursuant to Sec. 8.2.4. The pre-application conference shall be scheduled for a date acceptable to the requester that is within 60 days of receipt of the request.

E. Conference Focus

At the pre-application conference, the applicant and representatives of the Town shall discuss the potential proposal to identify the standards and procedures that would apply to the proposal. Applicable LDR provisions not identified at the pre-application conference or amended following the pre-application conference are still applicable to the proposal. The level of detail of the Town's review will match the level of detail contained in the materials submitted with the request for the pre-application conference. The pre-application conference is intended as a means of facilitating the application review process; discussions at the meeting and the written summary of the meeting are not binding on the Town.

F. Conference Summary

The pre-application conference requester shall be provided a written summary of the pre-application conference within 14 days of its completion.

G. Expiration

A pre-application conference only satisfies a pre-application conference requirement if the application for which it is required is submitted within 12 months of the pre-application conference.

8.2.2. Environmental Analysis (EA) (P17-077)

A. Purpose

The purpose of an Environmental Analysis (EA) is to coordinate the application of all natural resource protection standards through identification of the natural resources on a site. An EA review does not result in application approval, it results in recommended natural resource protections for an application.

B. Applicability

Unless exempted below, physical development, use, development options, and subdivision subject to Div. 5.1., Div. 5.2. or Sec. 7.1.2. shall complete an EA in accordance with the requirements of this Section.

1. Exemptions

- a. **Previous Approval.** Physical development, use, development options, and subdivision that has received approval in accordance with the LDRs.
- b. **Detached Single-Family Dwelling.** Physical development of a detached single-family dwelling if:
 - i. The proposed location is not within the NRO;
 - ii. It is the only dwelling unit on the lot of record, or the density on the site is less than or equal to one dwelling unit per 35 acres of base site area; and

- iii. Compliance with all setback and buffer standards in Div. 5.1. and Div. 5.2. is demonstrated.
- c. **Expansion.** Expansion of an existing building or the addition of an accessory structure within the impact area of the existing building.
- d. **Conservation Easement.** Land subject to a conservation easement held by a formal land trust that has a mandate to protect conservation values, for which a rigorous review and study of the conservation values of the land has been performed as a basis for establishing the easement, if the applicant demonstrates that the review and study satisfies the objectives of the EA. In such instances the review and study completed for the conservation easement may be substituted for the EA.
- e. **Other.** The Planning Director may waive the requirement for an EA if the development complies with the following:
 - i. The lot of record is outside the NRO and the application demonstrates compliance with all setback and buffer standards in Div. 5.1. and Div. 5.2.; or
 - ii. The lot of record is in the NRO but is also in an area that has well-documented habitat information where additional physical development, use, development options and subdivision is anticipated to have minimal additional negative impacts to animal species protected by Sec. 5.2.1. While an EA is not required for lands meeting this exemption, development on such lands shall still be subject to certain standards for development determined appropriate by the Planning Director or the Town Council.

C. Professional Preparation

An EA shall be prepared by an environmental professional with expertise in the subject of environmental sciences based on education, professional certifications, experience in the field, and their understating of these LDRs, the Jackson/Teton County Comprehensive Plan, and the goals and objectives thereof.

D. Substantial Changes

When changes are made to the proposal after the EA has been completed, so that the accuracy of the EA is significantly compromised, the Planning Director may require that the applicant provide updated analysis data to address the changes.

E. Expiration

1. An EA that is completed 3 or more years before the submittal of the associated application shall not be considered current and shall not meet the requirements of this Section.
2. Notwithstanding the standard above, the Planning Director may require a wholly new or amended EA for EAs that are less than 3 years old if the standards or circumstances analyzed have been altered significantly.
3. The Planning Director may extend the expiration date of an EA beyond 3 years if:

B. Maximum Density

Unless stated otherwise for a specific provision of these LDRs, density is calculated by dividing the number of units by the base site area, or gross site area in Character Zones (Div. 2.2. & Div. 3.2.).

EXAMPLE: 3 units on 35 acres of base site area is a density of 0.086 units/acre ($3/35 = .086$).

C. Floor Area Ratio (FAR)/Maximum Floor Area

1. The maximum floor area (see Sec. 9.4.5. for definition of Floor Area) allowed on a site shall be the maximum habitable floor area not including basement floor area, as defined in Sec. 9.5.B.
2. The site area used to calculate maximum floor area shall be:
 - a. gross site area in Character Zones (Div. 2.2. & Div. 3.2.), and
 - b. base site area in Legacy Zones (Div. 2.3. & Div. 3.3.).
3. Unless otherwise defined in these LDRs, the maximum allowed floor area above grade is calculated by multiplying the allowed FAR by the applicable site area. Inversely, FAR is calculated by dividing the habitable floor area above grade by the applicable site area.

EXAMPLE: On a site area of 24,000 square feet a building with 8,000 square feet of habitable floor area where 2,000 square feet was in the basement would have an FAR of .25 ($(8,000-2,000)/24,000 = .25$). Alternatively, unless otherwise defined in these LDRs, the maximum allowed floor area is calculated by multiplying the allowed FAR by the base site area (see Sec. 9.5.F. for definition of Floor Area).

D. Landscape Surface Ratio (LSR)/Minimum Landscape Surface Area

1. The landscape surface ratio (LSR) is calculated by dividing the landscape surface area by the base site area, or gross site area in Character Zones (Div. 2.2. & Div. 3.2.).

EXAMPLE: A property that has 6,000 square feet of landscape surface area and a base site area of 24,000 square feet has an LSR of .25 ($6,000/24,000 = .25$). Unless otherwise defined in these LDRs, the minimum required amount of landscape surface area is calculated by multiplying the required LSR by the base site area (see Sec. 9.5.L. for definition of Landscape Surface Area).

2. The LSR for Apartments in the NM-2 and NH-1 zones shall be calculated consistent with the graphic below.

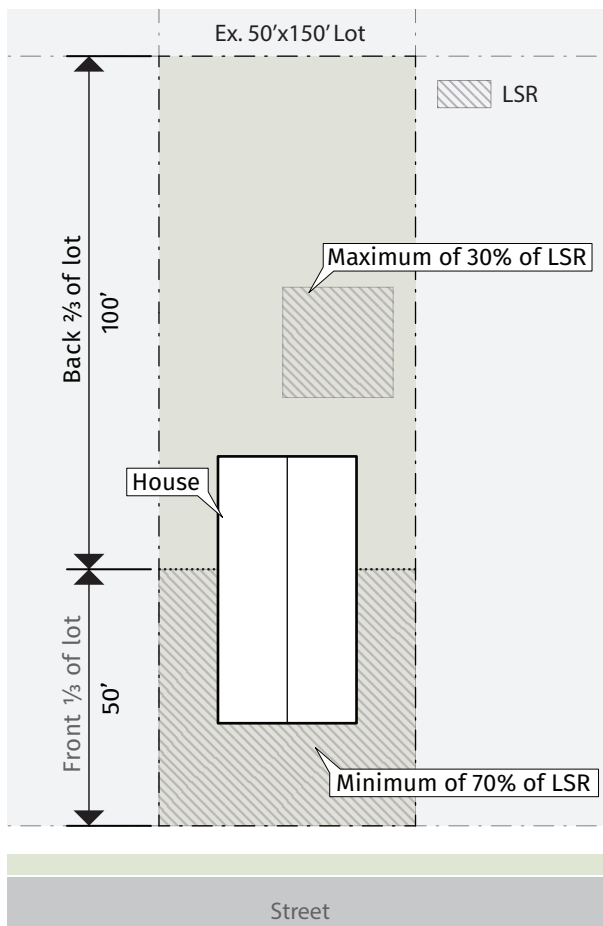

E. Lot Coverage

Lot coverage is calculated by dividing the building footprint by the adjusted site area, or gross site area in Character Zones ([Div. 2.2.](#) & [Div. 3.2.](#)).

EXAMPLE: A single-family unit with a building footprint of 1,500 square feet on an adjusted site area of 7,500 sf would have a lot coverage of .2 ($1,500/7,500 = .2$). Unless otherwise defined in these LDRs, the maximum building footprint is calculated by multiplying the maximum lot coverage by the adjusted site area (see [Sec. 9.5.F.](#) for definition of Footprint, Building). Sites with residential and nonresidential use shall be exempt from any lot coverage requirement.

F. Minimum Lot Size

Minimum lot size means the required minimum gross site area of a newly created lot of record, including remnant parcels.

E. Street Setback

1. Point of Measurement

- a. **Character Zones.** In a Character Zone (Div. 2.2. & Div. 3.2.) a street setback shall be measured to the back of the pedestrian frontage.
- b. **Legacy Zones.** In a Legacy Zone (Div. 2.3. & Div. 3.3.) a street setback shall be measured to any road right-of-way, roadway, vehicular access easement, additional width required for right-of-way purpose as established in the Master Plan for Street Improvements, or property line from which access is taken, except that a street setback shall not be measured to a driveway easement.

F. Driveway Setback

The minimum setback from a driveway easement shall be 5 feet, but shall not reduce the side or rear yard setback as measured to a lot line.

G. Side Setback

A side setback shall be measured to any side lot line.

H. Rear Setback

A rear setback shall be measured to any rear lot line.

I. Site Development Setback Exemption

Site development setbacks shall not apply from a lot line to a road or driveway when the lot line is within an easement and properties on both sides of the lot line benefit from the easement.

J. Encroachments into Setbacks

1. **Residential Zones (NL-1, NL-2 NL-3, NL-4, NL-5, NM-1, NM-2, NH-1)**
2. **Front Setback: Cornices, canopies, eaves, decks (covered and uncovered), porches, balconies, bay windows, chimneys and similar architectural features may encroach into a front yard by not more than 6 feet.**
 - a. **Side and Rear Setback: Cornices, canopies, eaves, decks (covered and uncovered), porches, balconies, bay windows, chimneys and similar architectural features may encroach into a side/rear yard by not more than 4 feet. Patios which are at grade may extend to any portion of a side or rear yard but not closer than 1 foot from a property line. The allowances in this subsection b. apply only to primary structures and do not apply to ARUs or accessory structures.**
3. **Commercial buildings**
 - a. **Architectural encroachments are not permitted in any setback in a commercial zones/buildings.**

Nonconforming or Nonconformity. See [Div. 1.9.](#)

Nursery. See [6.1.6.H.](#)

O (P17-077)

Office. See [6.1.6.B.](#)

Off-Premise Sign. A sign identifying or advertising a business, person, activity, goods, products or services, which is not located on the premises where the business or commercial activity is conducted.

Off-Site. Located neither on the land that is the subject of the application nor on a contiguous portion of a street or other right-of-way.

On-Site. Located on the land that is the subject of the application.

Open Space (Use). See [Sec. 6.1.2.](#)

Outdoor Recreation. See [6.1.3.C.](#)

Outfitter. See [6.1.7.E.](#)

P (P17-077)

Parcel. Parcel means unplatted property that is described by metes and bounds, or any public land surveys, or aliquot parts, or lot or tract designations not recognized as lawfully platted.

Parking (Use). See [6.1.10.B.](#)

Parking Lot. Parking lot means 4 or more adjacent parking spaces.

Pathway. Pathway means a facility designed for non-motorized travel intended for the use of bicyclists, pedestrians, equestrians, and cross-country skiers.

Pedestrian Access. See [Sec. 9.4.16.](#)

Pedestrian Facility. Pedestrian facility means a sidewalk or other walkway intended primarily for the use of pedestrians.

Performance Bond. Performance bond means a financial guarantee to ensure that all improvements, facilities, or work required by these LDRs will be completed in compliance with these LDRs, and the approved plans and specifications of a development.

Person. Person means an individual or group of individuals, corporation, partnership, association, municipality, or state agency.

Personal wireless service facilities. Personal wireless service facilities means facilities for the provision of personal wireless services. Personal wireless services means commercial wireless telecommunication services, unlicensed wire-less services, and common carrier wireless exchange access services.

Physical Development. Physical development means any of the following activities that alter the natural character of the land and for which a permit may be required pursuant to the LDRs: the construction, reconstruction, conversion, structural alteration, relocation, or enlargement of any structure, fence, wall, or other site development; any grading, clearing, excavation, dredging, filling or other movement of land; any mining, paving, or drilling operations; or the storage, deposition, or excavation of materials. Physical development does not include the use of land that does not involve any of the above listed activities.

Planned Residential Development. See [Sec. 7.1.2.](#)

Plat. Plat means the legally recorded drawing depicting the subdivision of land into 2 or more lots.

Primary Use. See [6.1.2.B.4.](#)

Principal Use. See [6.1.2.B.1.](#)

Profane Language on Signs. Any signs that can be viewed by the public that involves the use of profane or vulgar language, words, epithets, or expressions.

Protected Zone. The following zones are protected zones: Neighborhood Low Density -1 (NL-1), Neighborhood Low Density -2 (NL-2) Neighborhood Low Density -3 (NL-3), Neighborhood Low Density -4 (NL-4), Neighborhood Low Density -5 (NL-5), and Neighborhood Medium Density -1 (NM-1).

Public Sanitary Sewer. See “Wastewater Treatment System, Public.”

Public Water Supply. See “Water Supply, Public.”

R (1/1/15, Ord. 1074)

Ranch Compound. Ranch compound means a cluster of structures built in traditional ranch forms commonly found on ranches in Teton County.

Real Estate Sales Office. See [6.1.12.C.](#)

Rear Lot Line. See, “Lot Line, Rear.”

Rear Yard. See, “Yard, Rear.”

Recorded. Recorded means formally indexed and abstracted in the official records of the Teton County Clerk. Recorded does not include documents that are merely filed.

Recreational Park Trailers (RPT). An RPT or park model, is a trailer type that is primarily designed to provide temporary living quarters for recreational, camping, travel or seasonal use that meets the following criteria: (1) built on a single chassis; (2) mounted

SECTION II.

Section II of Town of Jackson Ordinance 1074 (part) and the Official Zoning District Map of the Town of Jackson are hereby amended to remove the Urban Residential (UR), Auto-Urban Commercial-Town (AC-ToJ), Auto-Urban Residential-Town (AR-ToJ), Business Park Restricted Uses (BP-R), Business Conservation-Town (BC-ToJ), Residential Business (RB), Neighborhood Conservation-Town (NC-ToJ), Neighborhood Conservation-2-Family (NC-2), and Suburban-Town (S-ToJ) legacy zones, and add the NL-1: Neighborhood Low Density 1, NL-2: Neighborhood Low Density 2, NL-3: Neighborhood Low Density 3, NL-4: Neighborhood Low Density 4, NL-5: Neighborhood Low Density 5, NM-1: Neighborhood Medium Density 1, NM-2: Neighborhood Medium Density 2, NH-1: Neighborhood High Density 1, and CR-3: Commercial Residential 3 character zones, to wit:

Proposed Zoning June 21, 2018

- | | | | | | | | | | | | | | | | | | |
|------|----|------|------|------|------|------|------|------|------|-----|---|------|----------|----------|----------|----------|----------|
| CR-3 | OR | NH-1 | NM-2 | NM-1 | NL-5 | NL-4 | NL-3 | NL-2 | NL-1 | MHP | R | P/SP | PUD-NH-1 | PUD-NM-2 | PUD-NL-5 | PUD-NL-3 | PUD-NL-2 |
| | | | | | | | | | | | | | | | | | |

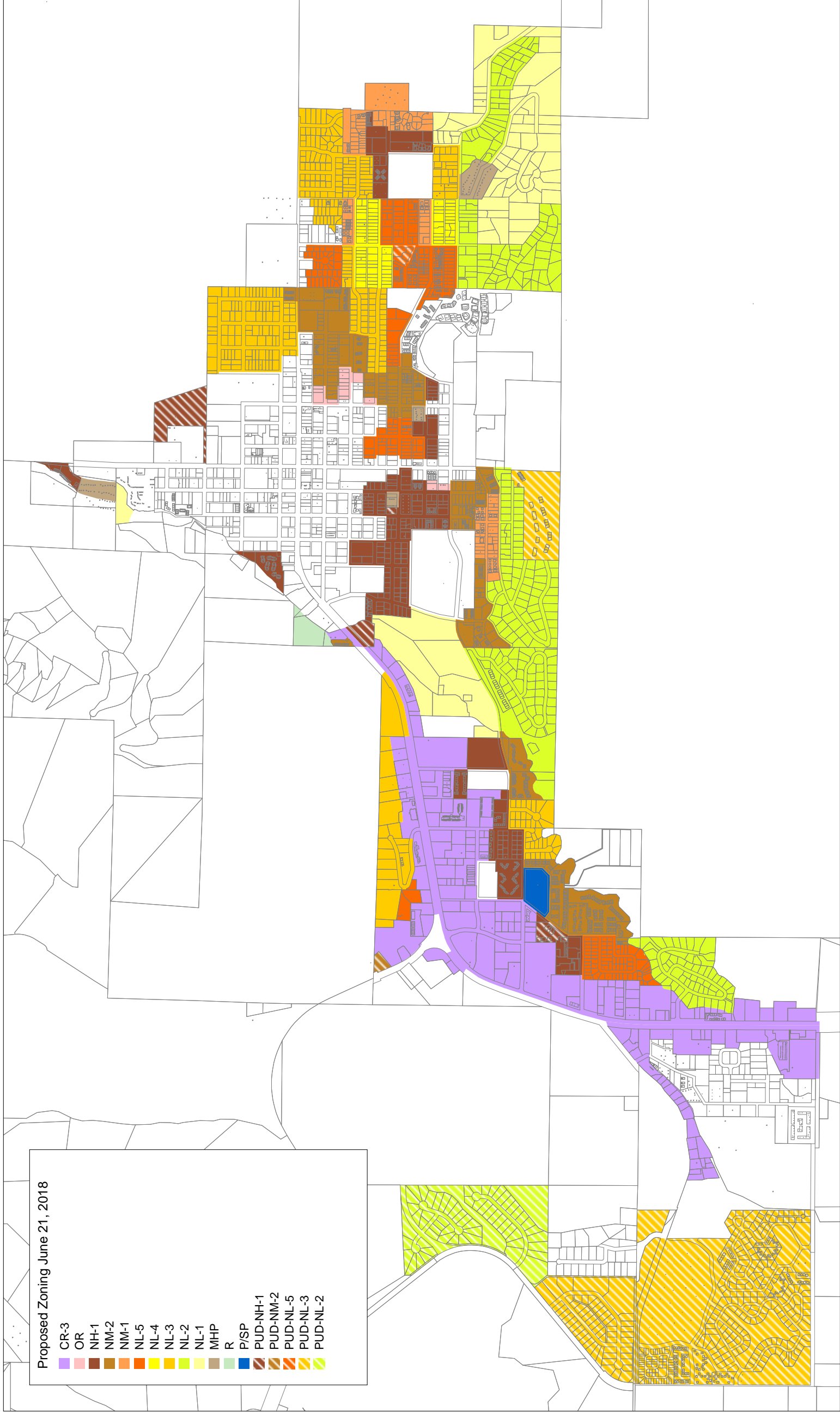

SECTION III.

All ordinances and parts of ordinances in conflict with the provisions of this ordinance are hereby repealed.

SECTION IV.

If any section, subsection, sentence, clause, phrase or portion of this ordinance is for any reason held invalid or unconstitutional by any court of competent jurisdiction, such portion shall be deemed as a separate, distinct and independent provision and such holding shall not affect the validity of the remaining portions of the ordinance.

SECTION V.

This Ordinance shall become effective after its passage, approval and publication.

PASSED 1ST READING THE 25TH DAY OF JUNE, 2018.
PASSED 2ND READING THE 2ND DAY OF JULY, 2018.
PASSED AND APPROVED THE 16TH DAY OF JULY, 2018.

TOWN OF JACKSON

BY: _____
Pete Muldoon, Mayor

ATTEST:

BY: _____
Sandra P. Birdyshaw, Town Clerk

ATTESTATION OF TOWN CLERK

STATE OF WYOMING)
) ss.
COUNTY OF TETON)

I hereby certify that the foregoing Ordinance No. 1197 was duly published in the Jackson Hole News and Guide, a newspaper of general circulation published in the Town of Jackson, Wyoming, on the 18th day of July, 2018. I further certify that the foregoing Ordinance was duly recorded on page _____ of Book _____ of Ordinances of the Town of Jackson, Wyoming.

Sandra P. Birdyshaw, Town Clerk